

Flavor Burst®

ADPT TY80S-FCB Adapter Kit for FB 80Sa & FCB Freezers

Installation

This kit converts the Flavor Burst® FB 80Sa frozen beverage system to a Flavor Burst® FB 80FCB frozen carbonated beverage system. It is designed for use with Taylor® FCB freezer models 345, 346, 349, 355, 356, C300, and C302. The kit includes a modified Taylor FCB Door Spout which allows the Flavor Burst system to be attached to the freezer. The magnetic pin activates the Flavor Burst® system when the pull handle is in open position to draw a serving. For more information, please contact your local Flavor Burst® distributor.

FCB 112 Modified Taylor FCB Door Spout

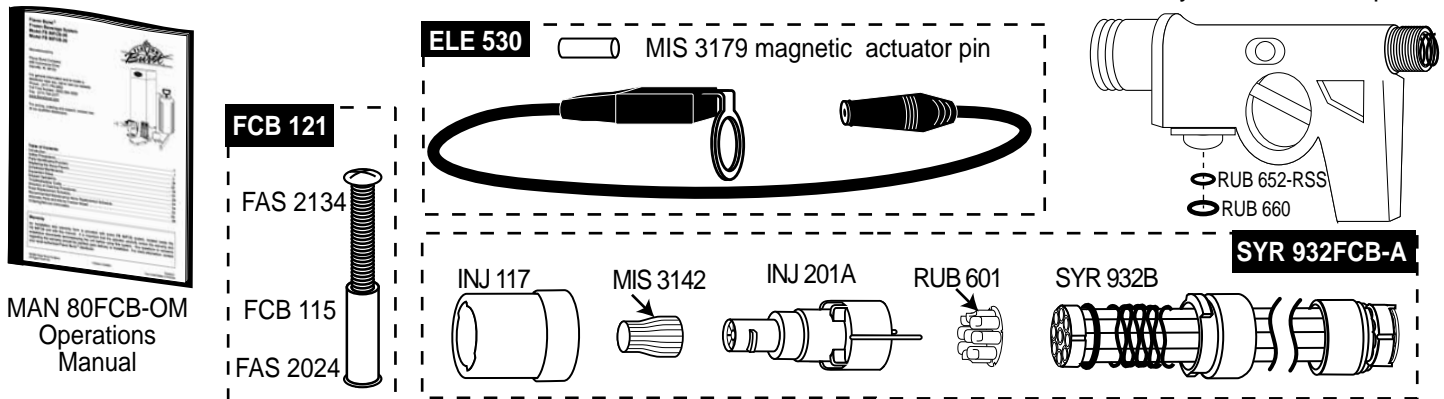

1 Replace the regular freezer door spout with the modified freezer door spout from the kit. Ensure the two o-rings are in their respective grooves inside the syrup port. Install the draw handle, pin assembly and the end cap from the other spout on the new assembly.

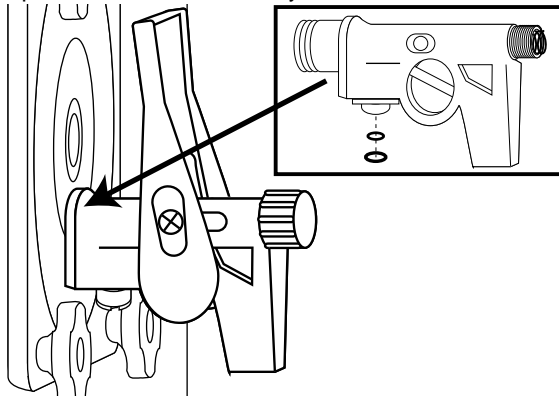

2 Remove the cap and insert the FCB 9-Tube Assembly into the syrup port under the freezer head.

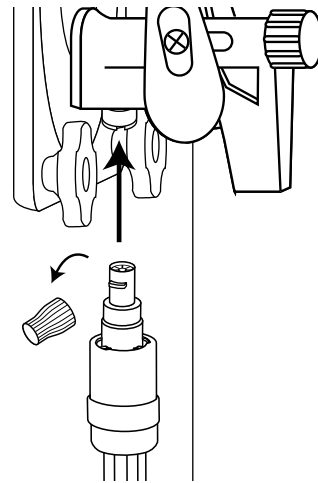

3 Drill a 1/4" hole through the pull handle. The center of the hole should be 1/4" above the handle arch and centered.

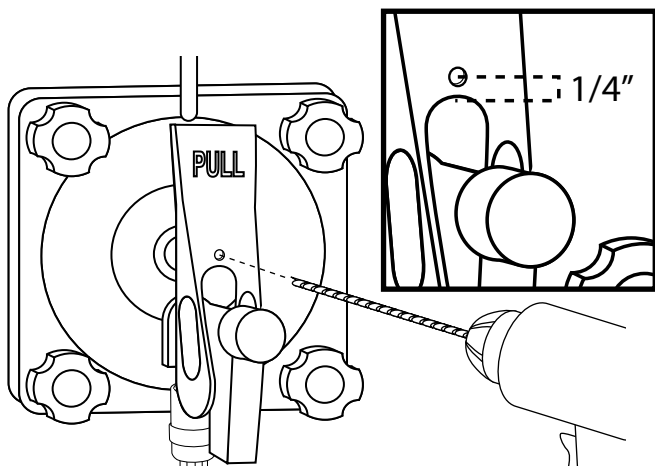

4 Insert the magnetic actuator pin into the hole so that the back of the pin is flush with the back of the pull handle. The pin should protrude from the hole at the front. Ensure the pin is secure and if necessary, use a drop of super glue to secure the pin in the hole.

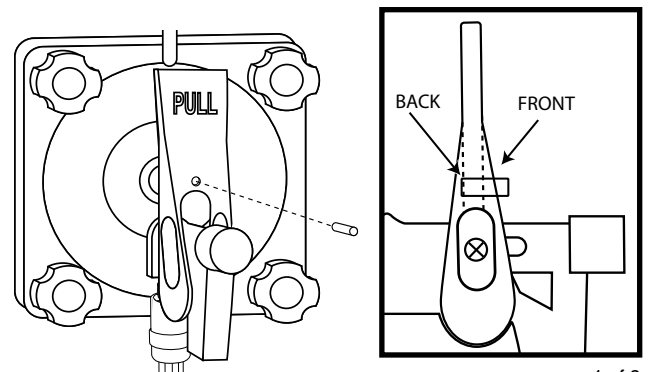

- 5** Remove the spout cap and install the switch over the threads.

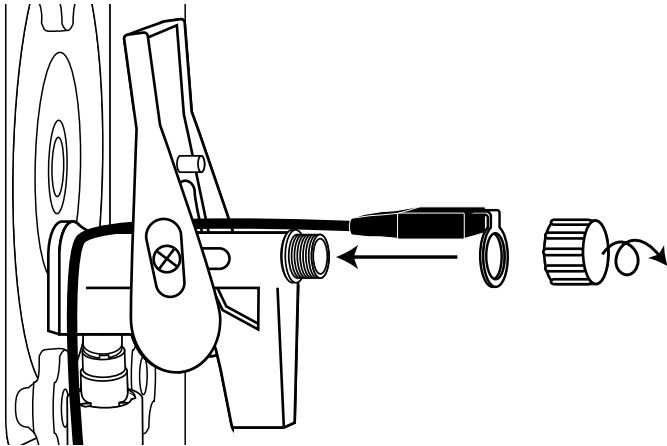

- 6** Insert the Flow Rate Controller inside the spring. Ensure the encased end of the assembly is toward the back of the spout. Return the cap to the door spout.

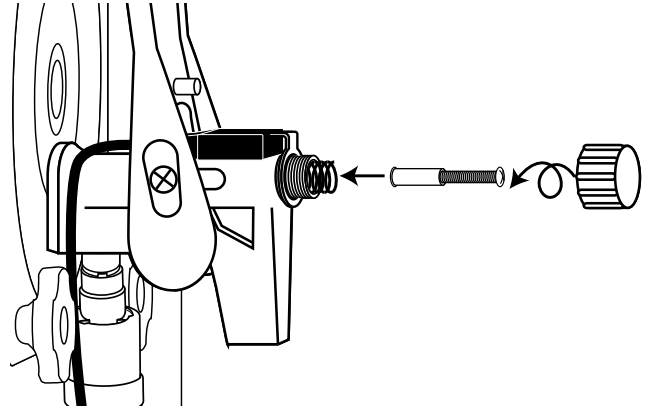

- 7** Connect the keypad to the switch.

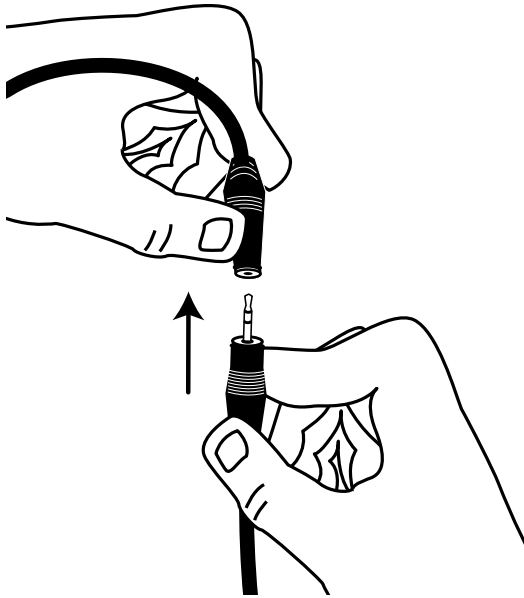

- 8** Draw a serving to determine if the flow rate is satisfactory. The magnetic pin activates the switch when the handle is pulled forward and the pin is brought close to the switch.

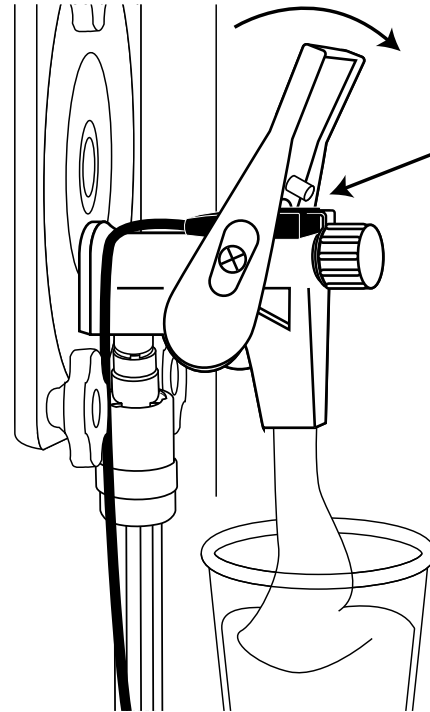

- 9** Adjust the Flow Rate Controller as needed to complete installation. Adjust the screw further into the casing (shorten the assembly) to increase the flow rate. Adjust the screw out from the casing (lengthen the assembly) to decrease the flow rate.

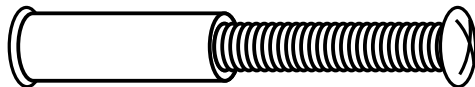

1.95" Pre-set Standard

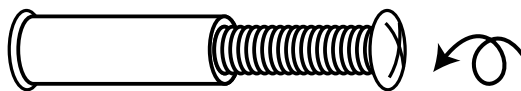

Shorten to Increase Flow



Lengthen to Decrease Flow