

Flavor Burst™

UPG CC8V2 Upgrade Kit

Installation and Assembly

The UPG CC8V2 Upgrade Kit is for use with the Flavor Burst® CC8 system. Use the following instructions to replace parts that have been modified to further improve the CC8 system. For more information, please contact your local Taylor® distributor.

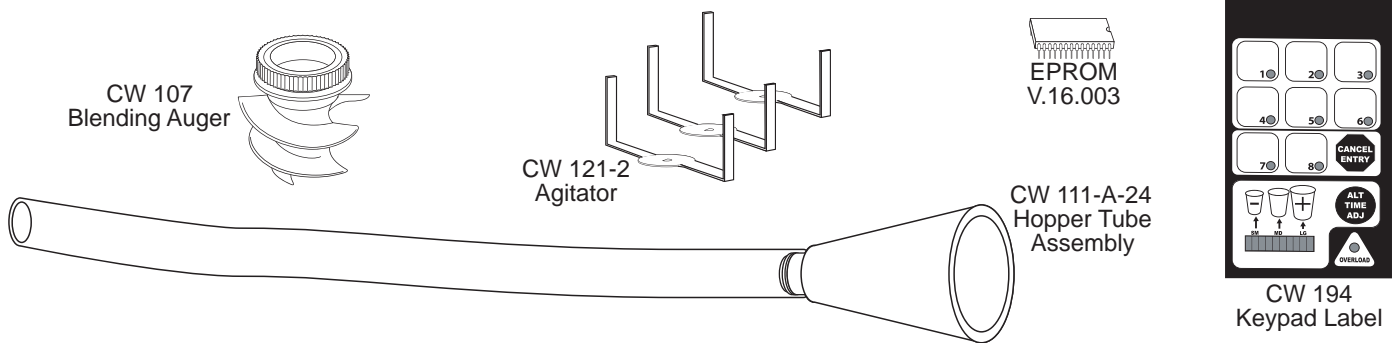

1 Remove the existing Auger from the Blending Assembly.

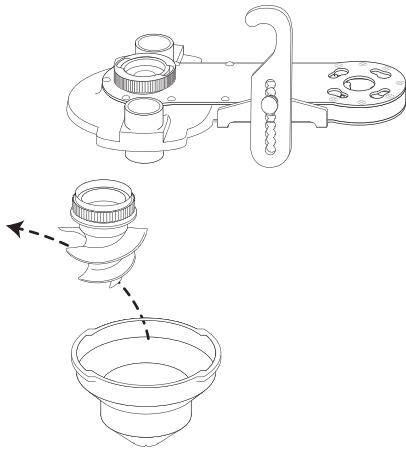

2 Install the modified Blending Auger over the Auger axis and work it in place so that the teeth of the Auger catch the gear of the Blending Assembly. Install the Hopper onto the Blending Assembly.

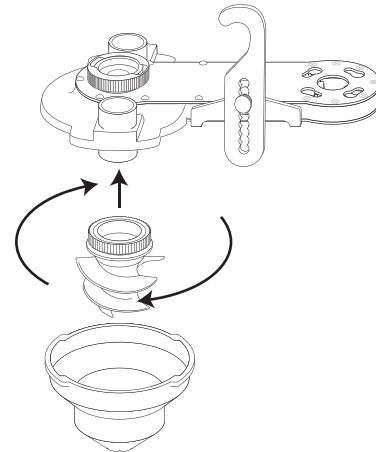

3 Remove the adhesive strip covering from the CW 194 keypad label and place the label over the face of the keypad. Carefully align the label so that the keypad's LED lights are visible through the transparent areas.

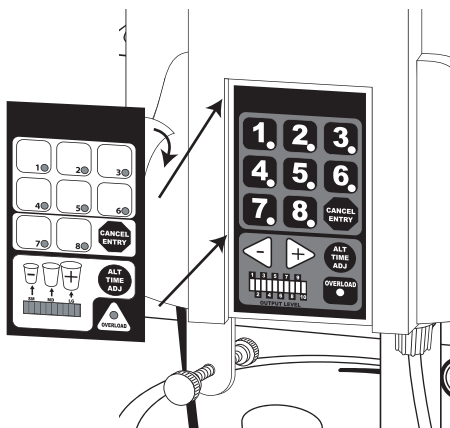

4 Remove the Hopper Tube Assembly and the Elbow Tubes from the system. Install the CW 111-A-24 Hopper Tube Assembly by placing the funnel end of the Assembly into the hopper opening of the Mounting Base. Insert the tube end fully into the Blending Head opening.

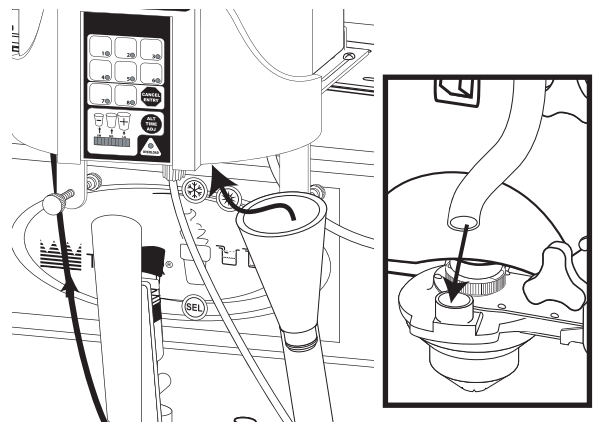

- 5** If any of the module agitators have trouble churning the product so that it flows consistently from the containers, replace them with the CW 121-2 agitators provided.

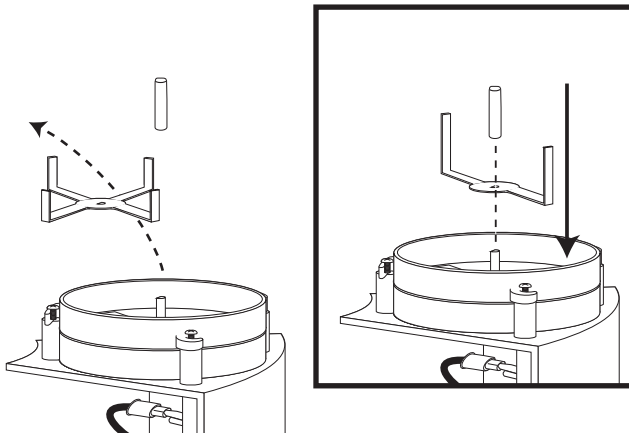

- 6** Disconnect the Electronics Box from the power source and the CC8 unit. Remove the Electronics Box from the freezer mounting brackets and set it on a flat surface.

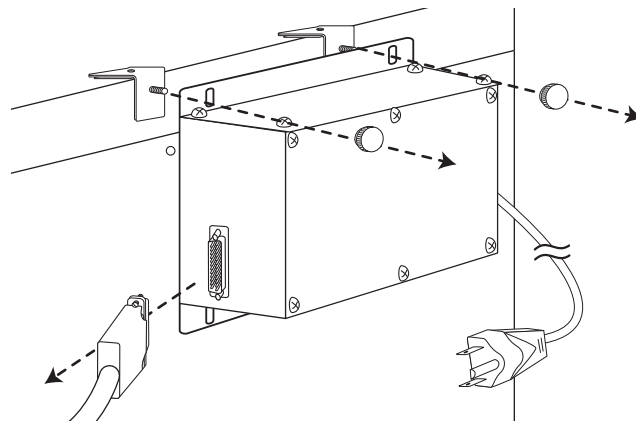

- 7** Loosen each screw of the Electronics Box cover a little bit at a time until the cover can be lifted and placed to the side.

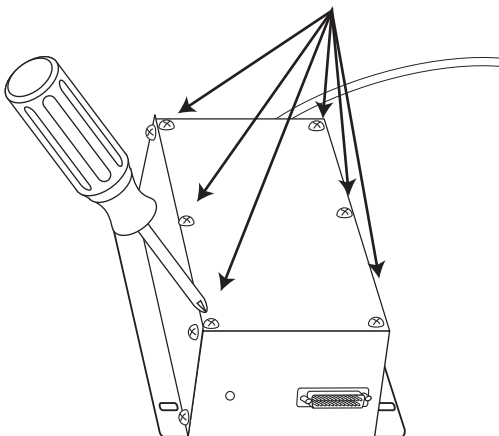

- 8** Remove the existing EPROM from the Electronics Box. **Return the EPROM for credit.**

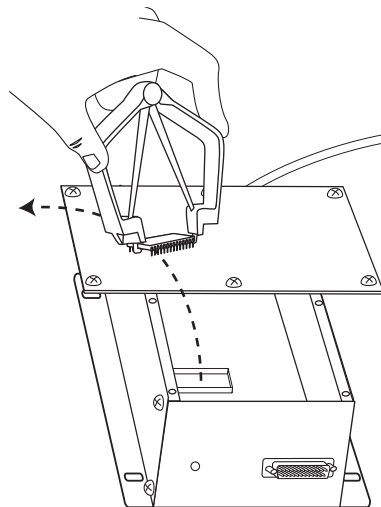

- 9** Install the EPROM V.16.003. Ensure the edge with the notch facing the center of the Electronics Box.

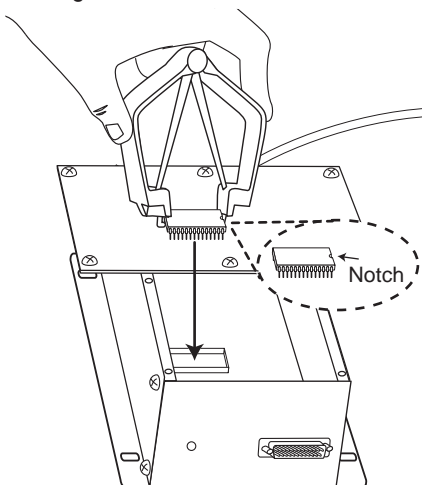

- 10** Install the cover, tightening each screw a little bit at a time until it is secure. Install the Electronics Box onto the freezer mounting brackets. Connect the CC8 unit to the Box and the power cord to a power source.

