

# Flavor Burst®

## SYR 944SH FB 80Sa Syrup Tube & Bag Connector Assembly Installation

The Syrup Tube & Bag Connector Assembly is for use with the Flavor Burst® frozen beverage systems. A tubing piece was replaced in the assembly for better preservation of the syrup within in the line. Failure to replace these assemblies could result in clogged tubes over time. Refer to your Operations Manual for instructions on performing the Clean-In-Place, Pump Flush and priming procedures. Contact your local distributor for more information.

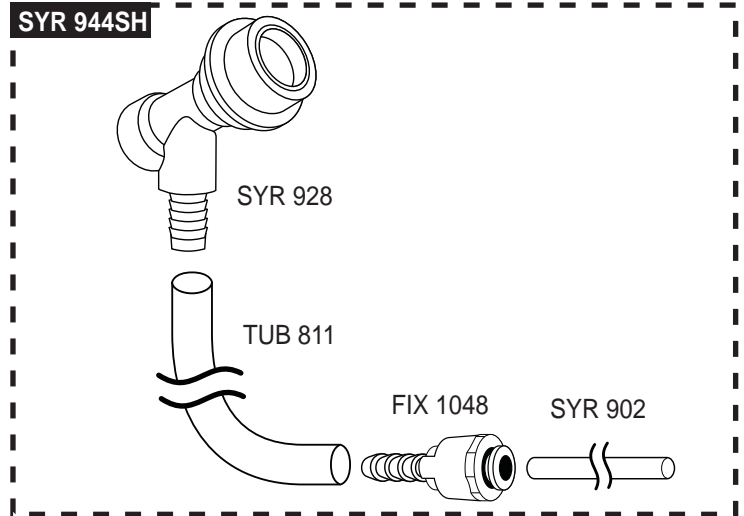

- 1 Perform Phase 2: Syrup System Cleaning of the CLEAN-IN-PLACE (CIP) PROCEDURE for the syrup tube that is being replaced. Refer to the Flavor Burst® Operations Manual for instructions.



**NOTE:** DO NOT RECONNECT THE SYRUP BAG CONNECTORS TO THE BAG FITMENTS.

- 2 Remove the back panel of the cabinet. Disconnect the syrup tube from the elbow fitting of the syrup pump.

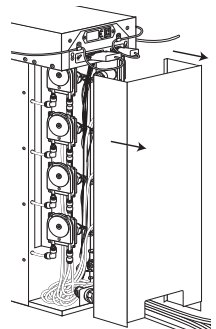
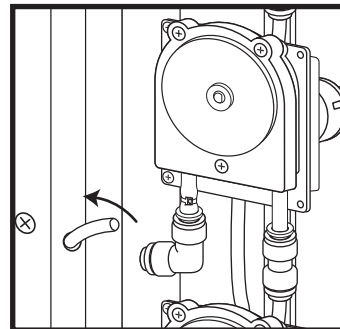

- 3 Remove the old Syrup Tube Assembly from the cabinet.

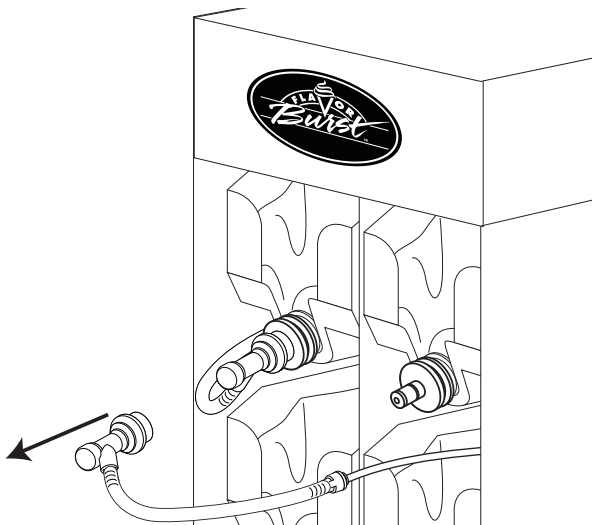

- 4 Slide the new SYR 944SH Syrup Tube Assembly through the support railing to the back of the cabinet.

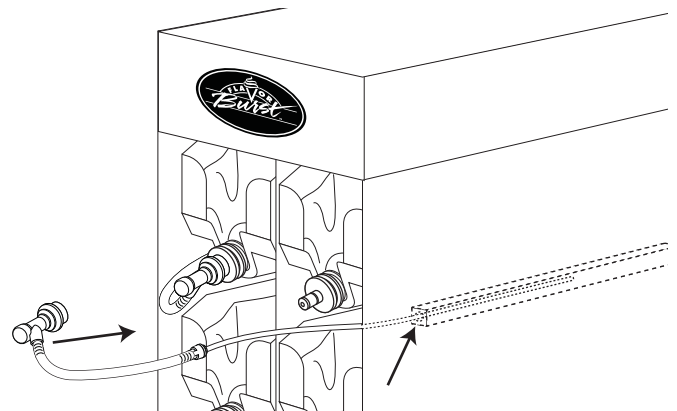

- 5** Insert the syrup tube fully into the elbow fitment of the syrup pump. Reinstall the back panel and the screw.

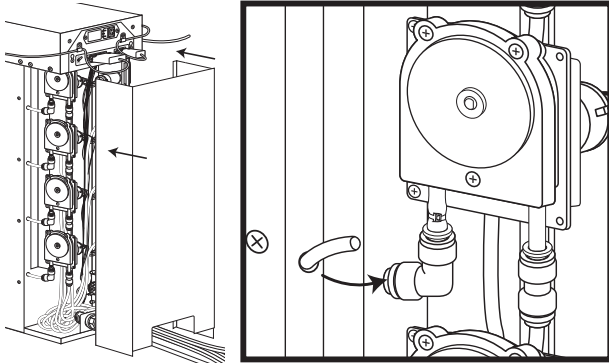

- 6** Spray the Syrup Bag Connector with sanitizer solution and allow it to sanitize for at least one minute.

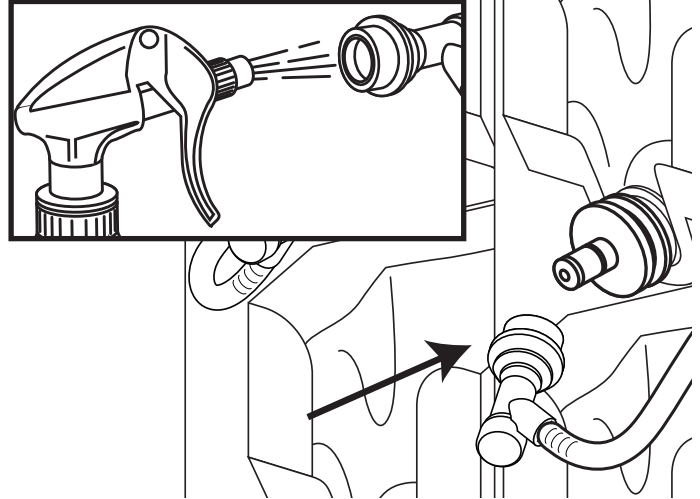

- 7** Connect the Syrup Bag Connector to the syrup bag fitment by sliding the Connector Head back, installing the Connector fully onto the fitment, and then releasing the head to secure the connection.

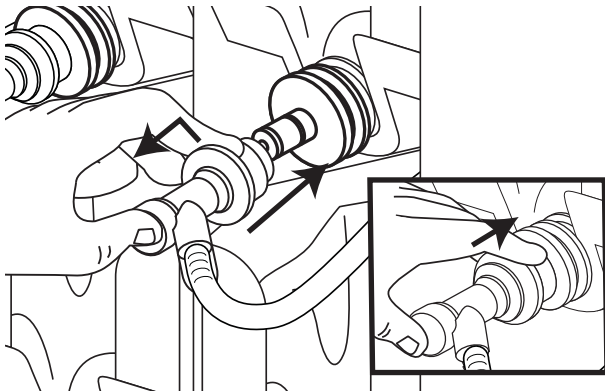

- 8** Place a container under the Blending Head, press the numbered key corresponding to the syrup line (1-8) and then press the WATER/SYRUP FLUSH key until the syrup line is fully primed. Press CANCEL ENTRY to stop the flush process once the syrup is flowing consistently.

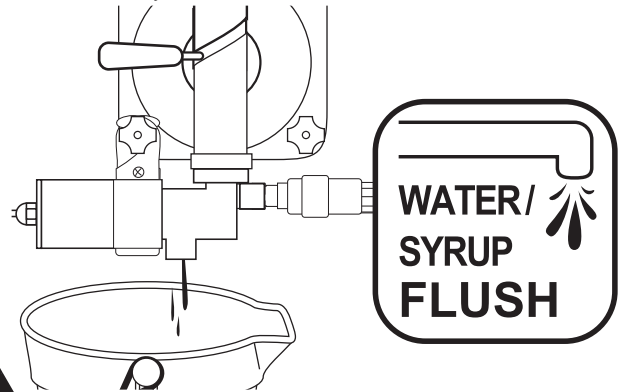

**!** **NOTE:** FOR OLDER SYSTEMS, PRESS THE NUMBERED KEY CORRESPONDING TO THE SYRUP LINE AND THEN PRESS THE "PUMP FLUSH" KEY.

- 9** Once the line is primed, press WATER/SYRUP FLUSH to clean and sanitize the Blending Head.

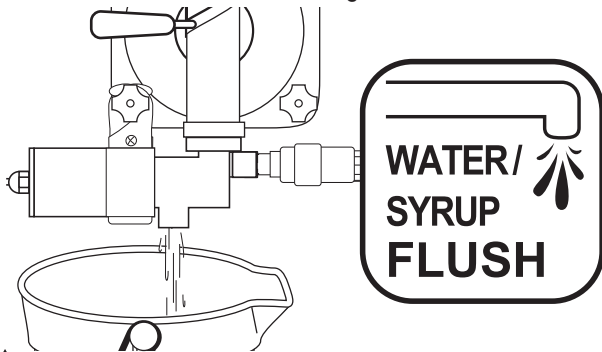

**!** **NOTE:** FOR OLDER SYSTEMS, PRESS THE "ROTOR FLUSH" KEY.