

Flavor Burst®

SYR 941A Syrup Bag Adapter Installation and Cleaning instructions

Syrup bags manufactured in 2016 and later have a new “direct connect” nozzle fitment. These bags are able to connect directly to the syrup lines of the Flavor Burst system. Due to the long shelf life of some syrups, older style fitments may still be in circulation. These older fitments are shorter and wider and require the SYR 941A syrup bag adapter in order to connect to the syrup lines. If you are using these adapters, follow the instructions on this sheet to install them properly and to clean / sanitize them properly in order to comply with sanitation guidelines.

INSTALLATION

To prevent the Syrup Bag Adapter from turning off the bag valve fitment, the black collar must be fully locked in place. When possible, lay the syrup bag on a flat surface when installing the SYR 941A Syrup Bag Adapter. Secure the black collar of the adapter **tightly** onto the bag fitment according to the following instructions. If the adapter is not properly installed, the bad connection could result in a leak.

- 1 Install the adapter onto the bag fitment and tighten the black collar. The notch of the black collar must settle into one of the grooves on the fitment in order to secure the connection.

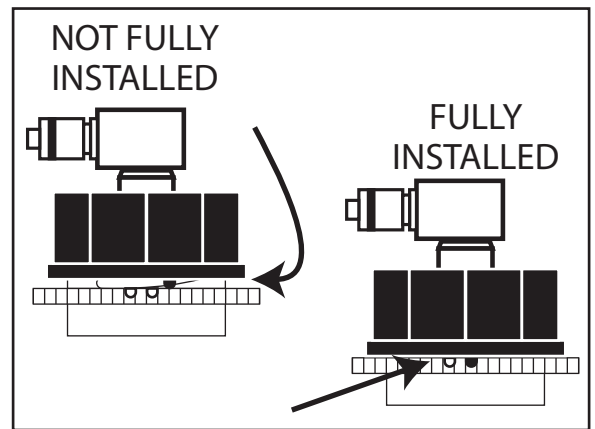
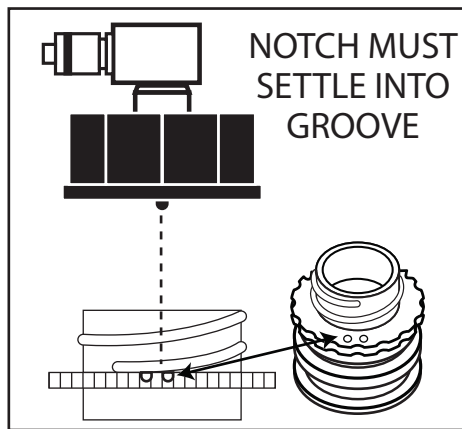
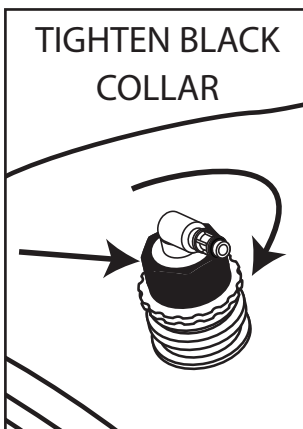

- 2 Swivel the Adapter nozzle around and ensure the black collar does not loosen.

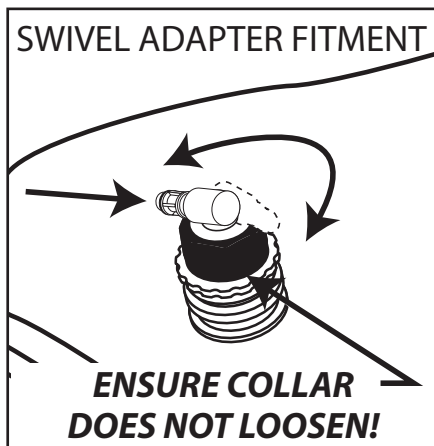

- 3 When syrup bags are connected to the syrup line, ensure the adapters are **behind** the tray openings, and the nozzles angle downward and toward the center panel of the cabinet as shown. This position ensures proper syrup flow and tube clearance when the cabinet is closed.

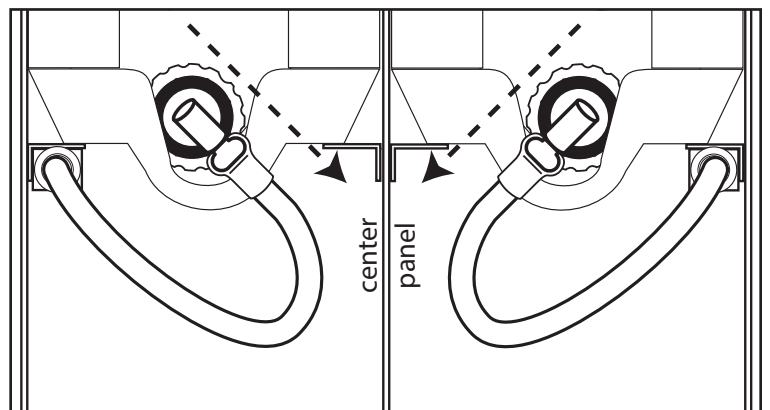

...see page 2 for important cleaning information →

CLEANING / SANITIZING

When using the SYR 941A Syrup Bag Adapter with a syrup bag, it must be cleaned and sanitized whenever a syrup bag is changed, during the monthly Clean-In-Place process, and when winterizing the unit. Follow these instructions to clean and sanitize the syrup bag adapter to comply with sanitation guidelines.



NOTE: USE STERA-SHEEN® GREEN LABEL SANITIZER AND DAWN® DISH SOAP MIXED WITH WARM WATER (108°F / 42°C) FOR THE FOLLOWING PROCEDURES. REFER TO MANUFACTURER'S INSTRUCTIONS FOR PROPER PREPARATIONS OF THESE CLEANING AGENTS.

- 1 Prepare detergent water by mixing several drops of Dawn® dish soap with a gallon of warm water (108°F / 42°C).

Prepare sanitizer solution by mixing half a packet (1 oz) of Stera-Sheen® Green Label with one gallon of warm water (108°F / 42°C).

- 2 Disconnect the syrup line and remove the SYR 941A syrup bag adapter from the syrup bag fitment. Submerge the syrup bag adapter in detergent water for 5 minutes.

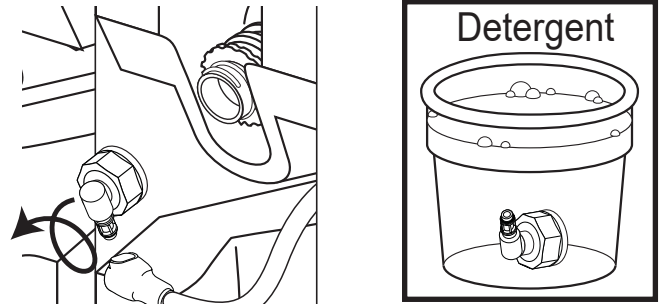

- 3 Brush and clean the adapter with the warm detergent water and then rinse thoroughly with warm water (108°F / 42°C). Submerge the adapter in Stera-Sheen Green Label sanitizer solution for 5 minutes.

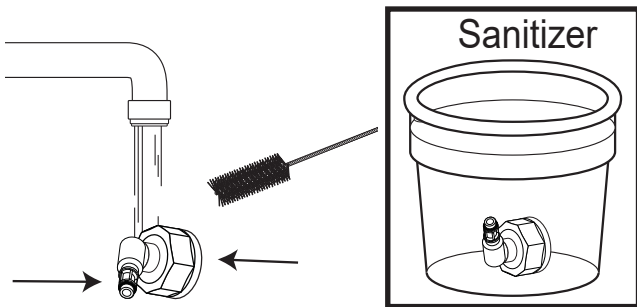

- 4 To clean the internal areas of the adapter, connect it to the Pump Flush Adapter (located under the bottom tray in the Flavor Burst cabinet). Place the Pump Flush Adapter over a container that is level with or below the sanitizer tank. Allow sanitizer solution to slowly flow through the adapter for 5 minutes.

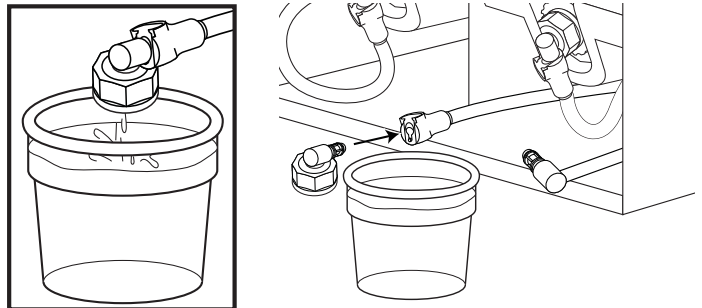

- 5 Disconnect the syrup bag adapter and place it on a sanitary tray to dry.

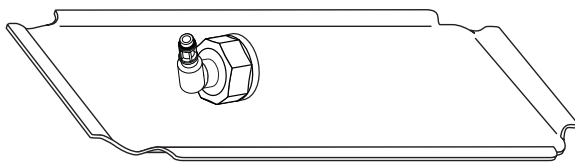

- 6 Install the adapter back onto the syrup bag, or store the adapter when winterizing the unit. Ensure the adapter notch is fully seated into the bag fitment groove.

