

Flavor Burst™

POP 428 Wrap & Transparency Kit

Setup and Installation

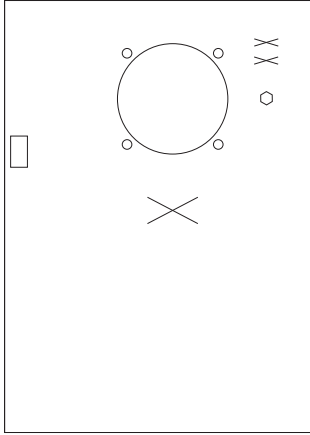

428 Wraps & Transparency Kits

- POP 6099 Shake Break Kit
- POP 7037 Nice Ice Kit
- POP 9018 JavaLatte Kit
- POP 8009 Frozen Cocktail Kit



NOTE: BE SURE THE ENTIRE SURFACE OF THE PANEL FACE IS CLEAN BEFORE INSTALLING THE WRAP.

- 1** Remove the freezer head, tray and drip tray from the freezer.

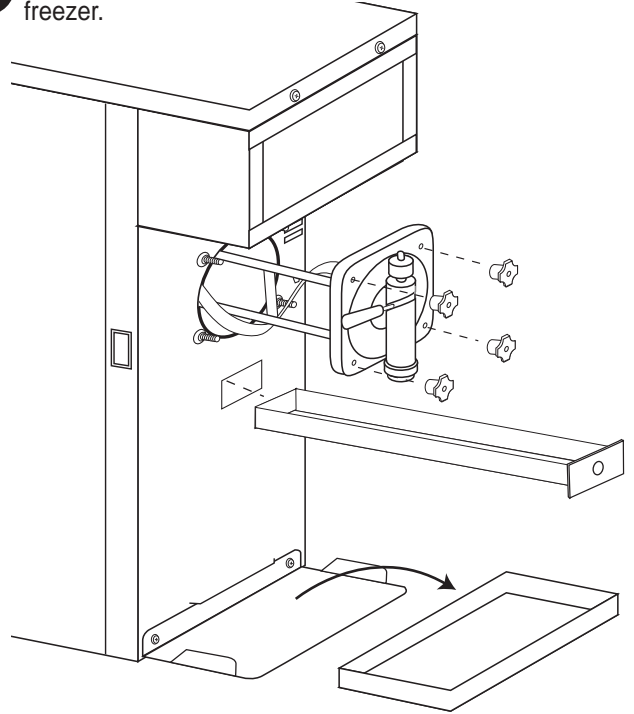

- 2** Remove each side panel by removing the three screws at the bottom of each panel. Then, unscrew and remove the tray bracket. Remove the freezer face screws located at the top and bottom of each side, near the side panel opening.

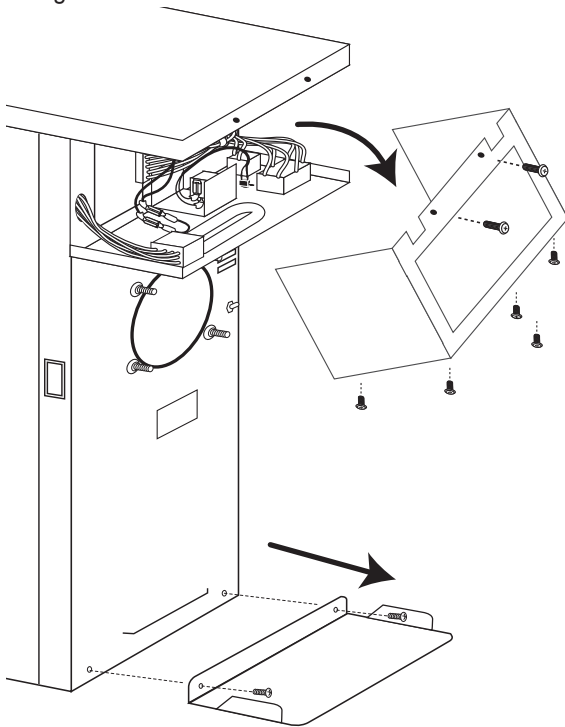

- 3** Using needle-nose pliers, remove the four screw pins from the freezer.

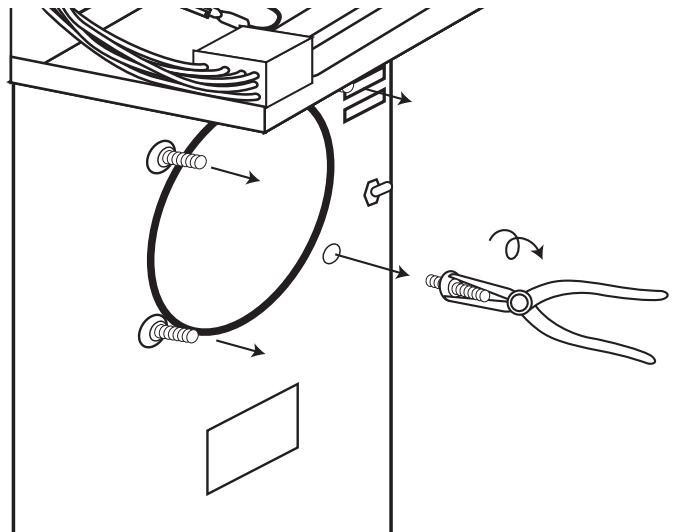

- 4** Remove the freezer face by carefully sliding it down and away. The face will still be attached to the freezer by wires. Set the face panel upright just in front of the freezer.

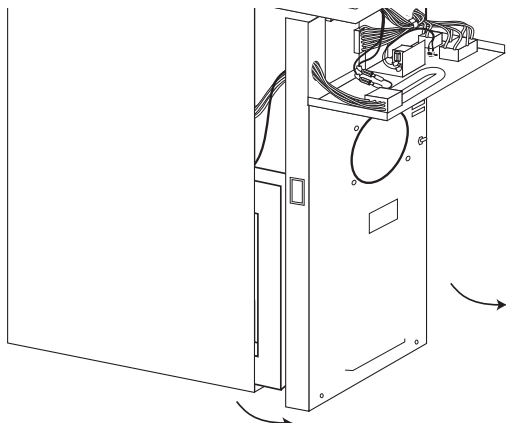

! The face will still be attached to the freezer by wires.

- 5** Loosen and disconnect the two lights "ADD MIX" and "MIX OUT", unscrew and remove the flip switch, and then remove the unused switch cover.

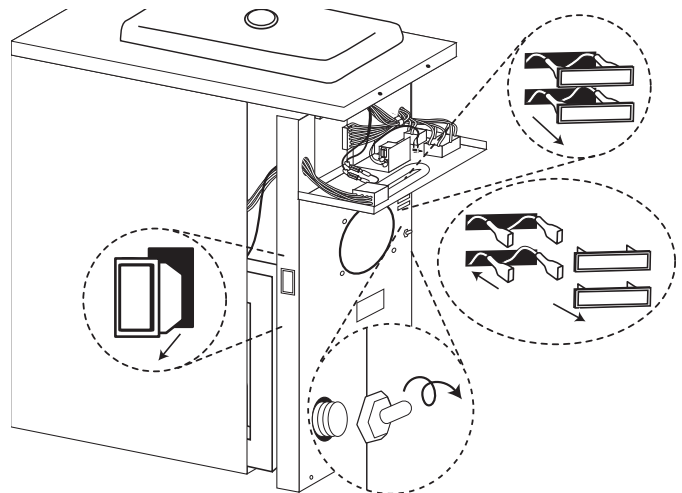

- 6** Remove the wrap backing and line up the large and small circular holes with the corresponding ones on the freezer. Roll back the black seal on the panel for the wrap to line up properly with the larger hole. Secure only this area by pressing firmly.

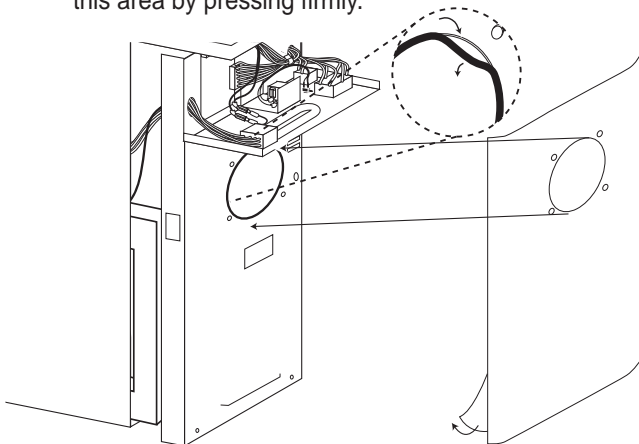

- 7** Press the rest of the wrap to the freezer in an outward motion from the center circle to the edges, pushing out any air pockets. The entire panel face should be secured before wrapping the side panels.

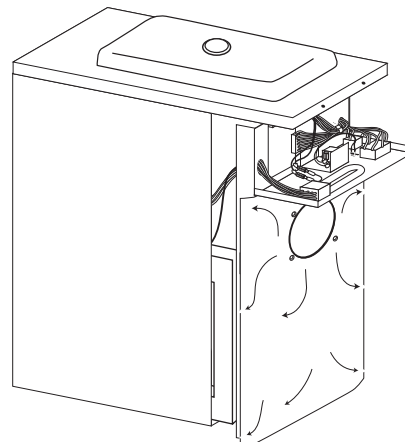

- 8** Cut "X"-shaped incisions through the openings for the lights, flip switch, switch cover, and drip tray, and then fold the flaps to the inside of the panel.

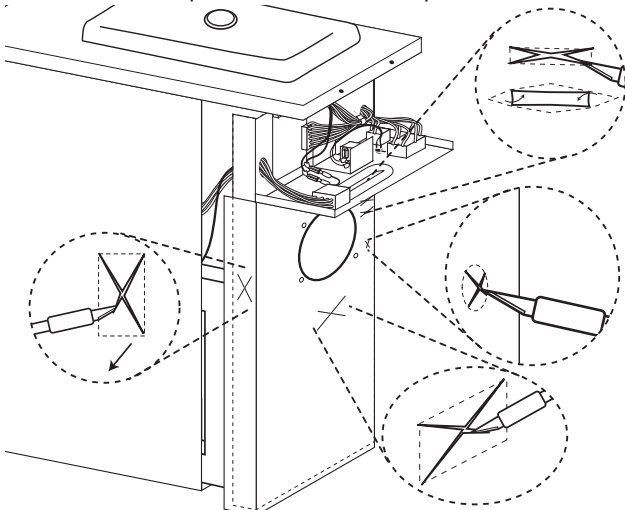

- 9** Reinstall the lights, flip switch and switch cover.

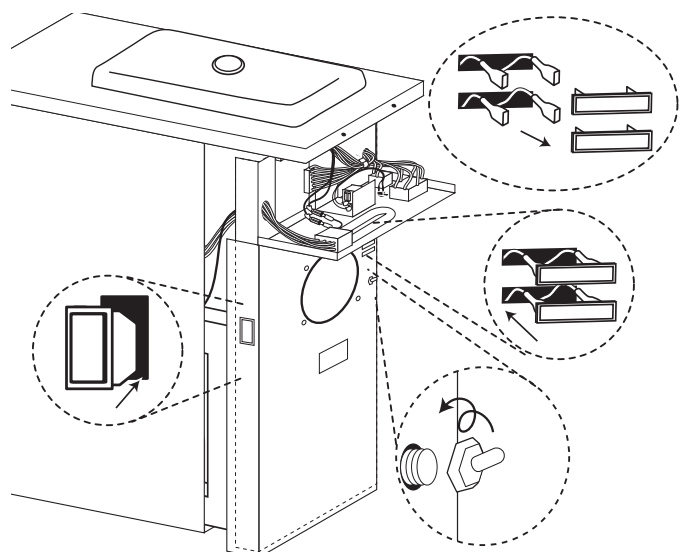

- 10** Cut a slit in the wrap where the tray lip protrudes and press the wrap firmly into place. Then cut slits for the screws at the bottom and sides of the panel and for the tray bracket screws.

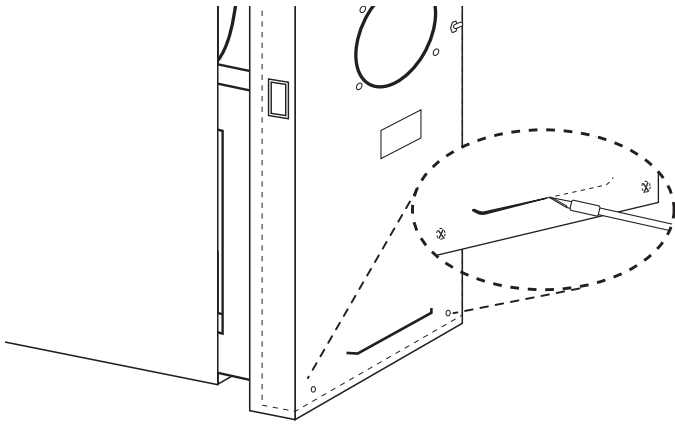

- 11** Make incisions where the wrap hangs over the panel corners and fold the wrap edges over onto the back.

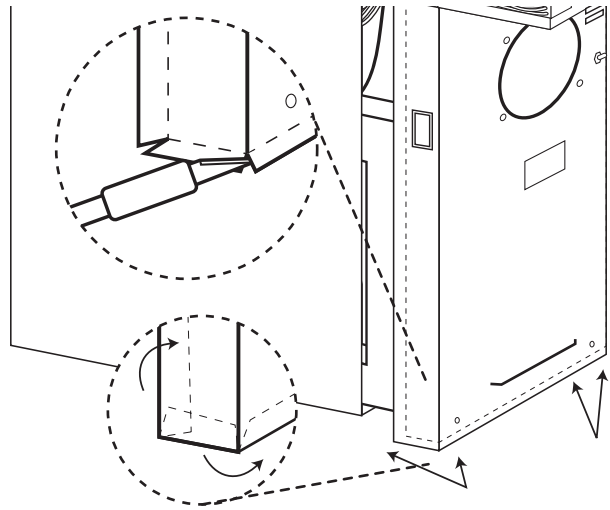

- 12** Two methods may be used to install the display panel trans, **A** Slide the trans through the magnetic holder and then attach it to the display frame, or ...

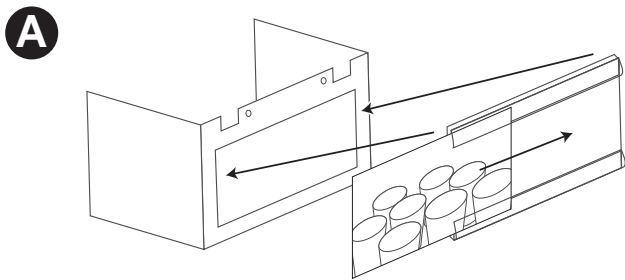

- B** Gently pull the bottom of the display backing up and slip the trans up between the backing and the display frame

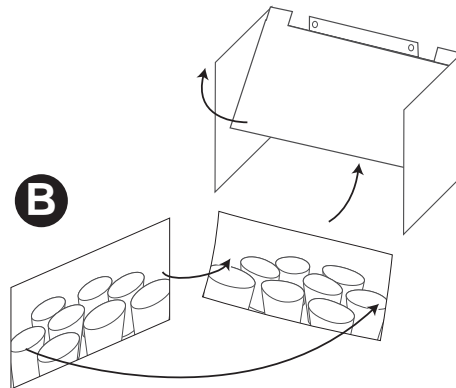

- 13** Reassemble the freezer in the reverse order it was disassembled (reverse steps 1-4) to complete the assembly.

