

Flavor Burst®

Overlay 550

Assembly and Installation

Follow these instructions to remove the old Keypad label and install the Overlay 550 Keypad label assembly. For more information, contact your local distributor.

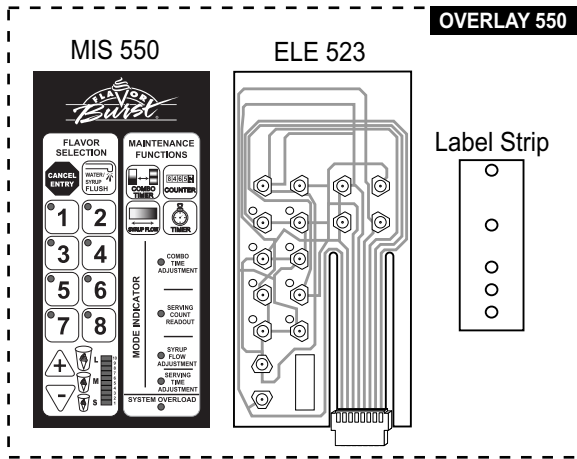

- 1 Turn the power off and disconnect the power cable from the board located at the upper back of the cabinet.

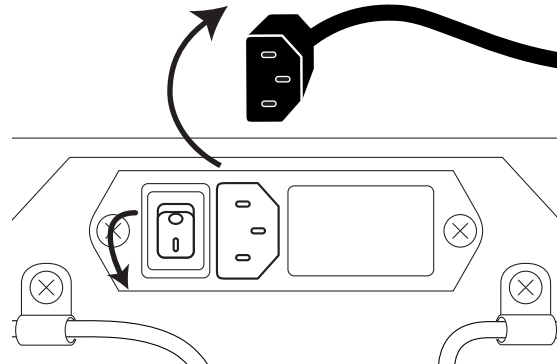

- 2 Remove the Keypad from the freezer bracket and disconnect it from the spigot switch.

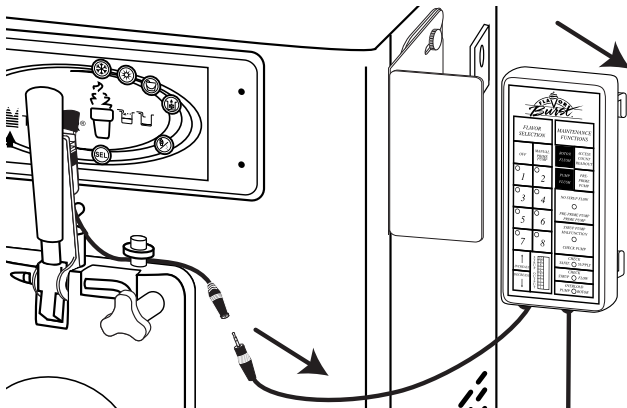

- 3 Loosen the outer screws and remove the back cover of the keypad.

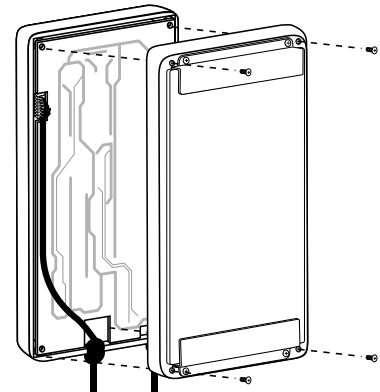

NOTE: IF THE KEYPAD BRACKETS ARE COVERING THE SCREW HOLES, REMOVE THE BRACKETS FIRST AND THEN REMOVE THE KEYPAD SCREWS.

- 4 Carefully disconnect the electronics board from the electrical ribbon and set it aside.

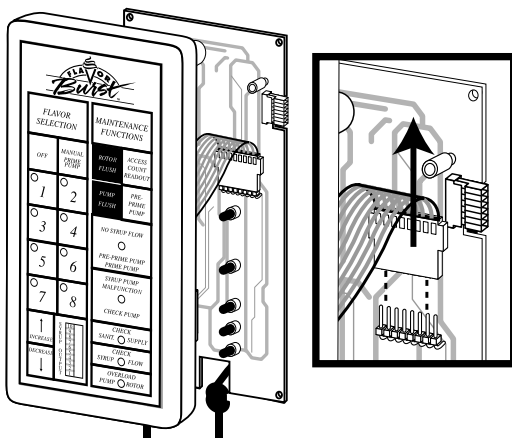

- 5 Use a flat head screwdriver to peel off a corner of the keypad label, then carefully remove the whole label and the switch membrane with ribbon behind it.

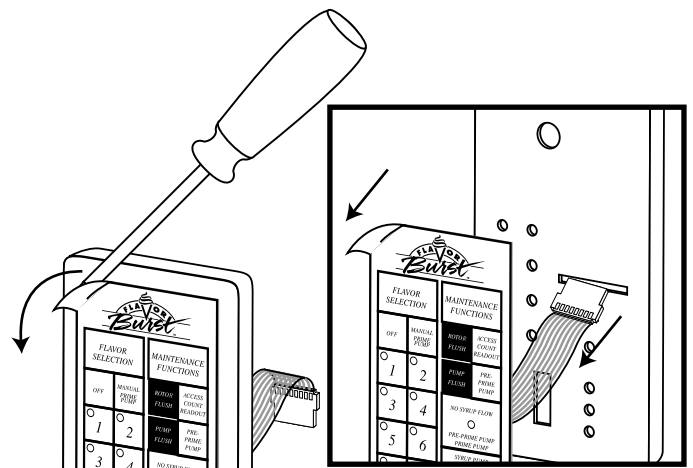

- 6** Remove the protective tape from the back of the ELE 523 switch membrane. Insert the ribbon into the slot on the keypad and affix the switch membrane to the keypad face. First ensure the rectangular opening on the switch membrane lines up with the opening on the keypad and then line up the 8 circles with the keypad's circular openings.

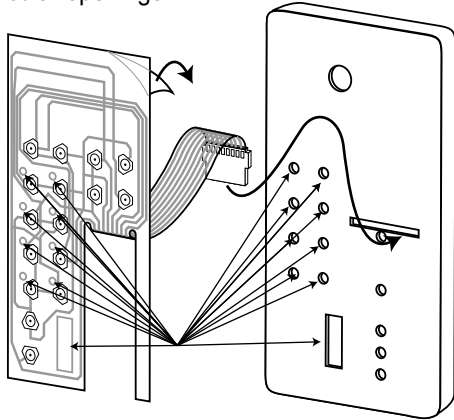

- 7** Remove the protective tape from the back of the small label strip and affix it to the exposed section of the keypad face under the ribbon slot. Ensure the circles on the label strip line up with the keypad panel's circular openings.

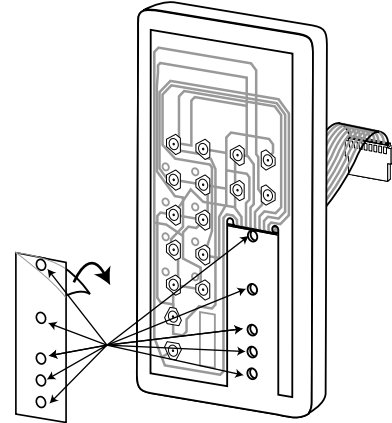

- 8** Remove the protective tape from the back of the new overlay keypad label and affix it to the face of the keypad on top of the switch membrane. Ensure the transparent windows of the label line up with the keypad panel's openings.

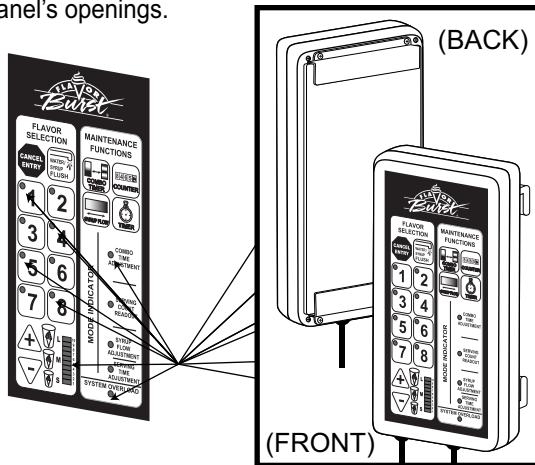

- 9** Carefully connect the electrical ribbon to the plug on the electronics board.

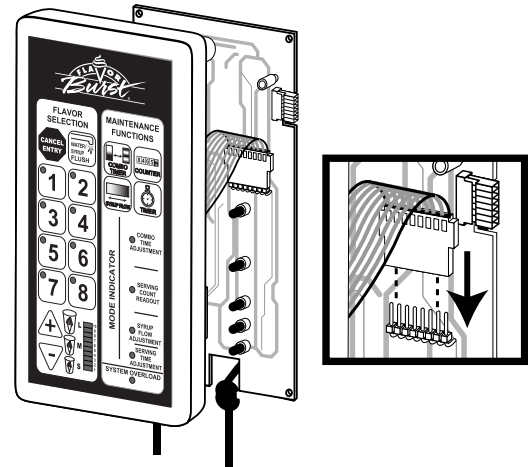

- 10** Line up the screw holes of the front cover, the electronics board and the back cover and secure them together with the screws. If the keypad brackets were removed, install them to the back of the keypad.

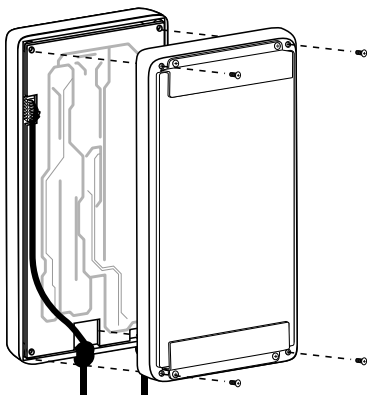

- 11** Return the keypad to the freezer bracket and connect it to the spigot switch.

