

Flavor Burst[®]

MIS 3520C-R or MIS 3520C-L

Cup Holder Support Arm Installation

The Cup Holder Support Arm bracket allows the cup holder assembly to hang from the weight sensor. In order to protect the weight sensor, this support arm is shipped detached. Follow these instructions to attach the support arm to the weight sensor.

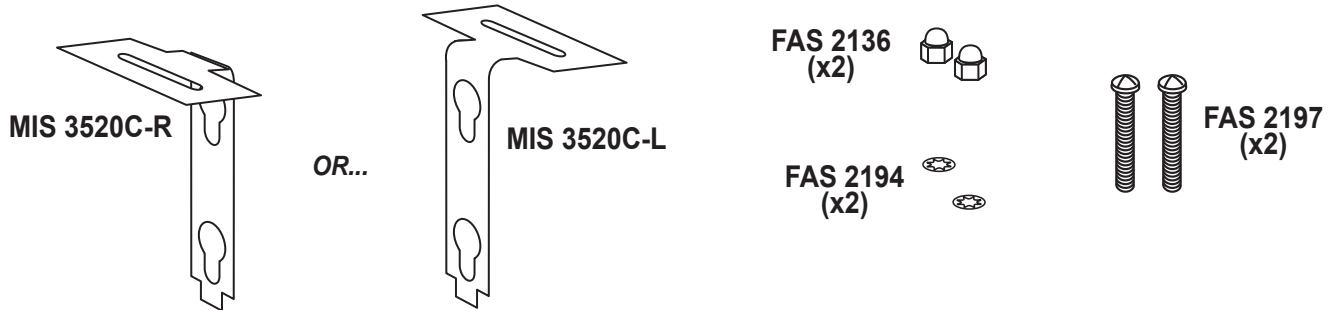

- 1** Place the support arm underneath the weight sensor. The arm should hang down between the sensor and the side of the façade hinged to the freezer. Line up the support arm slot under the two screw holes.

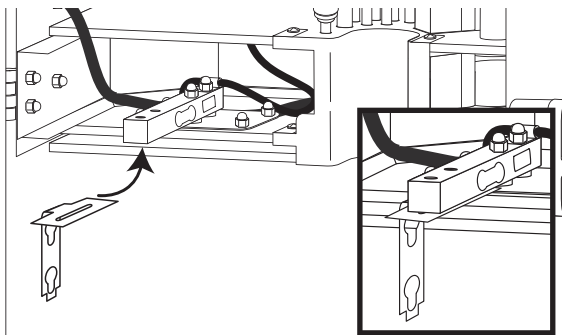

NOTE: WHEN INSTALLING THE LEFT SIDE FAÇADE, USE THE ARM SPECIFICALLY DESIGNED FOR THAT FAÇADE. IT SHOULD ALSO HANG BETWEEN THE WEIGHT SENSOR AND FREEZER.

- 2** Use the two long screws to secure the support arm to the weight sensor. Screw them into the sensor all the way, with the ends coming up through the top of the sensor.

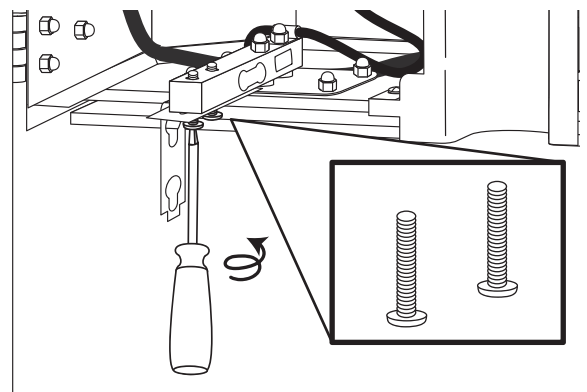

- 3** Install a lock washer on each screw end, and cap each end with a capnut.

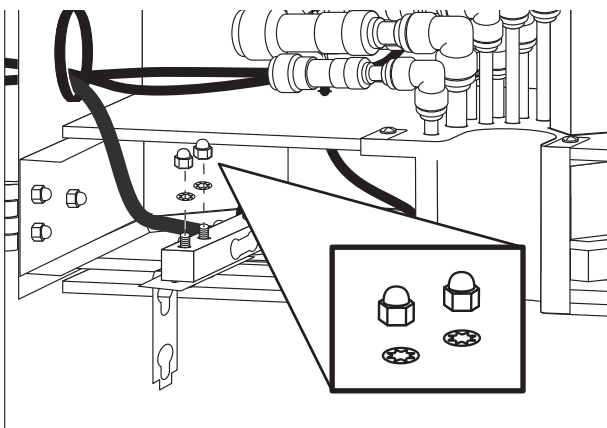

- 4** To tighten and secure the assembly, use a screwdriver to tighten the screws from underneath the support arm.

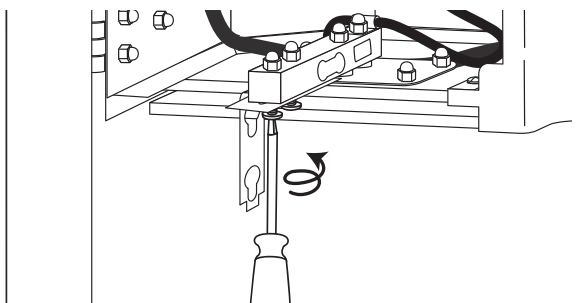

NOTE: DO NOT HOLD, LIFT OR PULL THE FAÇADE ASSEMBLY USING THE SUPPORT ARM OR THE WEIGHT SENSOR. THESE CONTAIN DELICATE ELECTRICAL CONNECTIONS. ALSO, DO NOT SET THE FAÇADE ON A SURFACE IN A WAY THAT PUTS PRESSURE ON THE SUPPORT ARM OR SENSOR.