

Flavor Burst[®]

MIS 3148 Suspension Bracket for C152 / C161 Freezer Assembly and Installation

The MIS 3148 Suspension Bracket is compatible with the Taylor C152 and C161 freezers. It is designed to support the heavier motors and offer more stable and secure support for the Blending Assembly than the universal suspension bracket. For more information, contact your local distributor.

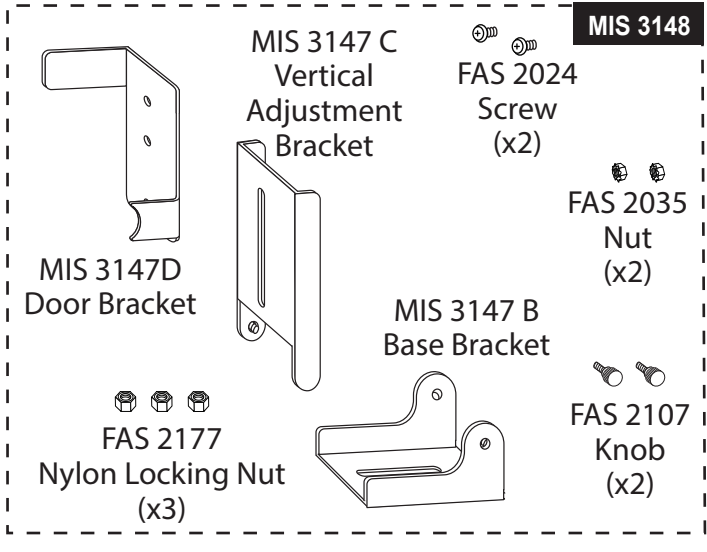

1 Ensure the spout adapter is installed on the freezer spout.

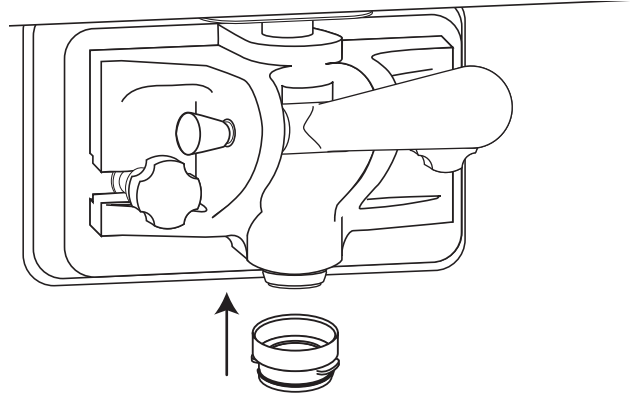

2 This bracket is intended to be mounted on the right side of the freezer door. Determine whether you want the bracket supported by the freezer door post (longer tab to the top), or the door nut slot (shorter, crescent-shaped tab to the top). Assemble accordingly and tighten the screws, nuts and knobs just enough to hold the assembly together while still able to move the bracket parts.

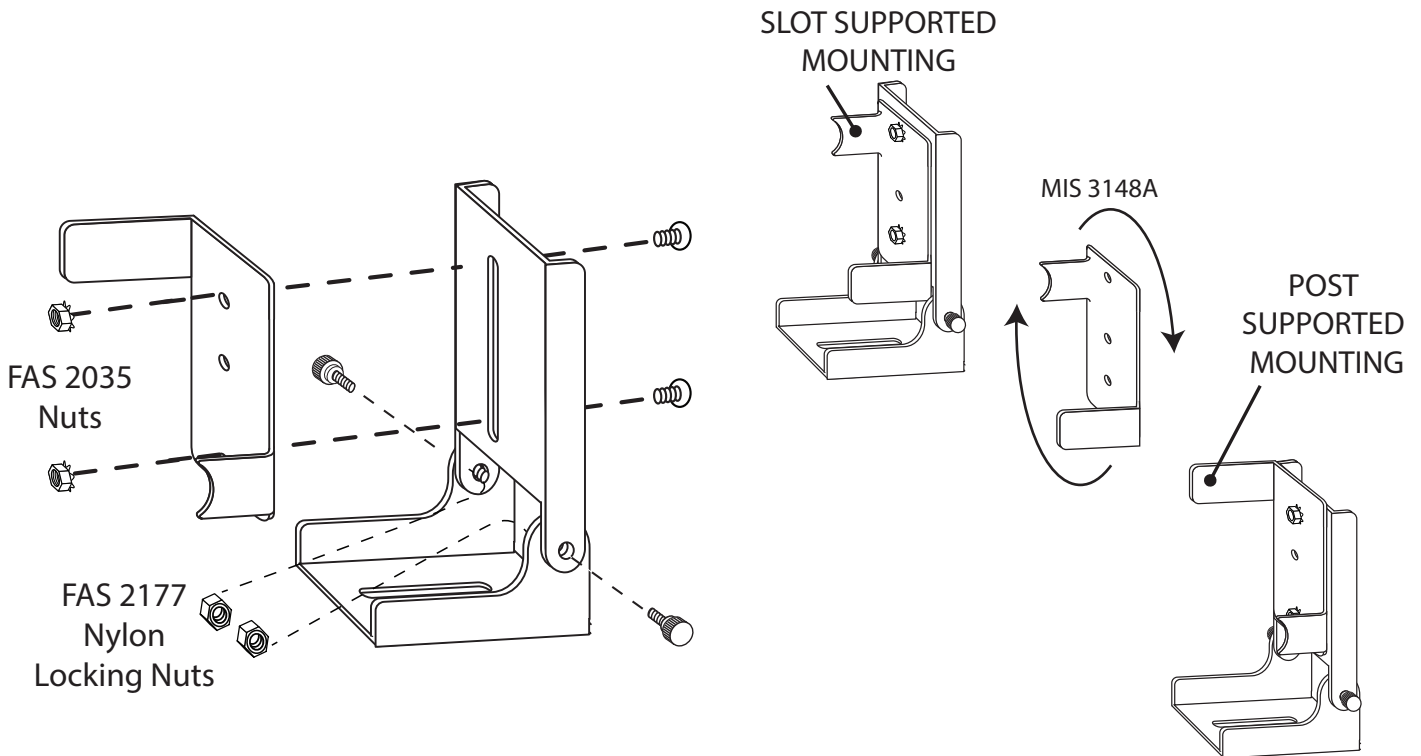

3A SLOT SUPPORTED MOUNTING: Insert the short tab of the bracket into the door nut slot. The tab should fit right next to the door nut inside the slot.

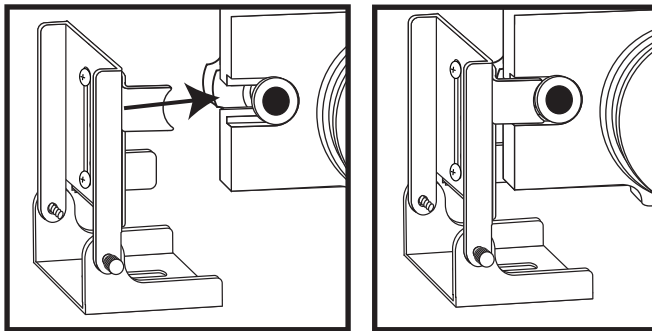
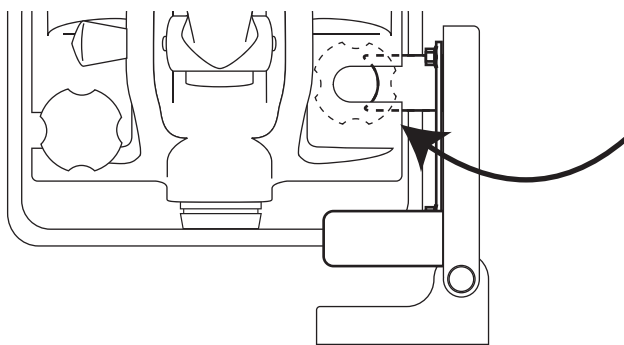

(view from the back side of the freezer door)

3B POST SUPPORTED MOUNTING: ****Ensure the freezer barrel is empty or the product is fully frozen before proceeding. Using this mounting procedure when product is not fully frozen may result in leakage.****

Slowly loosen the right side freezer door nut, just enough so that the longer tab of the bracket can wedge between the door and the freezer, just above the door nut slot. The bracket tab should rest on top of the door nut post.

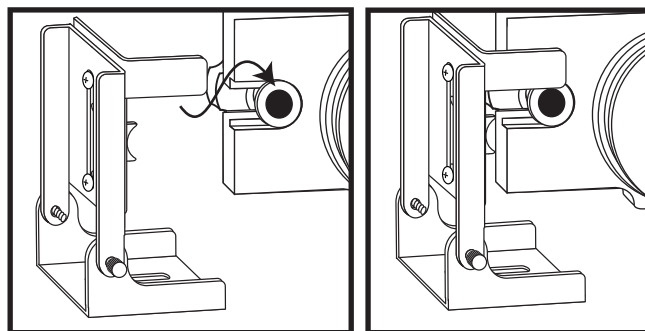
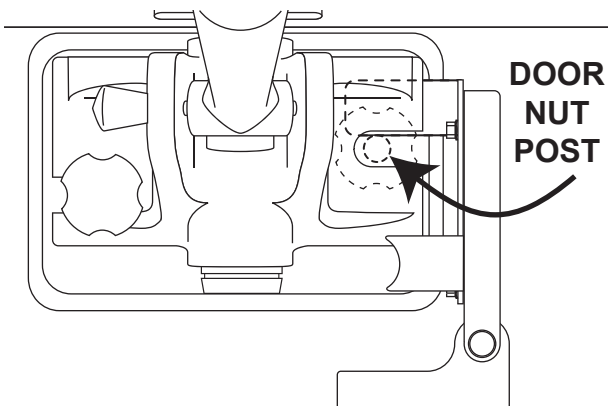

(view from the back side of freezer door)

4 Loosen the hinge knobs on the bracket. Slide the Gear Box through the bracket so that the Gear Box's threaded post sits in the slot.

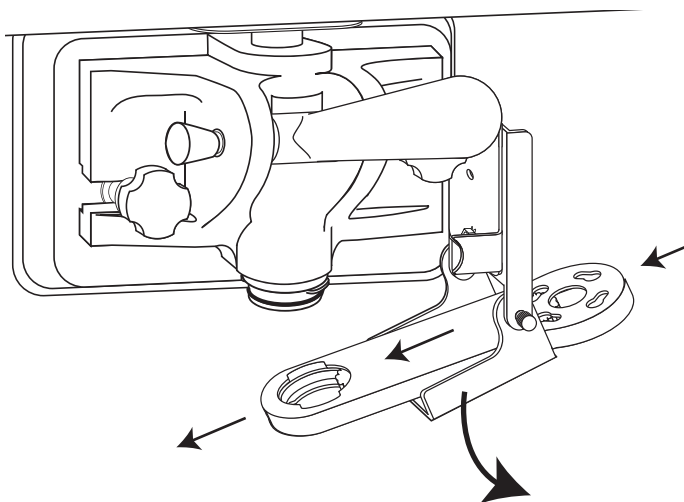

5 Install the Gear Cartridge and the Blending Head to the Gear Box, and then attach the Blending Head to the spout adapter. Turn the locking ring of the Blending Head over the spout adapter tabs to secure.

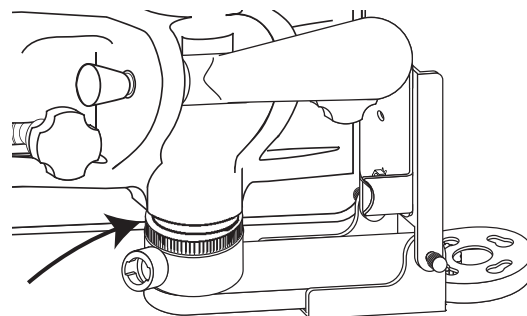
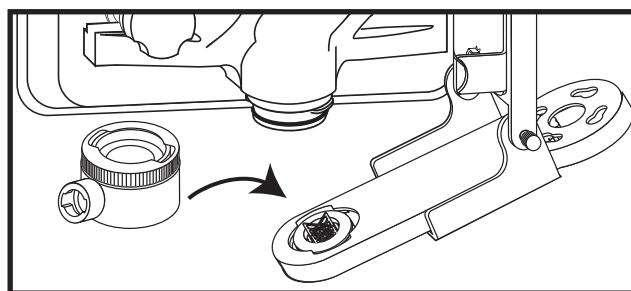

- 6** Position the bracket so that it is inline vertically and horizontally and the Gear Box is level. Tighten all the knobs, screws and nuts so that the assembly is secure. Make sure the freezer door nuts are tightened.

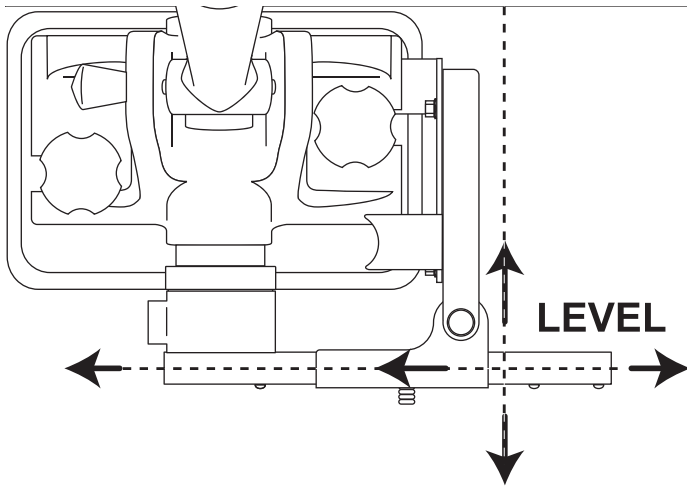

- 7** Install the Gear Box thumb nut underneath the Gear Box. For a more secure, semi-permanent installation, replace the thumb knob from under the mounting bracket with the FAS 2177 locking nut. With the Blending Assembly in proper installed position on the freezer, tighten the locking nut with a 3/8" nut driver to secure the assembly. Daily cleaning of the Gear Box can be done with the mounting bracket attached.

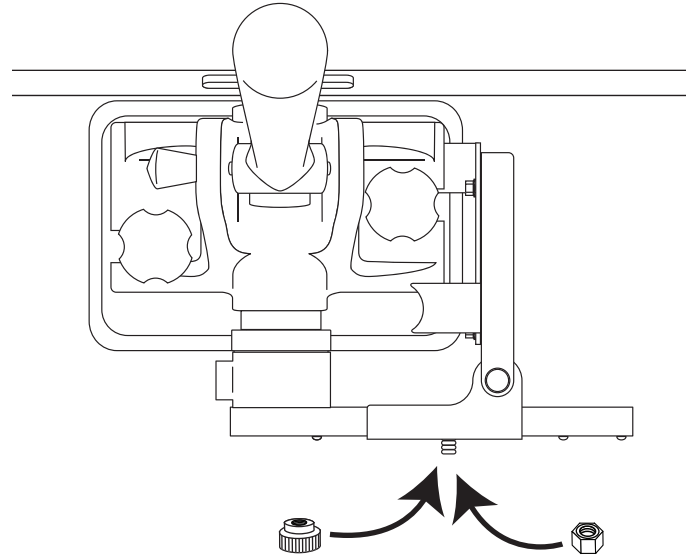

- 8** Install the Drive Motor onto the Gear Box and connect the 9-Tube Assembly to the Blending Head syrup port to complete the installation.

