

Flavor Burst®

Injector / Blending Assembly Basic Cleaning Instructions

The following basic cleaning instructions apply to parts that may be different from what is shown in your Operations Manual. Please refer to your Operations Manual for complete cleaning instructions involving your entire Flavor Burst system in order to be in compliance with the warranty requirements. Failure to clean and maintain your equipment as instructed may void the warranty. Use approved detergent cleaner and sanitizer solution for these procedures. If you have any questions, please contact your local distributor.

NOTE: IMAGES SHOWN MAY DIFFER SLIGHTLY TO YOUR OWN PARTS, BUT THE CLEANING PROCEDURE IS THE SAME ACROSS ALL INJECTOR & BLENDING ASSEMBLIES.

DAILY CLEANING

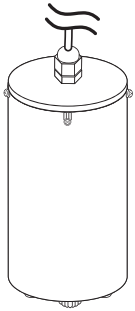

1. Remove the Drive Motor from the Blending Assembly.
2. **DO NOT IMMERSE THE DRIVE MOTOR IN WATER.** Instead, use a single service towel lightly moistened with water to clean the outside of the casing. Do not allow water inside the casing. Doing so may damage the Drive Motor and void the warranty.
3. Dry the Drive Motor completely.

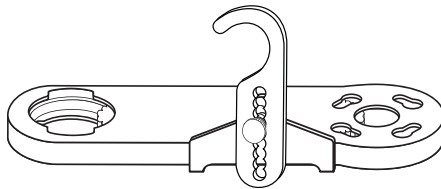

1. Clean, brush, and rinse the Blending Head, Gear Cartridge, and Gear Box.
2. Place the Blending Head, Gear Cartridge, and Gear Box in sanitizer solution for at least 1 minute.
3. Remove the parts and place them on a tray to dry.

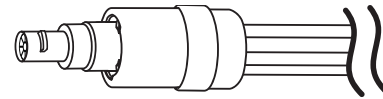

1. Spray the end of the 9-Tube Assembly with sanitizer solution and allow it to sanitize for at least 1 minute.
2. Allow the 9-Tube Assembly to dry completely.

MONTHLY CLEANING

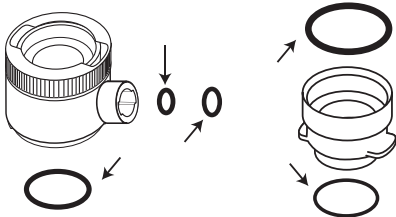

1. Remove the o-rings from the Blending Head and Spout Adapter. Inspect the o-rings for wear and replace if they are worn. Keep o-rings separated from each other to prevent them from getting mixed up.
2. Clean, brush, and rinse the Blending Head, Adapter, and o-rings.
3. Place the Blending Head, Adapter, and o-rings in sanitizer solution for at least 1 minute.
4. Remove the parts and place them on a tray to dry.
5. Install the lower o-ring onto the Blending Head.
6. Lube and install the Blending Head syrup port o-rings and the Adapter o-rings in their respective places. Ensure the o-rings are fully seated in the groves.