

Flavor Burst®

FAC 200K

Taylor C706/707/708/709 Freezer Facade Kit (no Touchscreen window) Assembly and Installation

The FAC 200K freezer facade kit is designed to mask and cover the freezer's parts, cables and electronics that are not necessary for most daily operations. The design allows for a larger flat surface to which a decorative wrap can be applied. It has an opening to access freezer controls, and is easy to remove to for maintenance and cleaning. Please note that this facade kit is intended to be used with Flavor Burst systems operated by the keypad (ie FB 80a) or by a side-mounted Touchscreen. Another facade kit, FAC 200KTS, is available if you wish to mount the touchscreen on top of the freezer; that facade has an opening at the top for the touchscreen. For more information, please contact your distributor.

FAC 200K

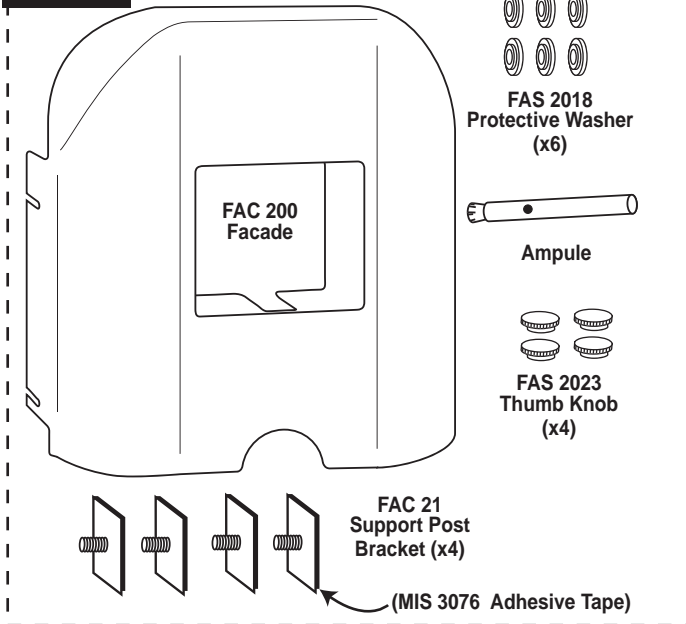

- 1 Disconnect and remove the Flavor Burst keypad with mounting bracket and the 9-Tube Assembly casing.

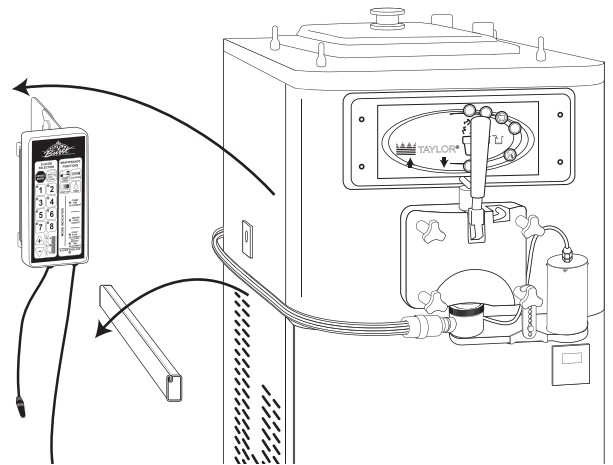

- 2 Thoroughly clean, rinse and dry the top front ledge and each side of the freezer.

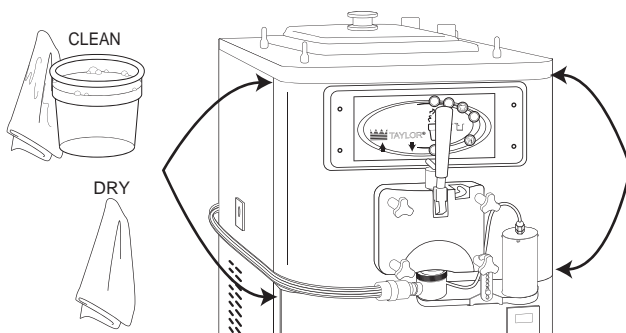

- 3 Pinch the primer (acetone) ampule at the dot on the tube to release the primer fluid into the brush end. Apply primer ampules to the sides of the freezer, between the service panel seam on where the front surface begins to curve. Allow the primer to dry completely before proceeding.

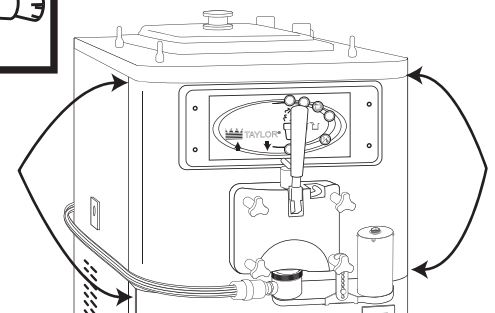
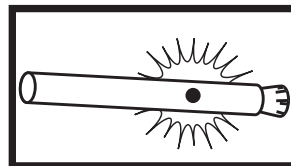

NOTE: THE FREEZER SURFACES MUST BE FREE OF ANY OILS OR RESIDUE OR THE ADHESIVE WILL NOT ADHERE PROPERLY.



NOTE: LIQUID IN THE AMPULES IMPROVES ADHESION.

- 4** Measure and mark the each side of the edge of the freezer 2" down from the top, and then again 10-3/4" from the top. These mark the positions for the four side brackets.

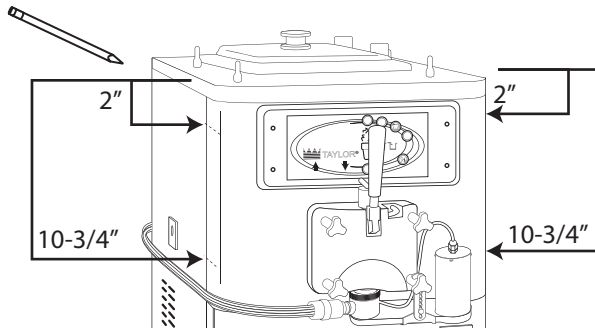

- 5** Remove the protective tape from each of the support brackets. Apply a bracket directly under each mark on the side of the freezer, as close to the curved edge as possible (approximately 1/4" from the service panel seam).

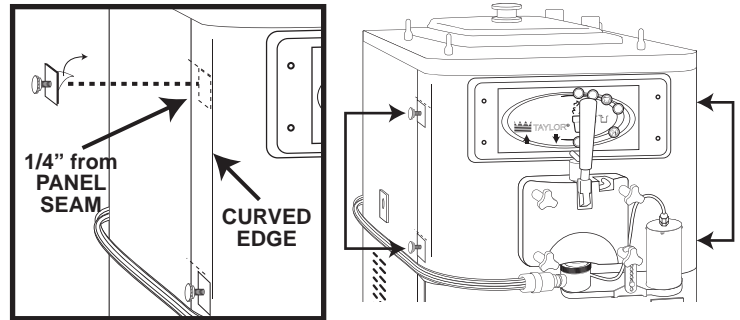

- 6** Install the facade onto the support bracket posts and secure it with the knobs.

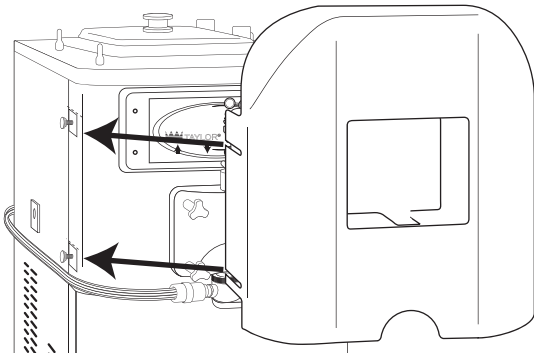

- 7** With a container under the spout, move the draw handle into the open position. If it comes in contact with the facade, loosen the support bracket hand knobs and pull the facade forward slightly until the draw handle is clear of it.

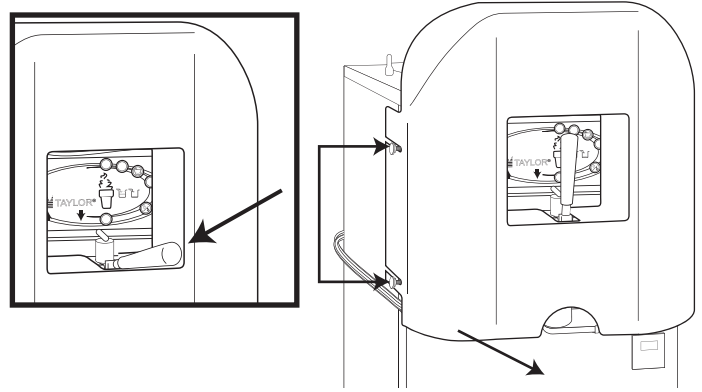

- 8** Once the support brackets and facade are in the proper position, REMOVE THE FACADE AND ALLOW THE ADHESIVE STRIPS TO CURE FOR AT LEAST AN HOUR BEFORE REINSTALLING THE FACADE.

WARNING: DO NOT ADD WEIGHT, SUCH AS THE FACADE, TO THE BRACKETS BEFORE THEY HAVE CURED FOR AT LEAST AN HOUR. DOING SO PULLS THE ADHESIVE STRIP FROM THE SURFACE AND IT WILL NOT ADHERE PROPERLY.

- 9** Reinstall the 9-Tube Assembly casing and the keypad. Reconnect the keypad to the switch port to complete the installation.

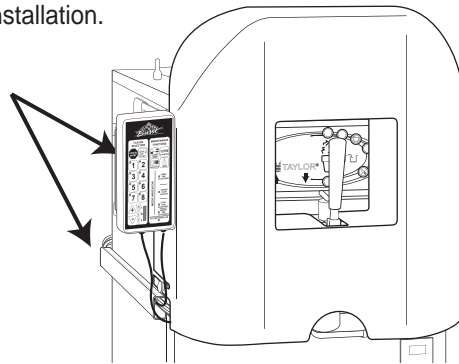

- 10 OPTIONAL:** If your facade has a wrap, you can use the protective washers included in this kit to prevent the wrap from buckling and twisting when using the thumb knobs. Install the washer on the bracket post, between the knob and the facade.

