

Flavor Burst™

CW 178 Mounting Bracket with Extension Kit Installation

The CW 178 Mounting Bracket is designed for a secure, long-term mounting of the CC8 system. With adjustable slides and screws, this bracket can be adjusted to fit most freezer models. However, should you require a different mounting kit for your freezer, contact your local distributor for additional information.

NOTE: ENSURE THE SURFACE OF THE FREEZER HAS BEEN CLEANED AND DRIED BEFORE INSTALLING THE MOUNTING BRACKET.

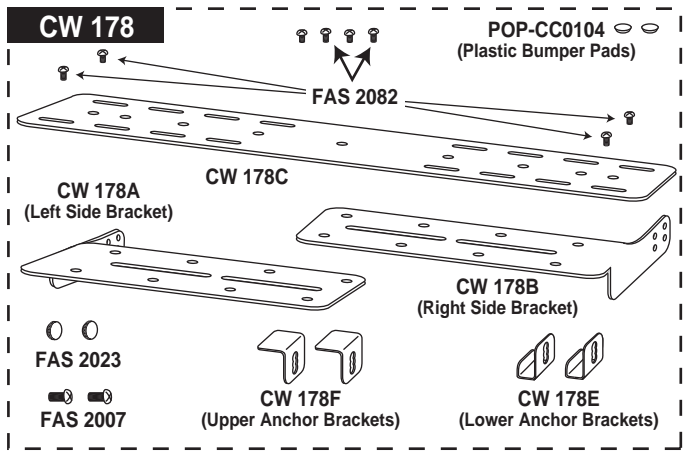

1 Assemble the Mounting Bracket as shown so that it is approximately the width of the freezer. The CW 178C is placed on top of the side brackets CW 178A and CW 178B. Use the screws to secure the assembly but do not tighten. Position the bumper pads on the underside of the bottom brackets, toward the center of the assembly and just in front of the bracket slots.

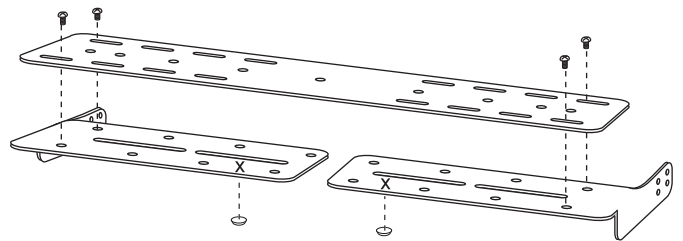

2 Ensure the freezer reservoir cover is in place. Place the assembled bracket on top of the freezer front and adjust the width of the bracket so that the side brackets are pressed against each side of the freezer. Position the bracket assembly even with the front edge of the freezer whenever possible. If it interferes with the reservoir cover, position it as close to the reservoir cover as possible so that there is minimal overhang of the bracket assembly over the front edge.

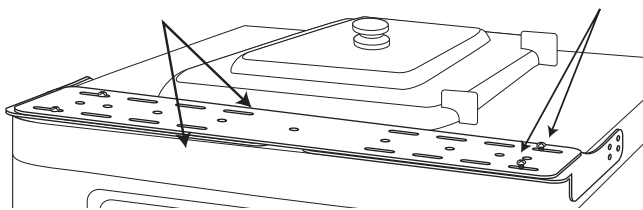

3 Find the correct placement of the lower anchor bracket by holding it up to the side bracket screw holes. Line up the anchor bracket bottom slightly below the edge of the freezer cap. Align the anchor bracket opening with a screw hole closest to the end of the side bracket whenever possible. Take note of this screw hole and where it falls in the anchor bracket opening.

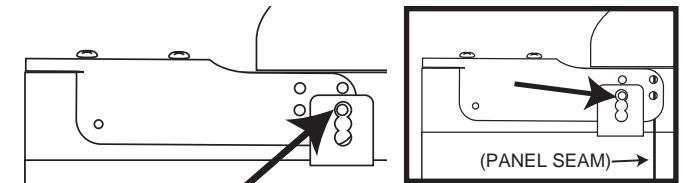

NOTE: USE AN INNER SCREW HOLE IF A FREEZER PANEL SEAM IN THE WAY OF THE OUTER HOLES.

4 Install an FAS 2007 screw through the lower anchor bracket opening where the screw hole appeared. Slide the bracket assembly open and install the anchor bracket up under the lip of the freezer cap directly behind the appropriate side bracket screw hole. Install the anchor bracket on the other side of the freezer.

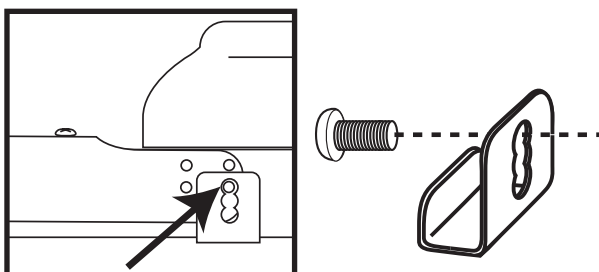

5 Slide the bracket assembly open and install the lower anchor bracket up under the lip of the freezer cap directly behind the appropriate side bracket screw hole. Repeat steps 4 and 5 to install the other anchor bracket on the other side of the freezer.

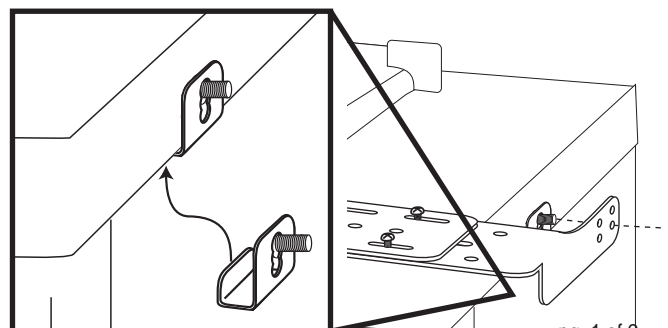

- 6** Install an upper anchor bracket over the screw post of each lower anchor bracket so that they rest over the top edge of the freezer.

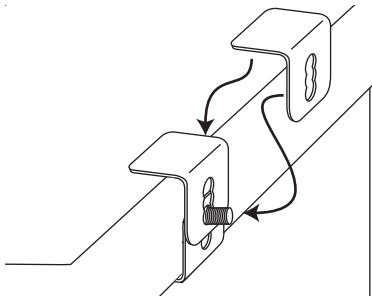

- 7** Slide the bracket assembly firmly together over the screws through the designated screw hole on each side bracket. Tighten the bracket assembly screws and install thumb nut onto each anchor bracket screw.

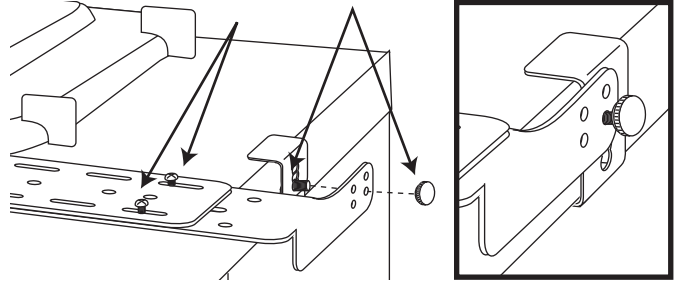

- 8** Install the mounting base onto the base extension and secure it with the thumb nut. Ensure the thumb nuts are totally seated in the recess of the mounting base screw slots.

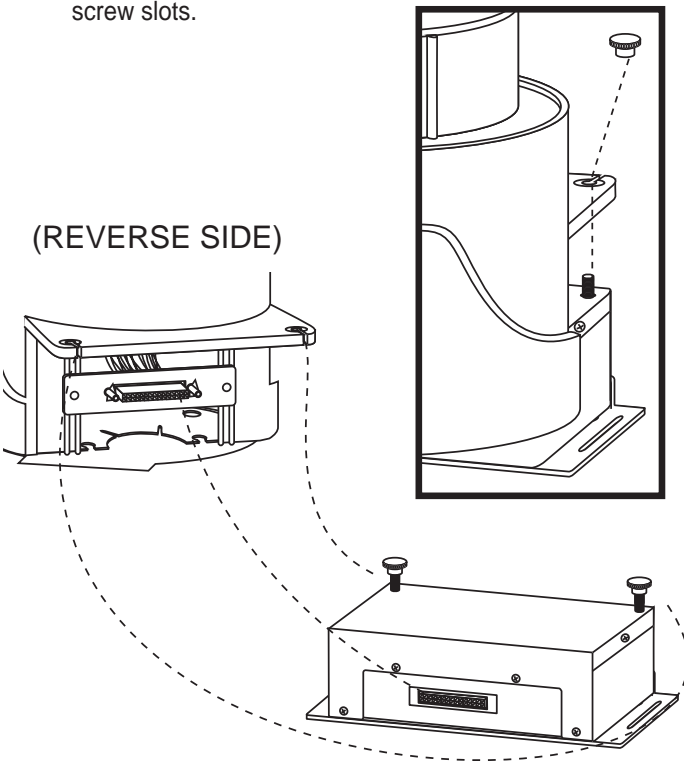

- 9** Position the mounting base assembly on top of the freezer. If the draw handle is operated by the left hand, the center of the mounting base should be mounted within 3" to the right of the draw handle. If the draw handle is operated by the right hand, the mounting base should be mounted within 3" to the left of the draw handle. Once in position, secure the mounting base to the CW 178C bracket using the screws provided.

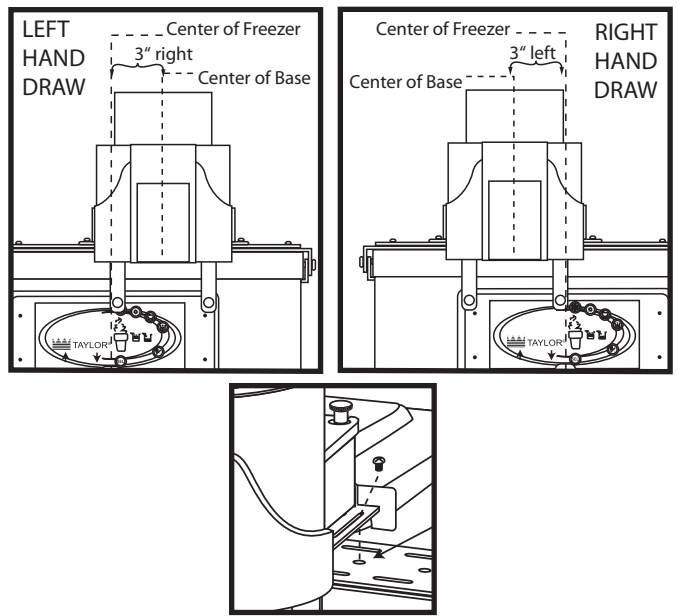

- 10** Ensure the chip hopper funnel is in place within the mounting base and install the carousel over the funnel with the #1 dispensing module in front. Ease the carousel down onto the mounting base until the electrical connection engages.

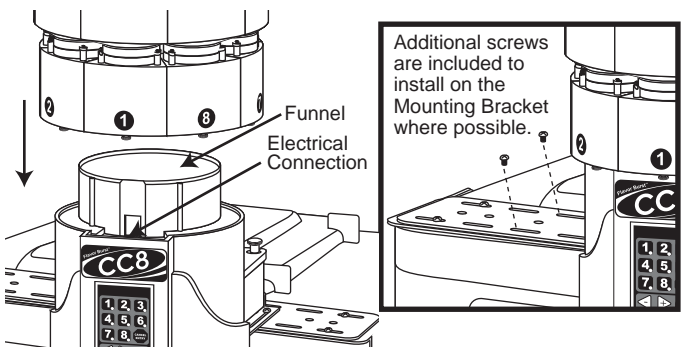

- 11** To clean the area under the Mounting Bracket, remove the carousel from the mounting base and rotate the assembly up and back over the reservoir cover. The assembly is hinged on the anchor brackets.

