

Flavor Burst™

CW 169-A CC8 Keypad Mounting Bracket Assembly Assembly and Installation

The CC8 Keypad Mounting Bracket Assembly attaches to the Flavor Burst CC8 system to securely hold the Flavor Burst Keypad. It can be mounted to either side of the CC8 Mounting Base. Follow these instructions for the assembly and installation of the CW 169-A assembly, or for more information, contact your local distributor.

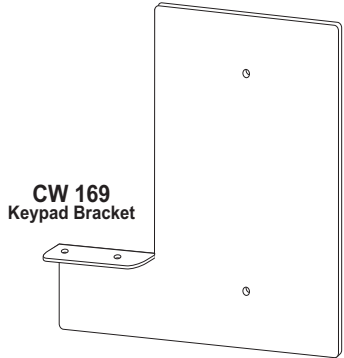
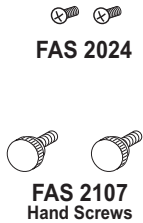

1 Determine which side of the CC8 Mounting Base to attach the Keypad. For mounting on the right side of the freezer, flip the bracket so that the bracket lip folds forward and is on the left side of the bracket. For left-side mounting, the bracket lip should be on the right side and folded back from the bracket face.

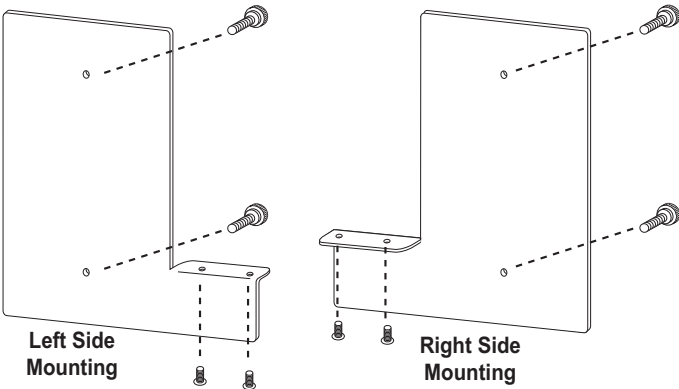

2 Install the hand screws from behind the bracket face but do not tighten them to the point where the ends protrude through the other side.

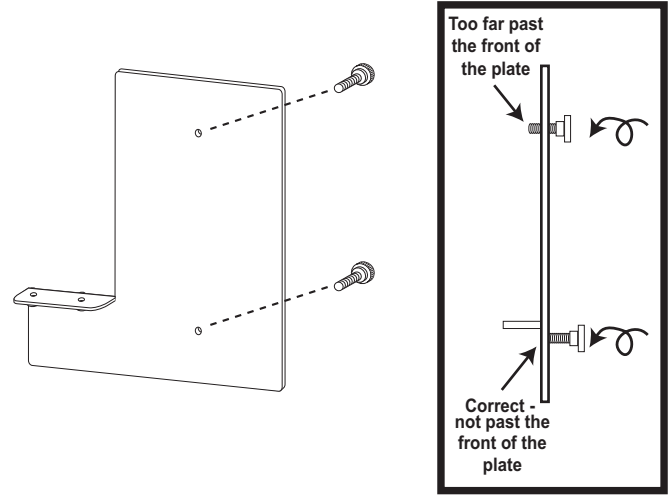

3 Using the two screws, attach the bracket to either set of screw holes on underside of the Mounting Base.

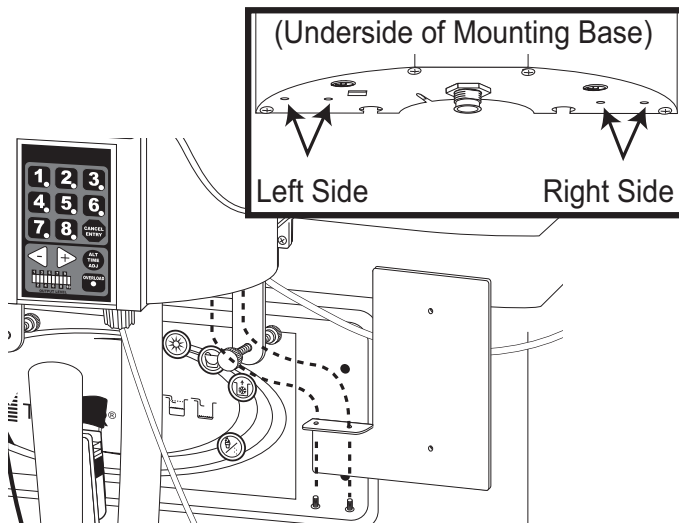

4 Slide the Keypad onto the bracket. Tighten the hand screws from the back side of the bracket to secure the Keypad.

