

Flavor Burst™

CW 167 Elevated Mounting Bracket Kit

Installation

This mounting procedure and bracket kit should be used only on freezer models that have hopper lids located too close to the front of the freezer for the standard mounting bracket to fit. This mounting bracket kit raises the base above the edge of the lid. Ensure the freezer operational controls are not obstructed by the mounting base and this bracket kit. This secure mounting kit and method is for long-term or permanent mounting of the CC8. Should you require a different mounting kit for your freezer, contact your local distributor for additional information.

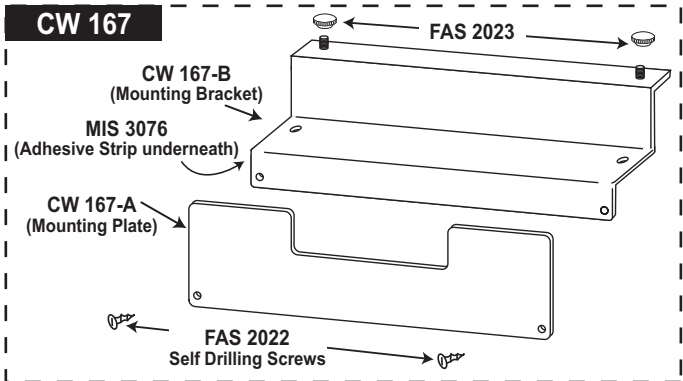

- 2** Assemble the mounting base to the base mounting bracket and tighten the thumb nuts to secure.

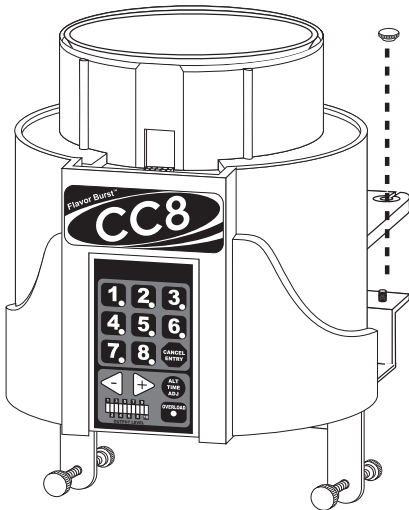

- 4** Set the assembly as far back on the ledge without obstructing any of the freezer operational controls. Slide the base and extension as far back onto the freezer as possible.

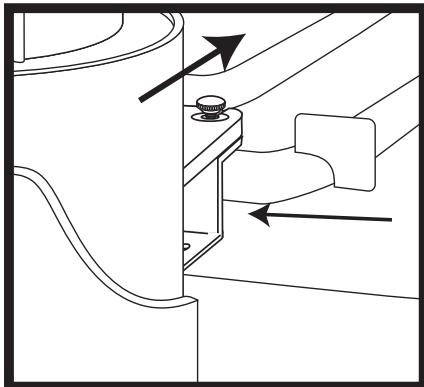

- 1** Thoroughly clean and dry the surfaces of the freezer where the mounting assembly will be attached. Using a soft lead pencil, mark the center of the freezer top, directly above the door spout.

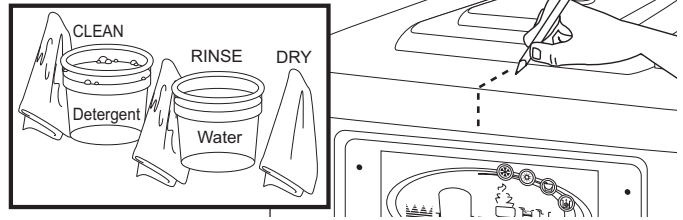

- 3** Position the center of the mounting base assembly within 3 inches left or right of the freezer center. If the draw handle is operated by the left hand, the Mounting Base should be mounted within 3" to the right of the center of the draw handle. Conversely, if the draw handle is operated by the right hand, the Mounting Base should be mounted within 3" to the left of the center of the draw handle.

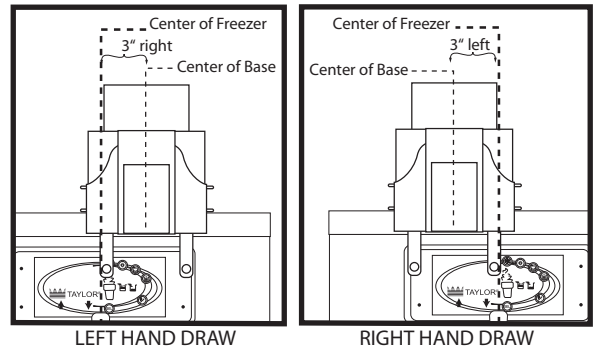

- 5** Use the vertical stabilizer bar screws to extend the bars downward as far as possible without obstructing any freezer operational controls. Tighten the screws to secure the position.

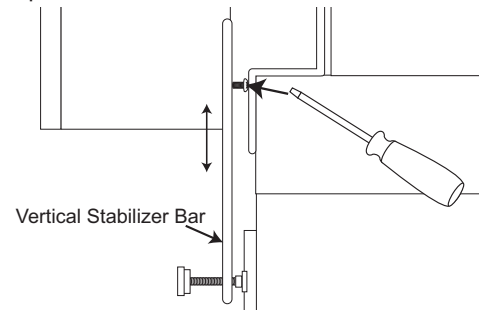

NOTE: REMOVE THE MOUNTING BASE FROM THE BRACKET TO LOOSEN AND TIGHTEN THE VERTICAL STABILIZER BAR SCREWS.

- 6** Using a soft lead pencil, mark around the mounting bracket and inside the screw holes of the bracket.

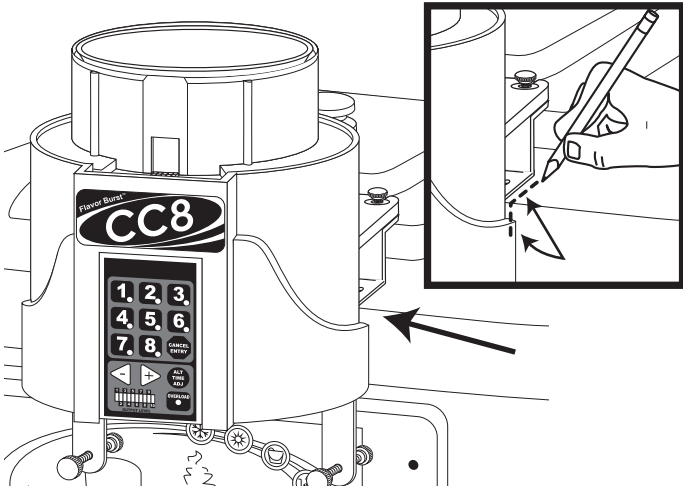

- 7** Remove the mounting bracket plate from the assembly, remove the protective tape from the adhesive, and press the bracket within the pencilled marks on the freezer. Carefully drill a 1/8" hole into the freezer through each of the screw holes.

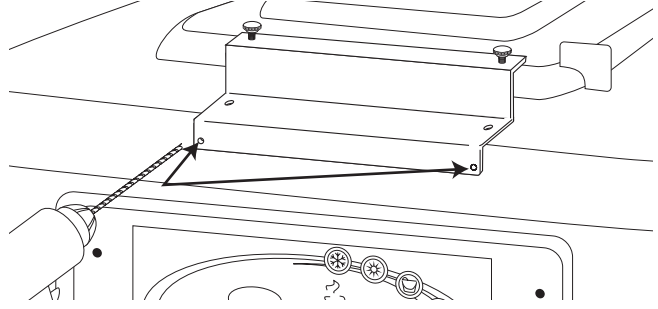

NOTE: BEFORE DRILLING, ENSURE THERE ARE NO WIRES BEHIND THE PANEL WHERE THE DRILL HOLES WILL BE MADE.

- 8** Install the screws into the drilled holes to secure the mounting bracket.

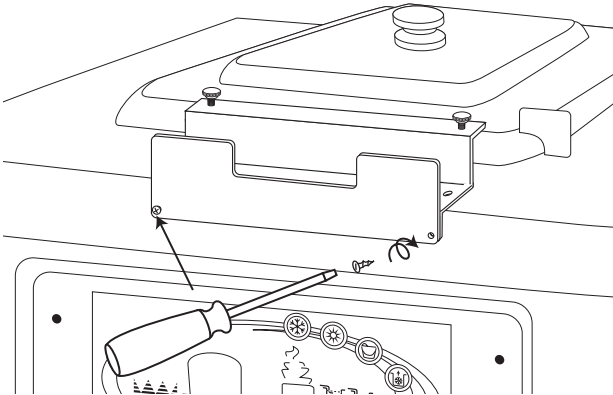

- 9** Remove the thumb nuts from the mounting bracket. Install the mounting base onto the mounting bracket studs and install the thumb nuts of the bracket plate to secure.

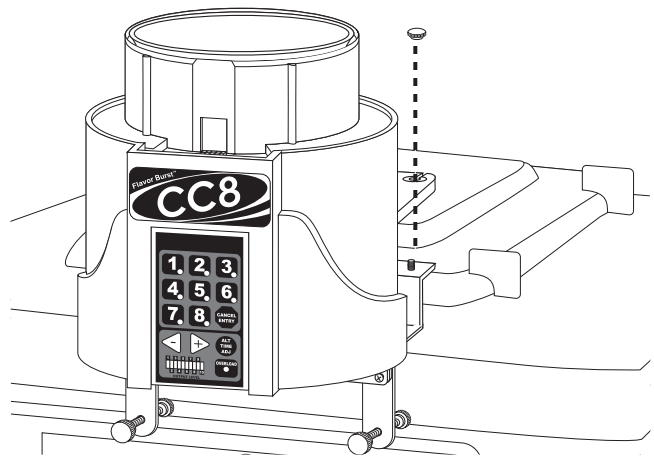

- 10** Adjust the vertical stabilizer bar thumb nuts to ensure the mounting base is level.

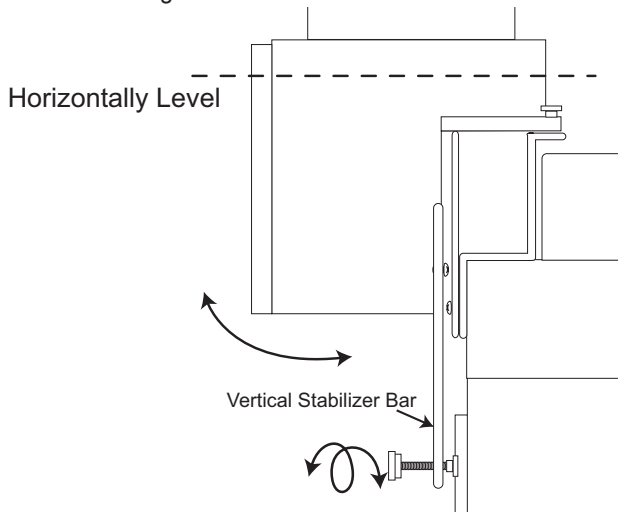

- 11** Ensure the chip hopper funnel is in place within the mounting base and install the carousel over the funnel with the #1 dispensing module in front. Ease the carousel down onto the mounting base until the electrical connection engages.

