

# Flavor Burst®

## CG 200 CC8 Candy Chopper

### Assembly and Maintenance

The CG 200 Candy Chopper chops larger candy, nut, and cookie pieces into particles small enough to be used with the Flavor Burst® CC8 systems. Follow the instructions to disassemble, clean and reassemble the Chopper. Contact your local Flavor Burst® distributor for more information.

**!** **NOTE:** ENSURE THE CANDY CHOPPER IS UNPLUGGED FROM THE POWER SOURCE BEFORE REMOVING ANY PARTS FROM THE ASSEMBLY.

**!** **NOTE:** TAKE CARE WHEN HANDLING THE CHOPPER BLADES. AVOID HANDLING THE JAGGED EDGES WHENEVER POSSIBLE.

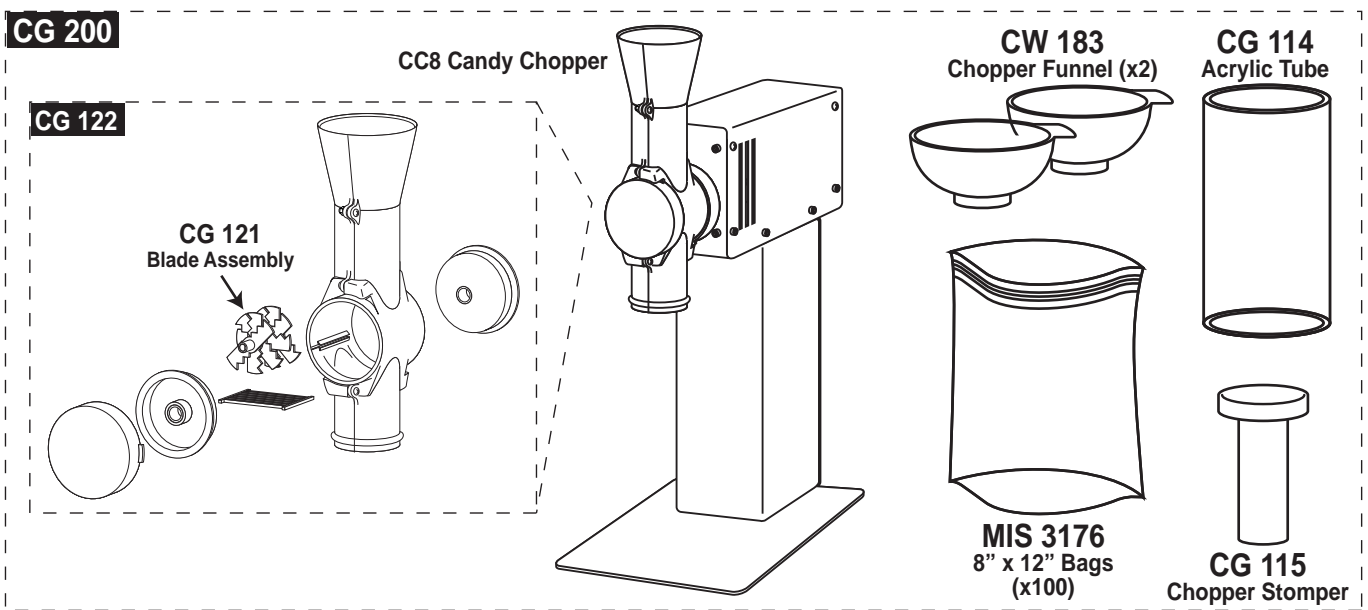

**1** Unlock the Chopper End Cap by turning it clockwise 1/4 turn and then remove it from the Chopper Assembly.

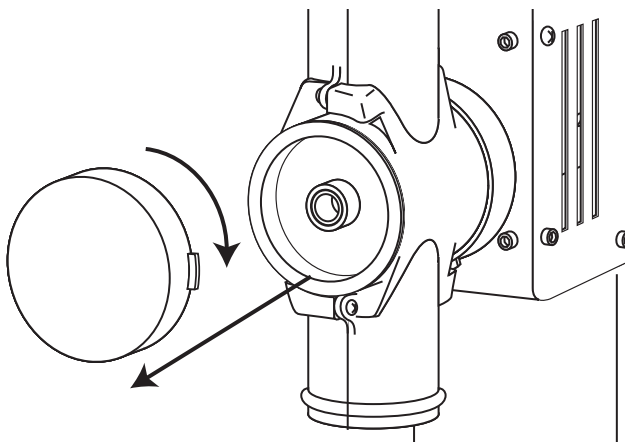

**2** Remove the Shaft Bushing Housing.

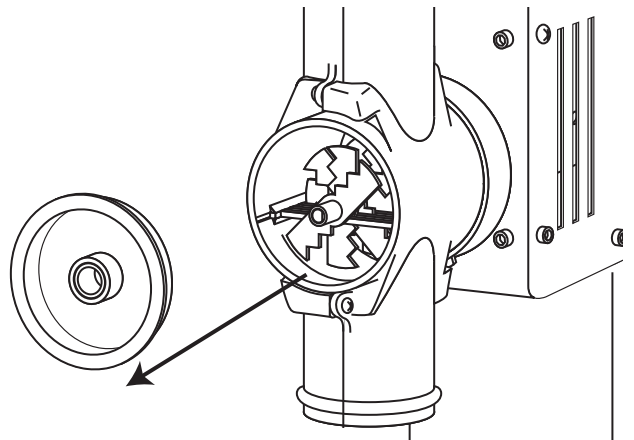

- 3** Carefully remove the Chopper Blades and Shear Plate from inside the Chopper Assembly.

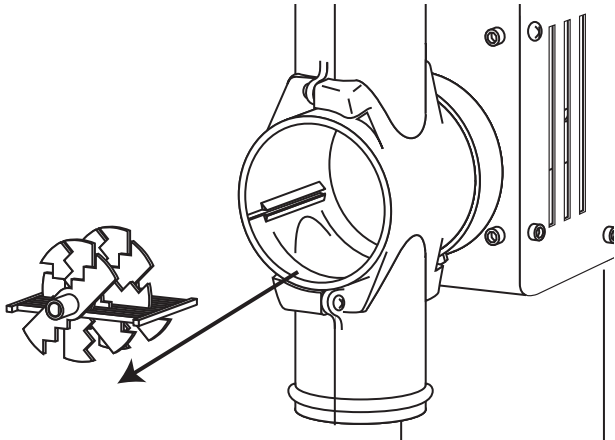

- 4** Remove the Chopper Housing by turning it clockwise 1/4 turn and pulling it out from the base.

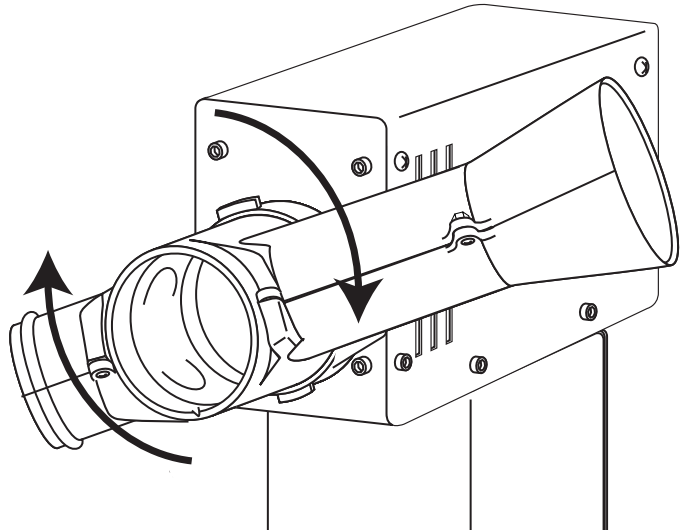

- 5** Remove the other Shaft Bushing Housing from the Chopper Housing.

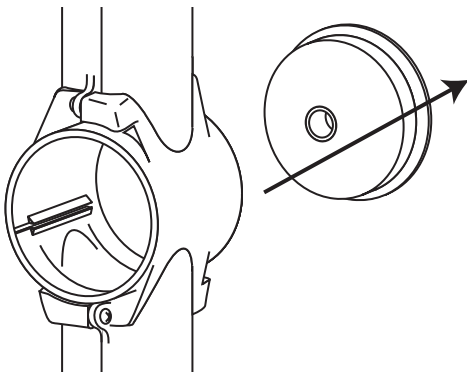

- 6** Clean the Chopper Housing, Blades, Shear Plate, Shaft Bushing Housing and End Cap using a brush and detergent water. Rinse parts thoroughly.

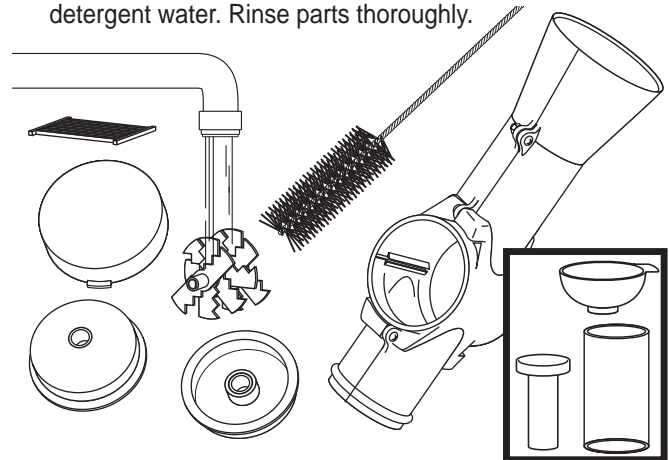

**!** **NOTE:** IF THE ACRYLIC TUBE, STOMPER AND FUNNEL HAVE BEEN USED, CLEAN THESE AS WELL.

- 7** Place the Chopper parts on a sanitary tray to air dry.

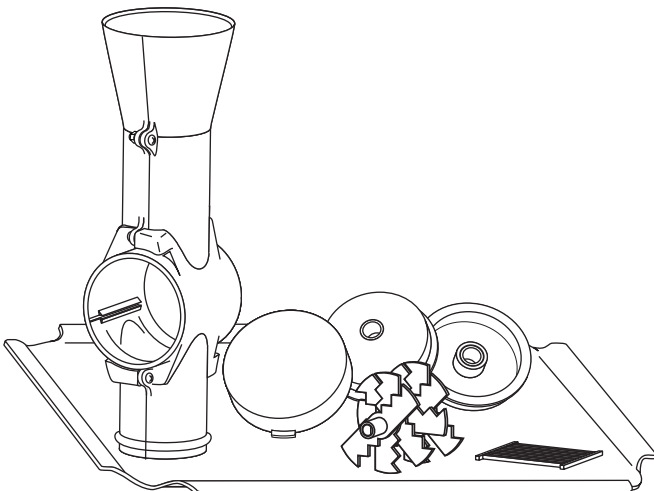

- 8** Install one Shaft Bushing Housing in one side of the Chopper Housing.

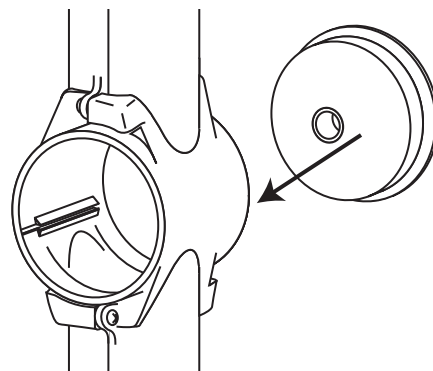

**9** Install that end onto the Base by rotating it 1/4 turn counter clockwise until the Chopper Housing is vertical.

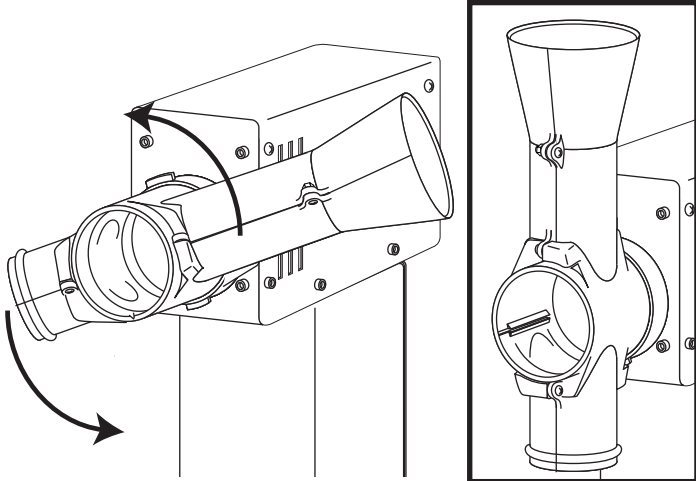

**10** Place the Chopping Blades into the Shear Plate so that it is centered on the Plate.

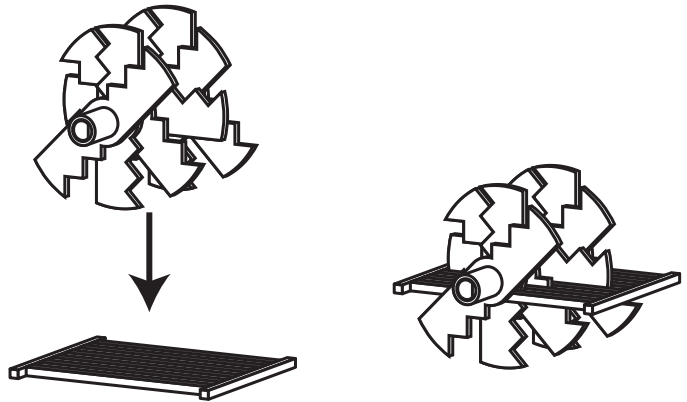

**11** With the chopping edge of the blades facing to the left, slide the plate with the blades into the slots inside the Chopper Housing.

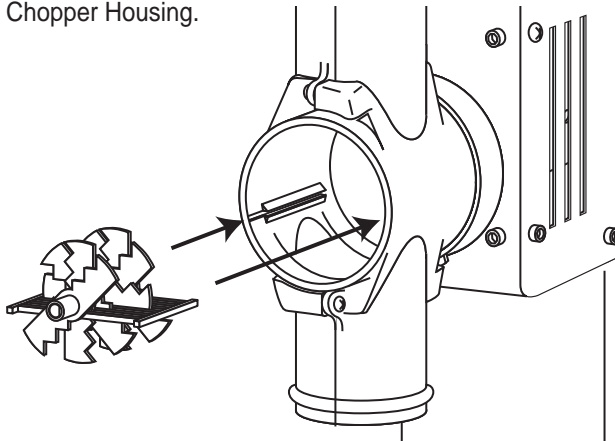

**12** Slide the plate with the blades back onto the motor shaft of the base. Rotate the blades so that the blade shaft is installed onto the base motor shaft and is pushed back as far as possible.

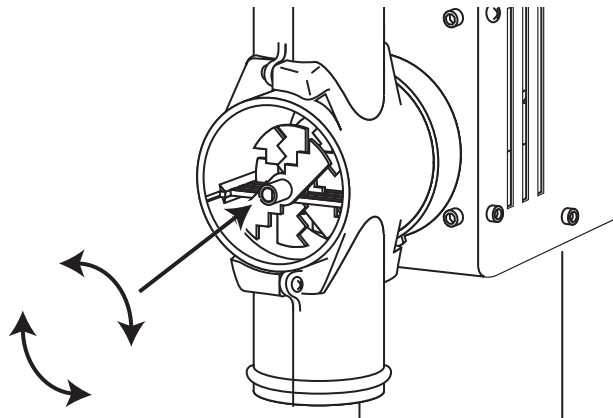

**13** Install the remaining Shaft Bushing Housing into the opening of the Chopper Housing.

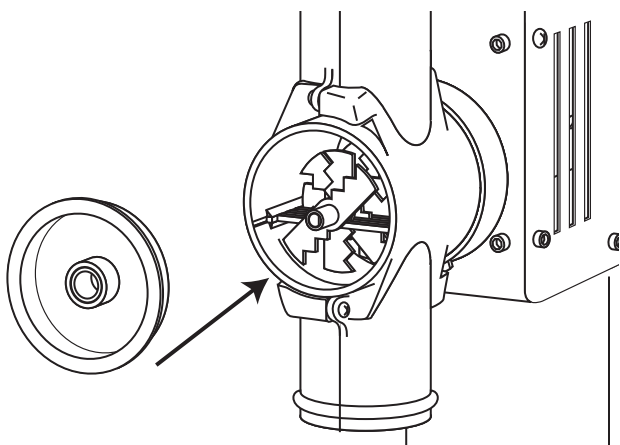

**14** Install the End Cap onto the Chopper Housing by rotating it 1/4 turn counter clockwise to complete the assembly.

