

Flavor Burst®

ADPT TY80S-FCB1TS

FCB Touchscreen Auto Draw Valve Upgrade Kit Installation

This kit converts the Flavor Burst® TS 80FCB draw-handle operated system to a Flavor Burst® auto draw valve FCB system. When attached to an FCB freezer, this system allows for push-button dispensing without the use of a draw handle. The following instructions are for a field conversion of the freezer. For more information, please contact your local Flavor Burst® distributor.

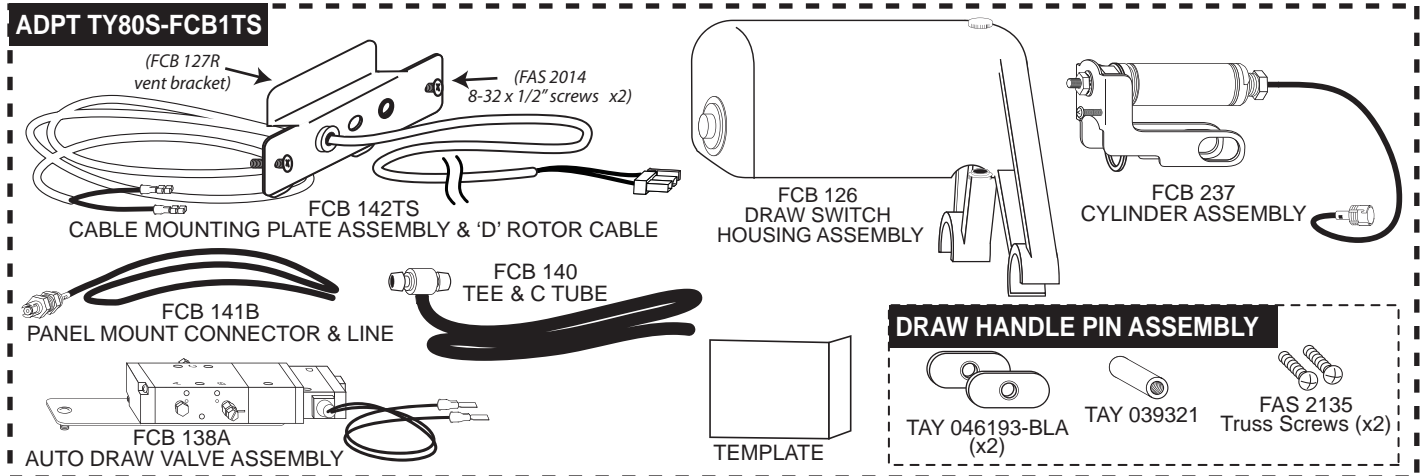

- 1 Remove the Touchscreen and Mounting Bracket from the freezer. Also, remove the 9-Tube Assembly and the Tube / Cable Casing and set them aside.

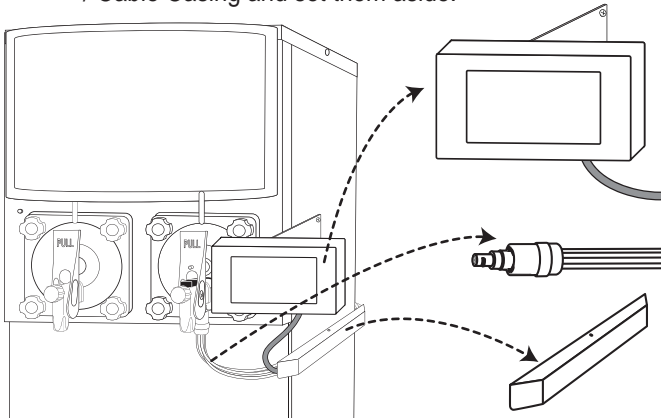

- 2 Remove the cap, spring, and Flow Rate Controller Assembly from the modified door spout. Set aside the cap and spring.

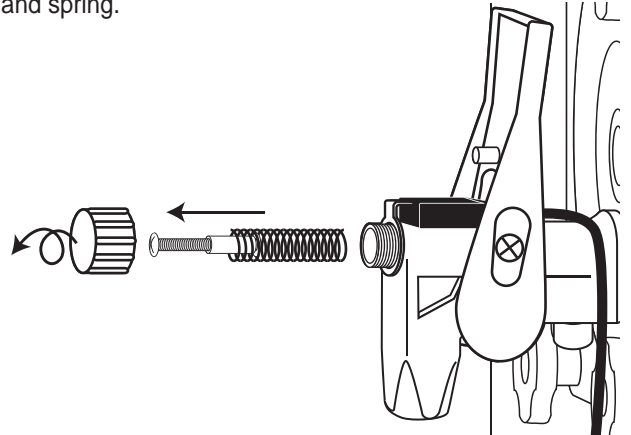

- 3 Remove the draw handle and the draw handle pin assembly from the modified door spout that came with the Flavor Burst FCB system.

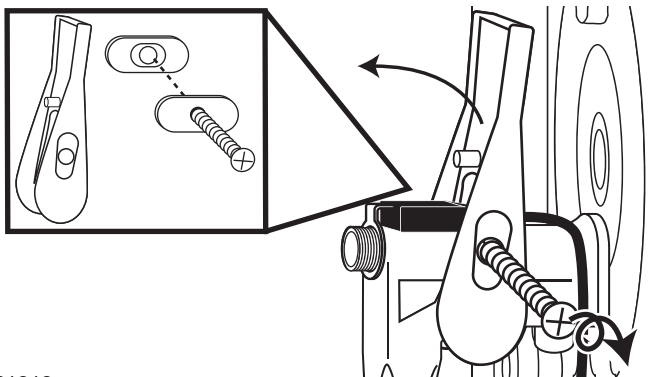

- 4 Disconnect and remove the spigot switch assembly. Ensure the two o-rings are in their respective grooves inside the syrup port.

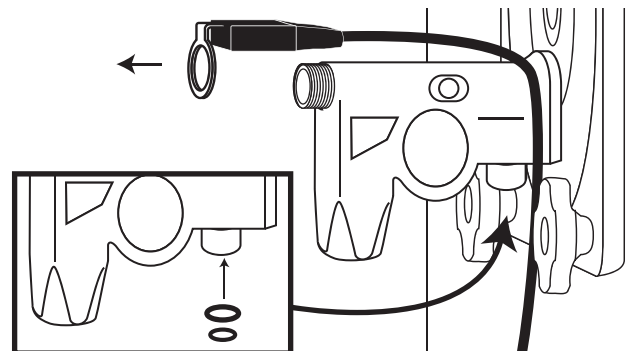

- 5** Install the Cylinder Assembly on the door spout by sliding the bracket over the threaded portion of the door spout.

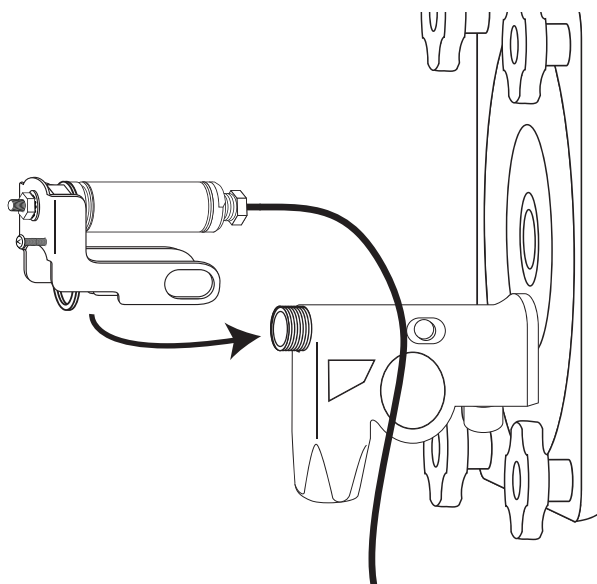

- 6** Install the draw handle pin assembly from the kit onto the Cylinder Assembly and tighten screw to secure.

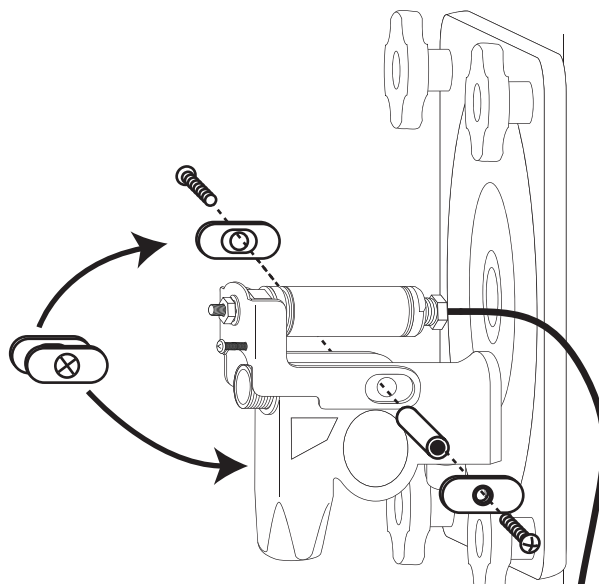

- 7** Insert the spring into the draw spout opening and install the cap onto the assembly.

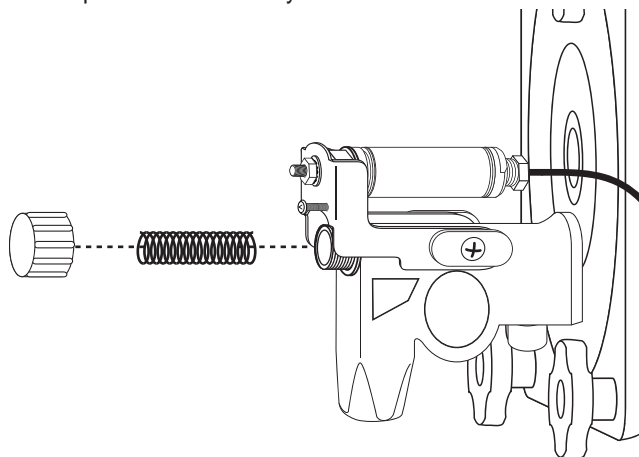

- 8** Place the drilling template on the front service panel under the draw spout so that the folded edge is placed along the service panel edge. Tape the template in place or mark the hole to be drilled in front service panel.

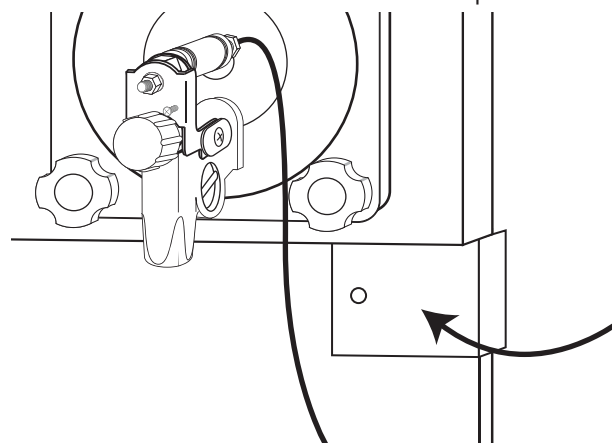

- 9** Remove the panel and drill the 7/16" hole where marked. Deburr the hole if necessary.

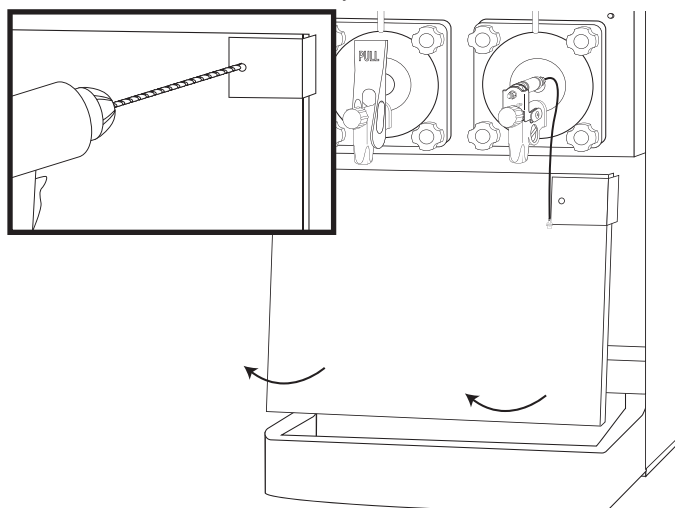

- 10** Install the panel mount connector on the panel, inserting the connector line through the hole. Secure the connector from the inside of the panel with the nut provided.

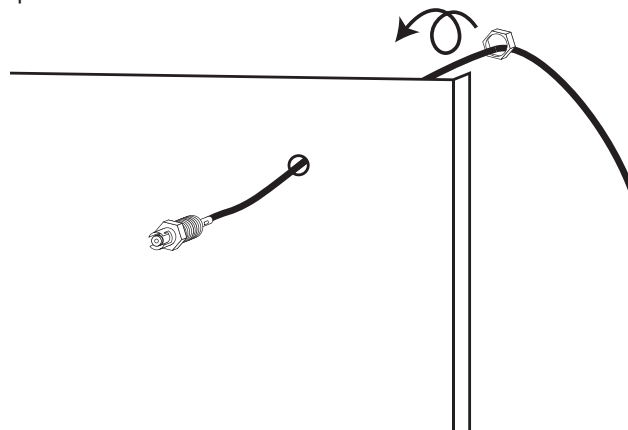

- 11** Reinstall the front service panel with the connector securely in place and tubing to the inside. Ensure the cable falls against the panel and under the support bar so that it does not interfere with any internal freezer parts.

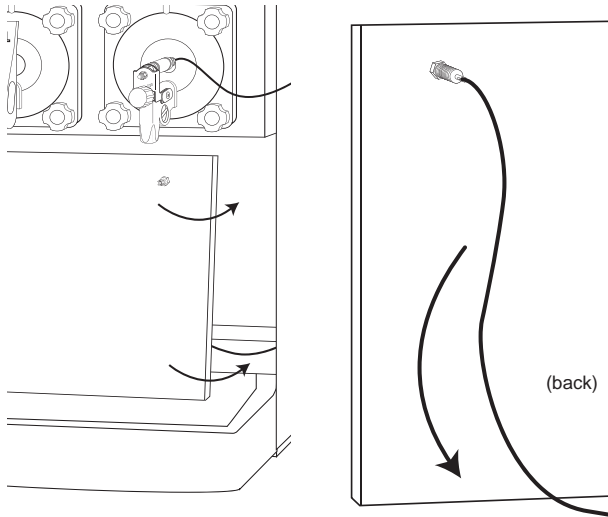

- 12** Remove the side service panel nearest the connection.

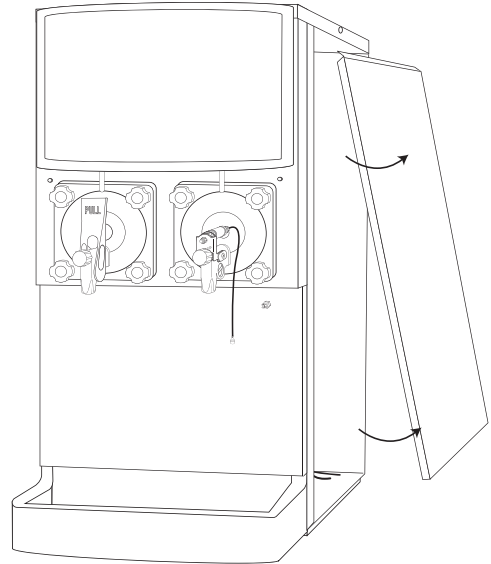

- 13** Install the Valve Assembly inside the freezer cabinet using the screw provided. Mount the base housing to the existing bracket as shown.

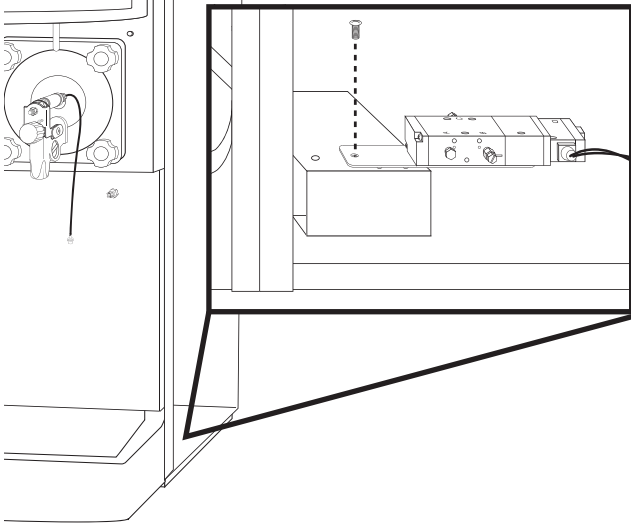

- 14** Connect the air tube to the B port on the valve. Use the tubing sleeves to secure the tube on the barb connection.

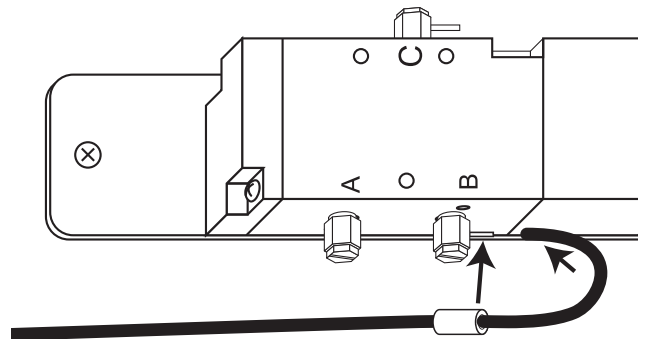

- 15** Install the cable mounting plate assembly on the same side as the Auto Draw Valve Assembly. Slide the spade connector ends of the cables through the 2nd slot from the bottom of the freezer's back vent cover.

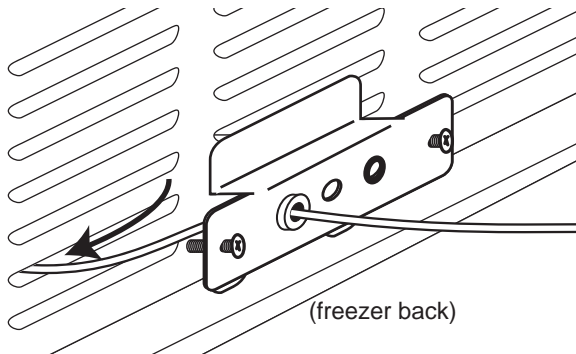

- 16** Angle the upper bracket lip up through the 3rd vent slot from the bottom, so that the lower bracket lip can slide into the bottom vent slot. Slide the bracket down as far as it will go.

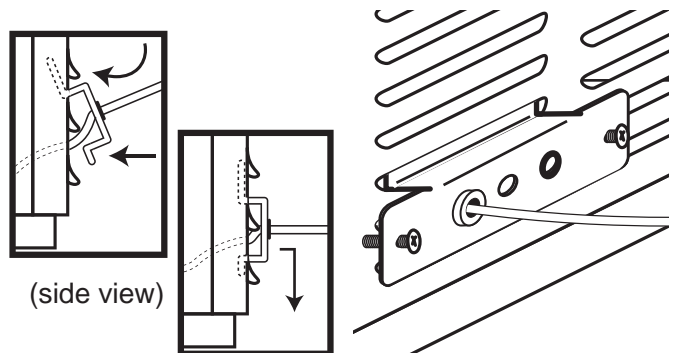

- 17** Slide the bracket down and turn the side screws to brace the assembly against the freezer.

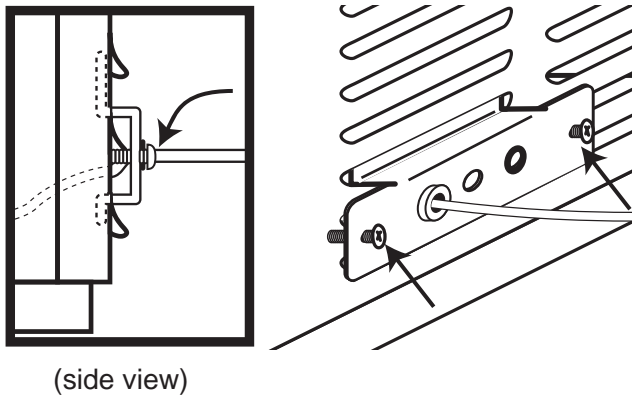

- 18** Connect the female spade connectors of the Rotor Cable D to the male connectors on the D Valve.

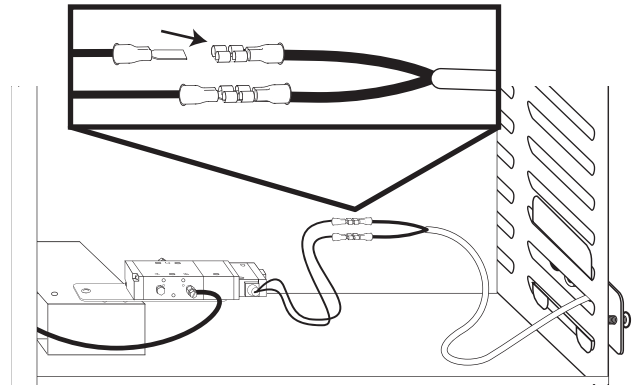

- 19** Insert the C tube through the hole with the black ring on the Cable Mounting Plate Assembly. Connect the tube to the C Valve inside of the freezer.

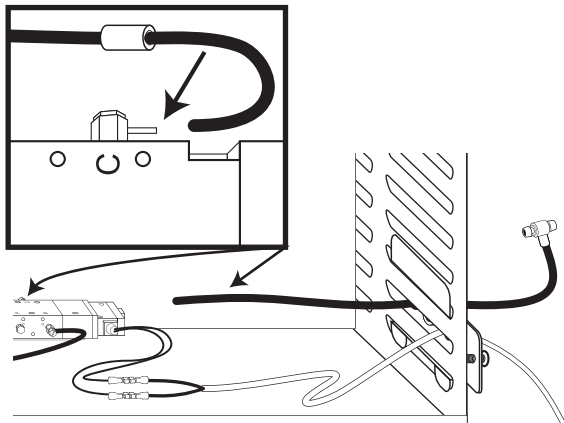

- 20** Ensure the CO2 tank is closed and then cut the supply line about 3" from the rear of the freezer. Install the Tee with the C tube in the CO2 supply line. Use clamps to seal the connections.

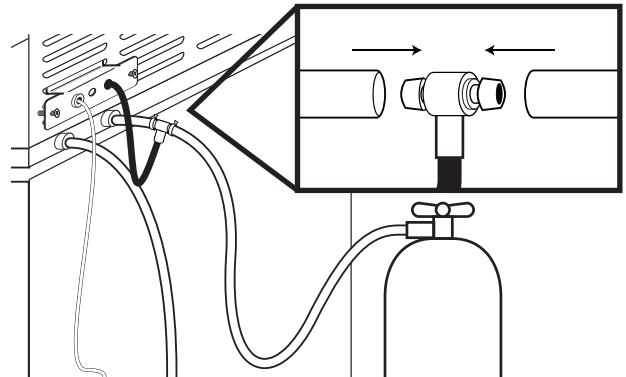

- 21** Open the valve on the CO2 tank and check for any leaks in the connections.

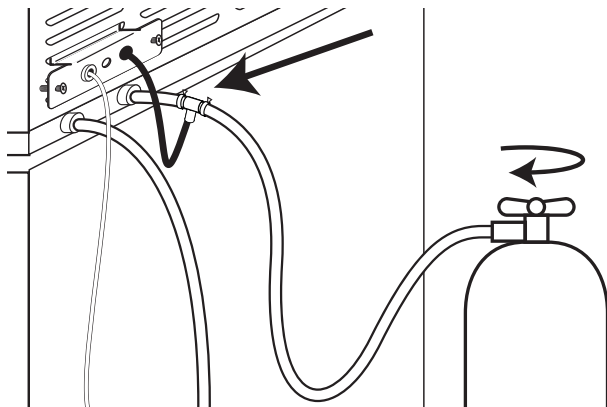

- 22** Return the side panel to the freezer.

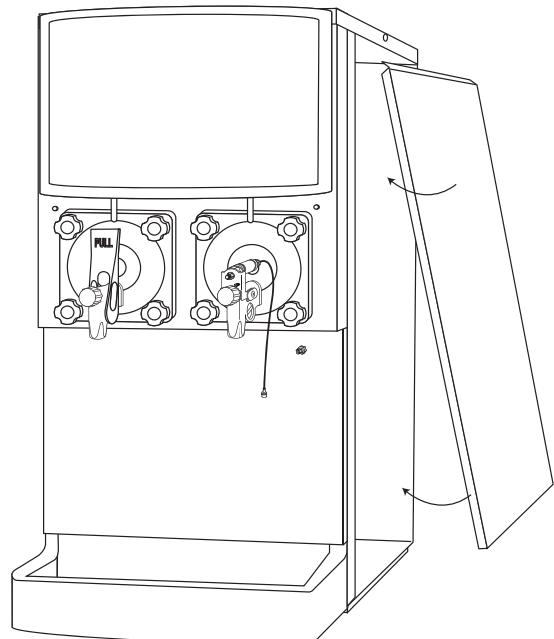

- 23** Remove the screws from the back plate on the Touchscreen.

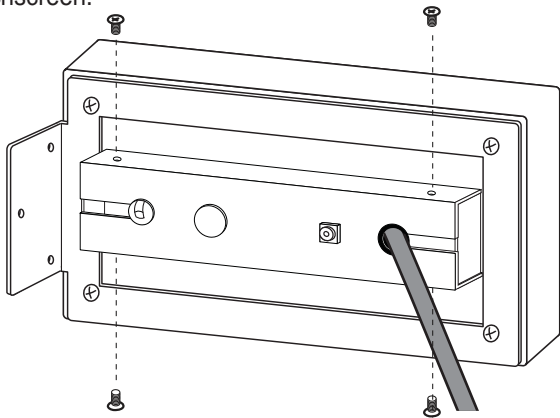

- 24** Carefully pull the plate away from the connections, without disconnecting any wires inside.

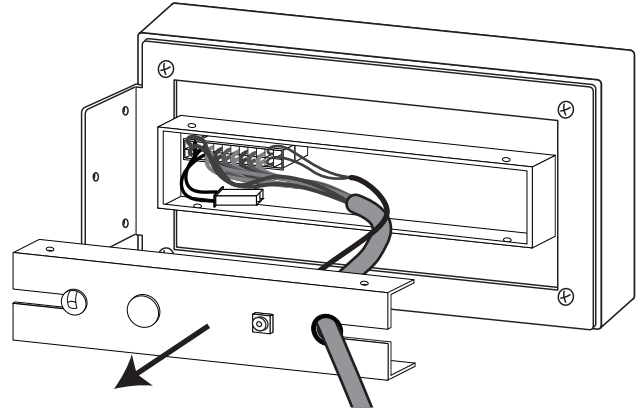

- 25** Remove the strain relief clamp from the slotted hole in the bracket plate.

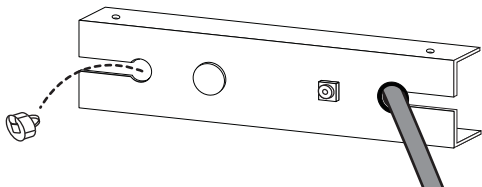

- 26** Insert the rotor cable from the mounting plate assembly through the slotted hole of the Touchscreen bracket plate.

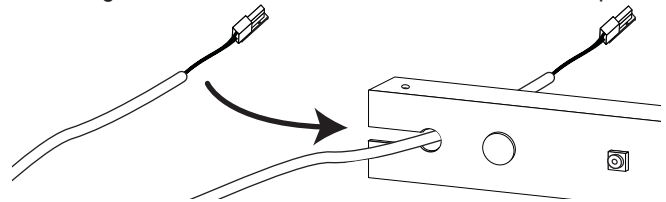

- 27** Locate the loose, unconnected cable inside the Touchscreen housing and connect it to the rotor cable.

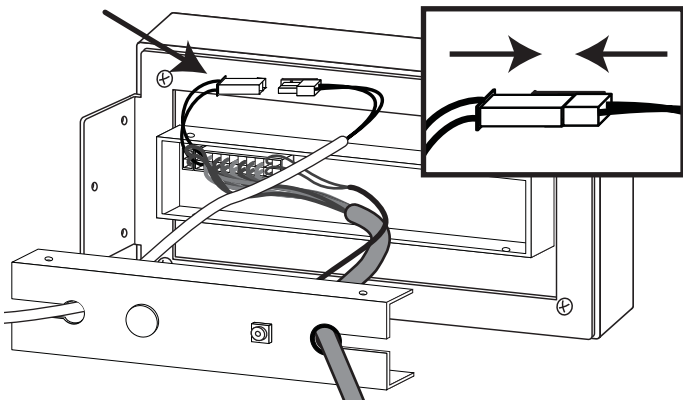

- 28** Reinstall the plate back onto the Touchscreen, securing it with the screws.

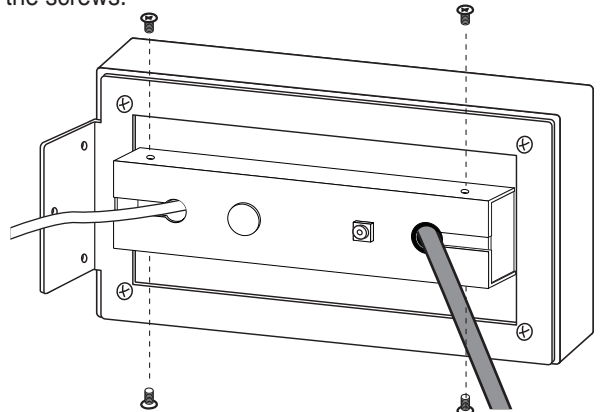

- 29** Gently pull any excess rotor cable through the hole. Snap the strain relief around the cable near the bracket plate.

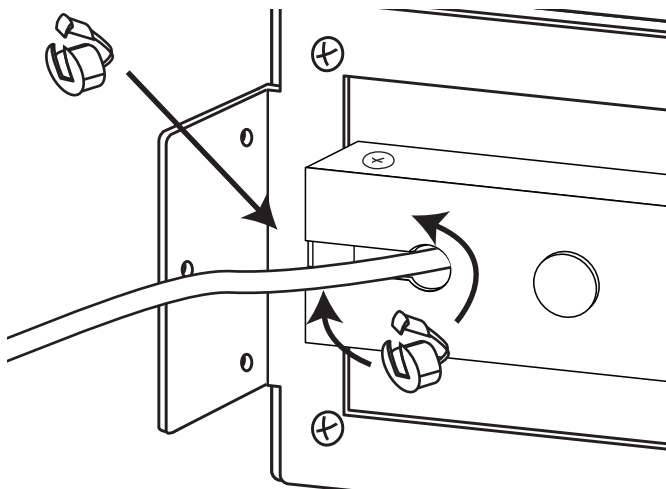

- 30** Insert the strain relief into the slotted hole to complete the rotor cable installation.

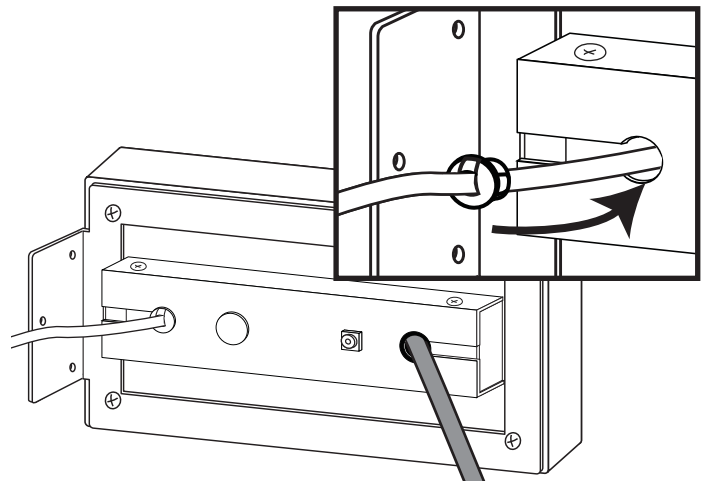

- 31** Loosen the two bottom hand knobs slightly on the door. Install the Draw Switch Housing over the Cylinder Assembly on the draw spout. Tighten the hand knobs to secure.

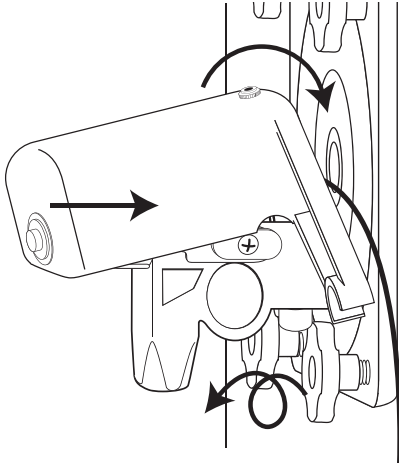

- 32** Insert the 9-Tube Assembly into the syrup port on the modified draw spout. Rotate the 9-Tube Assembly until motion stops to secure.

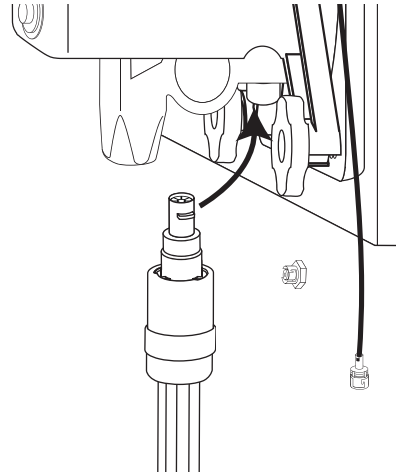

- 33** Connect the Cylinder Assembly line to the panel mount connector. Plug the switch extension into the stereo jack on the top of the housing assembly.

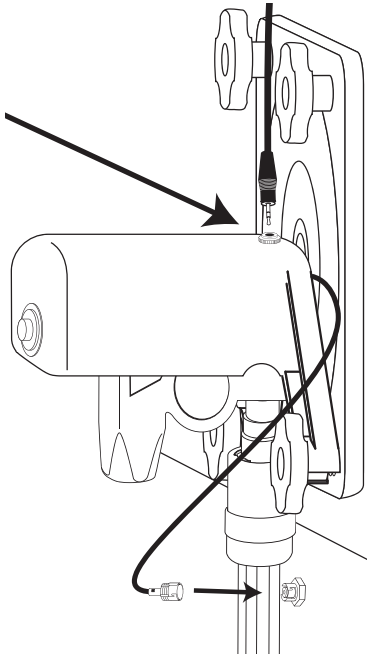

- 34** Reinstall the Touchscreen with Mounting Bracket and the Tube / Cable Casing. Fill the freezer hopper with FCB product so that it can freeze down during the rest of the Flavor Burst setup.

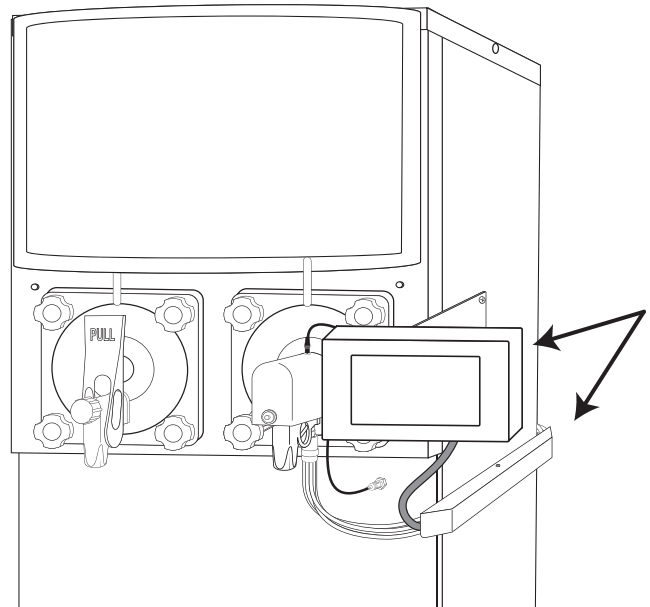

- 35** From the Touchscreen main menu, press the SETUP key in the upper left corner and enter the password if prompted (3141). If the SETUP key is not visible, press the top left corner anyway as it may be hidden if the self-serve mode is enabled.

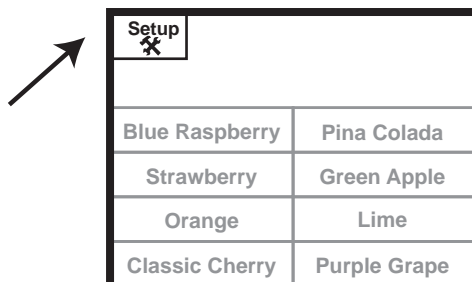

- 36** Press the MAINTENANCE key.

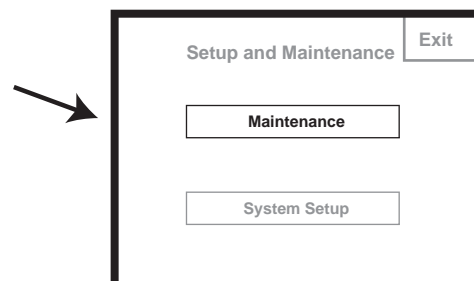

- 37** Press the SETUP OPTIONS key.

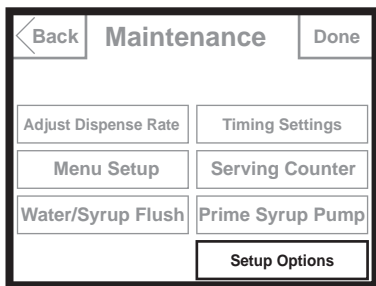

- 38** Ensure the "Enable FCB Purge" box is checked. If it is not checked, press on the box to check it. Also, ensure NONE of the other boxes are checked. Press to deselect any other checked boxes. Then press BACK.

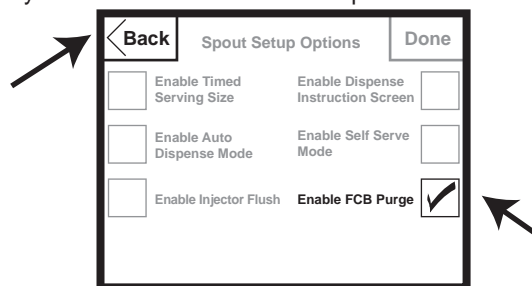

- 39** Press the PRIME SYRUP PUMP key.

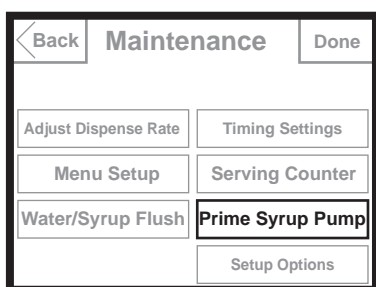

- 40** In the Prime Syrup Pump mode, press the first flavor key to prime the syrup line. The syrup flow will shut off automatically after 15 minutes. To cease flow earlier, press the flavor key again. Do this for all 8 flavors and then press DONE.

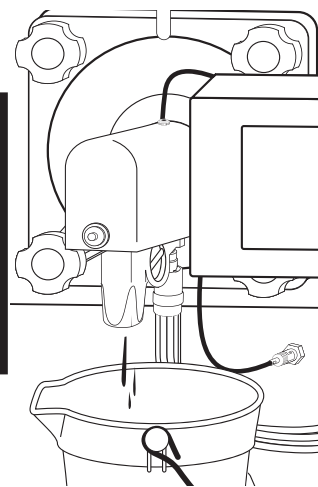
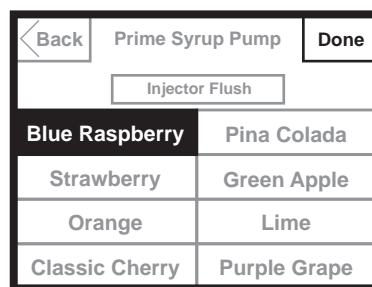

- 41** When the FCB product has frozen down, place a container under the spout. Draw a serving by selecting one or more flavors from the Touchscreen and press and hold the button to dispense. When the cup is nearly full, release the button. FCB product will continue to flow for a moment to clear the flavor from the spout to reduce flavor carryover to the next serving. Test out all 8 flavors to ensure everything is working properly.

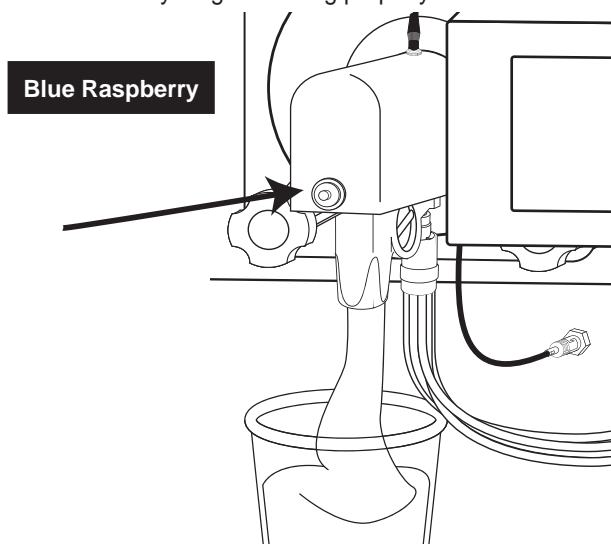

- 42** To adjust the product flow rate, remove the Housing from the Cylinder Assembly. Tighten the flow rate screw (clockwise) to decrease the product flow and increase flavor output. Loosen the screw (counter-clockwise) to increase the product flow and decrease flavor output. Return the Housing to the assembly.

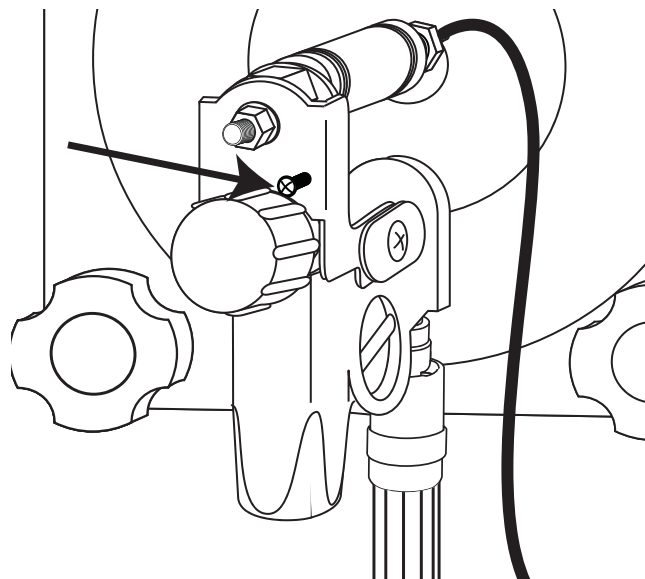

ADD THE
FOLLOWING PAGES
TO YOUR
OPERATIONS
MANUAL IN THE
“TOUCHSCREEN
OPERATIONS”
SECTION.

AUTO DRAW VALVE OPERATIONS MANUAL SUPPLEMENT

NOTE: BE SURE TO PLACE A CONTAINER UNDER THE DOOR SPOUT TO CATCH THE PRODUCT AND SANITIZER SOLUTION.

NOTE: YOUR HANDS SHOULD BE CLEANED AND SANITIZED BEFORE YOU PERFORM THE FOLLOWING PROCEDURE.

NOTE: THE FOLLOWING PROCEDURES REQUIRE APPROVED, SERVICEABLE AND SANITIZED TOOLS AND BRUSHES. CONTACT YOUR LOCAL DISTRIBUTOR FOR RECOMMENDED SUPPLIES.

NOTE: USE AN APPROVED CLEANER AND SANITIZER FOR THE FOLLOWING PROCEDURES. REFER TO MANUFACTURER'S INSTRUCTIONS FOR PROPER PREPARATIONS OF THESE CLEANING AGENTS.

NOTE: INSPECT ALL WEAR ITEMS AND REPLACE IF NECESSARY.

The TS 80FCB system can be set for three different draw modes: standard manual draw mode, timed serving size draw mode, and auto dispense draw mode. The auto dispense draw mode can only be used with the FCB Auto Draw Valve system upgrade, and is not functional with the standard TS 80FCB system.

Used in conjunction with the Auto Draw Valve system, this mode allows the operator to use a key on the Touchscreen to dispense product. This replaces the need to use the dispense button on the spout assembly.

Add these instructions to your operations manual with the "Draw Mode Options" section. Instructions for the other two draw modes (standard manual and timed serving size) are already outlined in your operations manual.

Draw Mode Options

The standard manual draw mode dispenses flavors as long as the draw handle is open.

(SEE OPERATIONS MANUAL FOR MORE INFORMATION)

The timed serving size draw mode eliminates the need for topping off the serving. Small, medium, large and extra-large sizes are pre-programmed to stop the flow of flavor after product has dispensed for a specific time.

(SEE OPERATIONS MANUAL FOR MORE INFORMATION)

The auto dispense draw mode is exclusively for Frozen Carbonated Beverage freezers and will not work on a non-FCB freezer. This draw mode also requires a special Flavor Burst Auto Draw Assembly for the freezer, which is available from your local distributor. The auto dispense mode allows the operator to dispense product by touching a key on the Touchscreen itself, without having to use the freezer draw handle.

If your TS 80FCB system has been upgraded with the Auto Draw Valve system, please see the supplemental manual for instructions on enabling and operating the auto dispense draw mode.

Enabling the Auto Dispense Draw Mode

Standard manual draw mode allows the operator to dispense product with flavor for as long as the draw handle is in the open position.

1. From the main menu screen, press the SETUP key in the upper left corner. Enter the password if required.

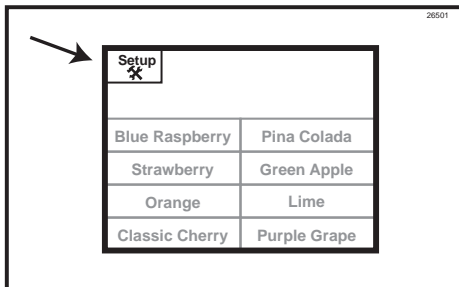

2. Select the MAINTENANCE key.

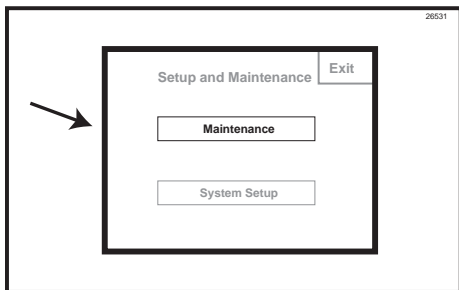

3. Select SETUP OPTIONS.

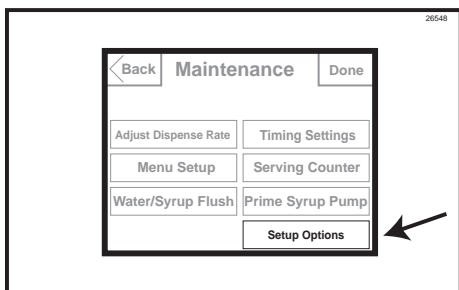

4. Select the ENABLE AUTO DISPENSE MODE box. If there is a check in the box, press the box to remove the selection.

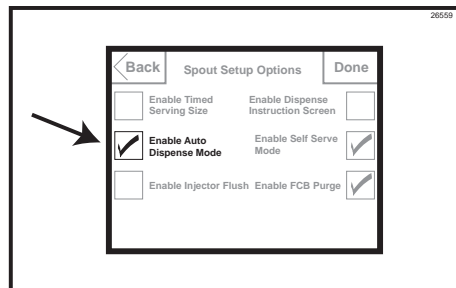

NOTE: IT IS RECOMMENDED THAT “ENABLE SELF SERVE MODE” IS SELECTED FOR USE WITH THE AUTO DISPENSE MODE.

NOTE: DISPENSE INSTRUCTIONS SCREEN HAS NO EFFECT OR PURPOSE WHEN SELECTED FOR USE WITH THE AUTO DISPENSE DRAW MODE. LEAVE THIS BOX UNCHECKED.

NOTE: “ENABLE INJECTOR FLUSH” IS FOR USE WITH STANDARD (NON-FCB) BEVERAGE SYSTEMS AND SOFT SERVE SYSTEMS ONLY. ENSURE THIS BOX IS **UNCHECKED**.

NOTE: TIMED SERVING SIZE IS NOT COMPATIBLE WITH THE AUTO DISPENSE MODE.

5. Press DONE to return to the main screen.



Dispensing Product – Auto Dispense Draw Mode

Standard manual draw mode allows the operator to dispense product with flavors for as long as the draw handle is in the open position. As a result, there is no way to shut off the flavor flow early and there will likely be flavor product left in the Spout which may cause carryover to the next serving if it is not cleared out. Follow these instructions to draw a serving in the standard manual draw mode. Be sure the serving mode is set according to instructions in the “Enabling the Standard Manual Draw Mode” section.

1. The “Make Selections” phrase should now appear above the flavor selections on the main screen, along with the “NEXT” key in the upper right corner. To test the instruction screen, select the flavor(s) and press the NEXT key.

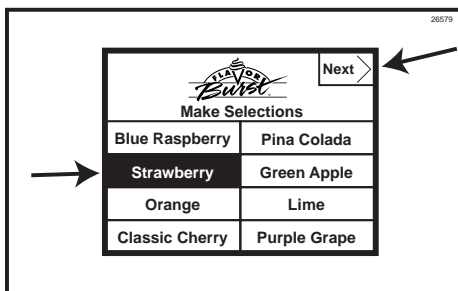

NOTE: THE SETUP KEY IN THE UPPER LEFT CORNER IS PRESENT, ALTHOUGH NOT VISIBLE.

2. The next screen will show instructions on drawing the product and a “SERVE” key in the middle of the screen.

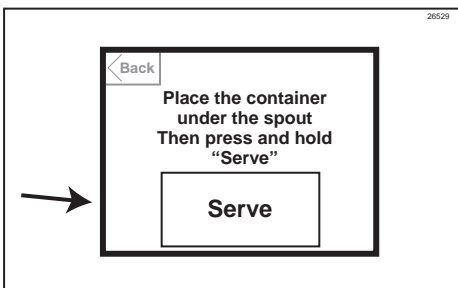

3. With a container under the spout, press and hold the “SERVE” key to dispense product.

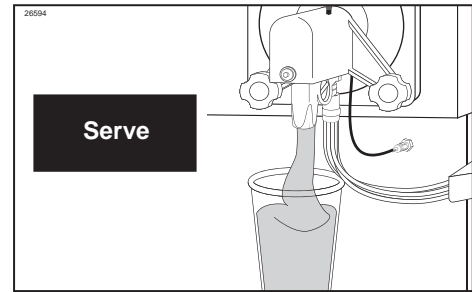

4. When the serving is nearly complete, release the “SERVE” key, but continue to hold the container under the spout to catch dripping product. The auto draw dispense mode is programmed to dispense a small amount of unflavored product at the end of the serving to help clear the spout and reduce carryover.

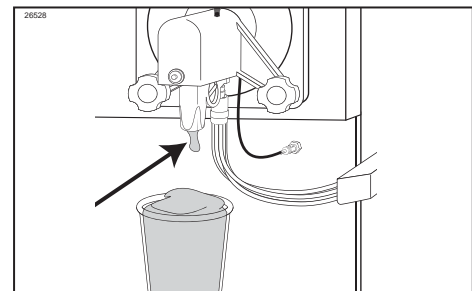

NOTE: WITH THE “FCB PURGE” FEATURE ACTIVATED, A SHORT BURST OF AIR WILL ALSO FOLLOW THE END OF THE SERVING. THIS PUSHES THE REMAINING FLAVORED PRODUCT THROUGH THE SPOUT, HELPING TO CLEAR IT OF RESIDUAL FLAVOR TO REDUCE CARRYOVER ISSUES.

5. If no flavor is desired (i.e. – to draw vanilla), simply deselect any selected flavor entry by pressing it, press the “NEXT” key, and then press and hold the “SERVE” key draw a serving.