

Flavor Burst®

ADPT TY80S-FCB1 FCB Auto Draw Valve Upgrade Kit

Installation

This kit converts the Flavor Burst® FB 80FCB draw-handle operated system to a Flavor Burst® auto draw valve FCB system. When attached to an FCB freezer, this system allows for push-button dispensing without the use of a draw handle. The following instructions are for a field conversion of the freezer. For more information, please contact your local Flavor Burst® distributor.

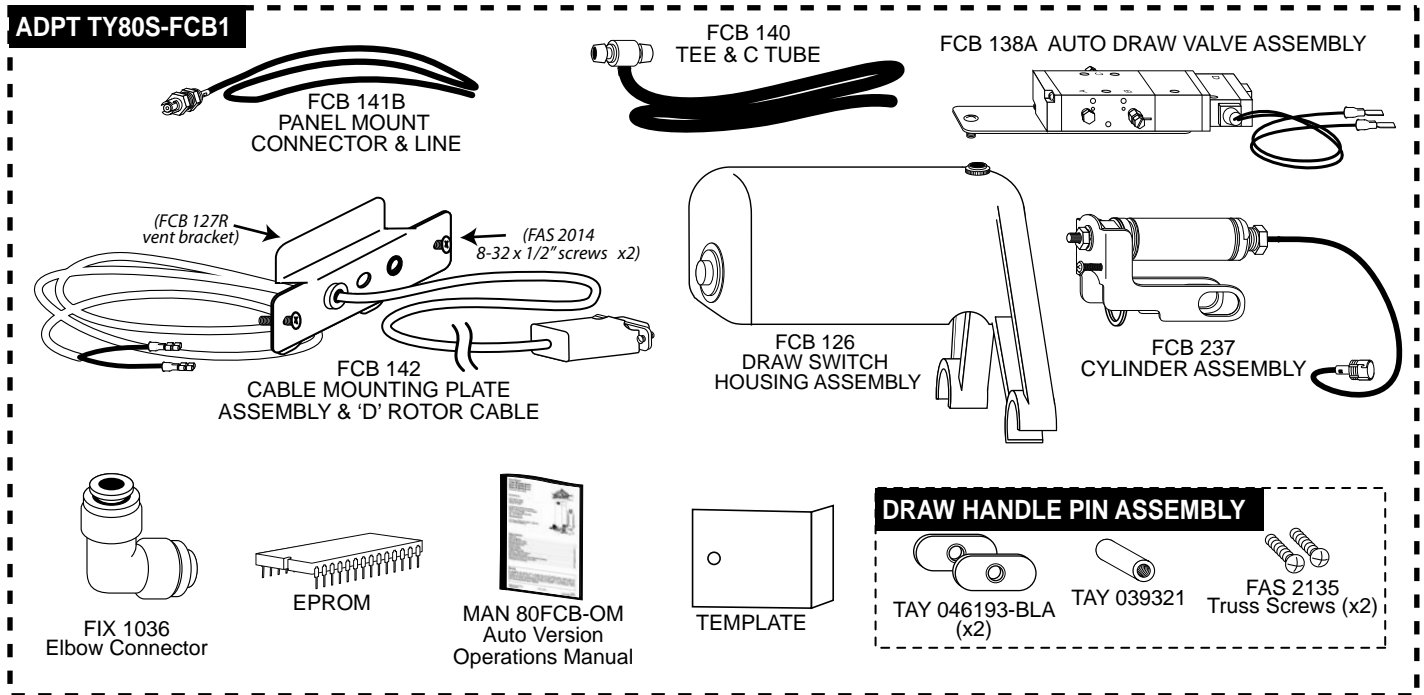

NOTE: THIS KIT IS FOR UPGRADING AN FB 80FCB SYSTEM. USE THE MODIFIED DOOR SPOUT WITH DRAW PIN ASSEMBLY, THE SYR 932FCB-A 9-TUBE ASSEMBLY, AND THE FCB 121 FLOW RATE CONTROLLER FROM THE FB 80FCB SYSTEM WITH THIS KIT AS INSTRUCTED. IF YOU ARE MISSING THESE PARTS OR ANY OF THE REST OF THE FLAVOR BURST SYSTEM (CABINET, SANITIZER TANK, KEYPAD, ETC), CONTACT YOUR LOCAL DISTRIBUTOR FOR THE PROPER FCB KIT.

- 1 Remove the cap, spring, and Flow Rate Controller Assembly from the modified door spout. Set aside the cap and spring.

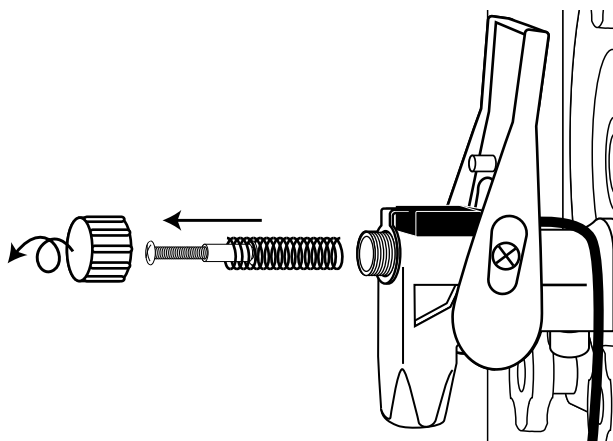

- 2 Remove the draw handle and the draw handle pin assembly from the modified door spout that came with the Flavor Burst FCB system.

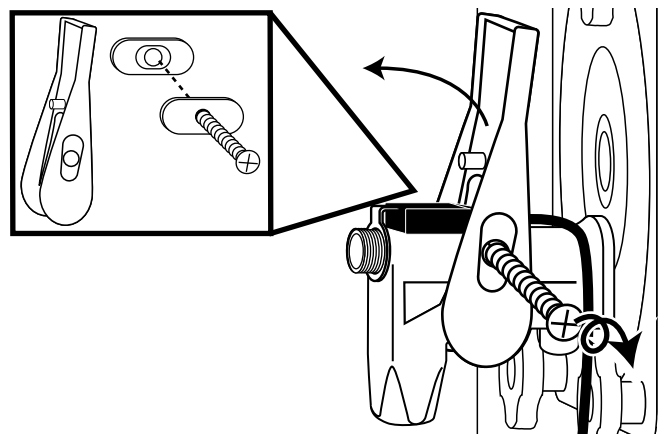

- 3** Disconnect and remove the spigot switch assembly. Ensure the two o-rings are in their respective grooves inside the syrup port.

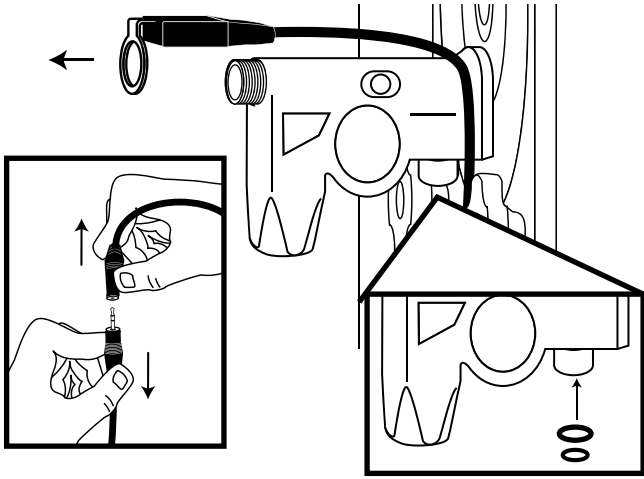

- 4** Install the Cylinder Assembly on the door spout by sliding the bracket over the door spout. Secure it to the spout with the draw handle pin assembly provided.

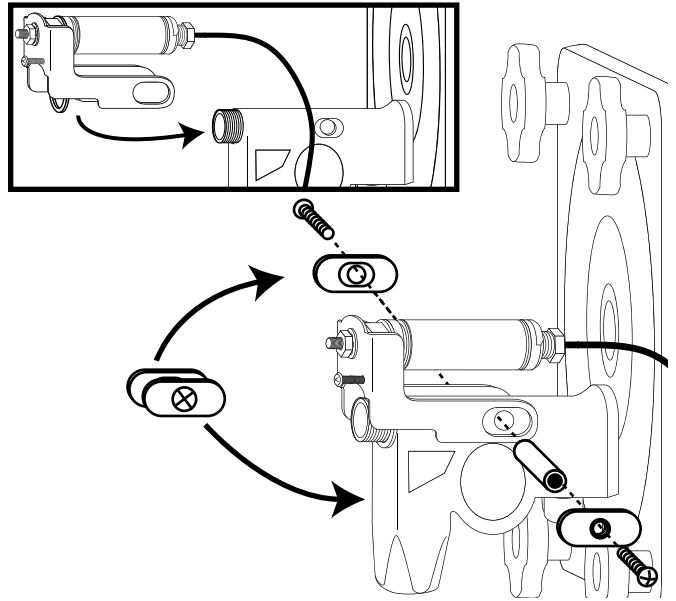

! **NOTE:** SYRUP PORT MAY BE LOCATED EITHER ON THE SIDE OF THE SPOUT ASSEMBLY OR UNDERNEATH, BEHIND THE SPOUT.

- 5** Insert the spring into the draw spout opening and install the cap onto the assembly.

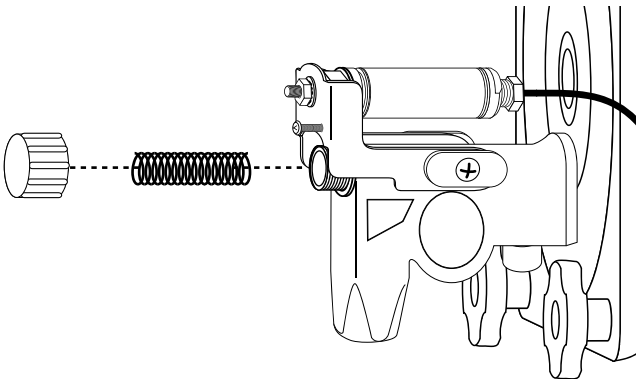

- 6** Place the drilling template on the front service panel under the draw spout so that the folded edge is placed along the service panel edge. Tape the template in place or mark the hole to be drilled in front service panel.

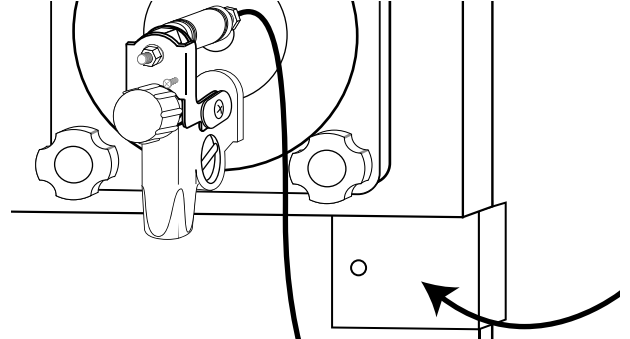

- 7** Remove the panel and drill the 7/16" hole where marked. Deburr the hole if necessary.

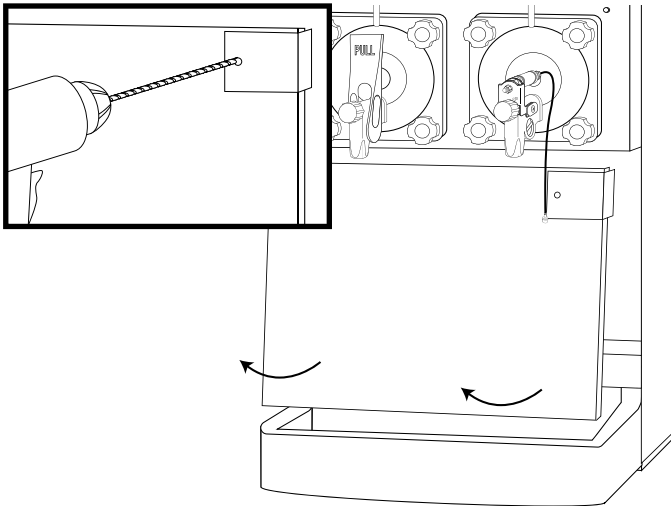

- 8** Install the panel mount connector on the panel, inserting the connector line through the hole. Secure the connector from the inside of the panel with the nut provided.

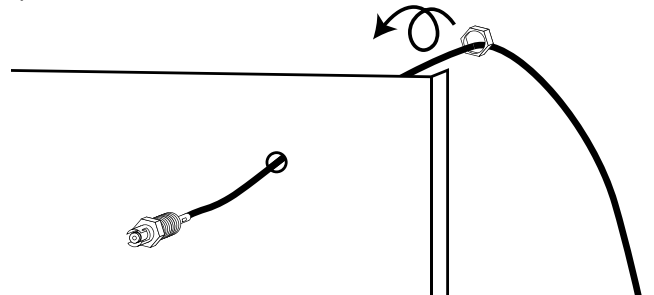

- 9** Reinstall the front service panel with the connector securely in place and tubing to the inside. Ensure the cable falls against the panel and under the support bar so that it does not interfere with any internal freezer parts.

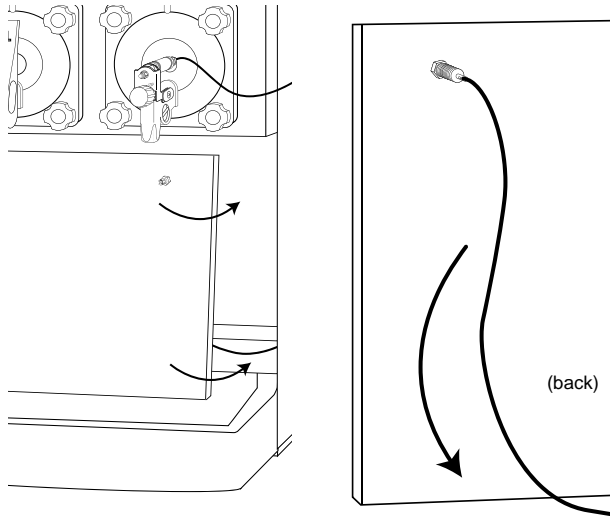

- 10** Remove the side service panel nearest the connection.

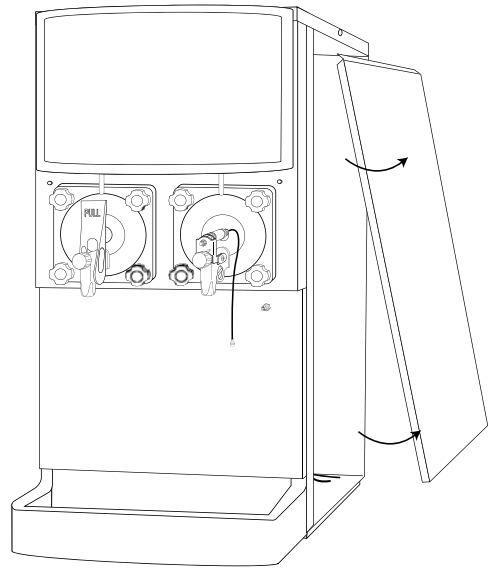

- 11** Install the Valve Assembly inside the freezer cabinet using the screw provided. Mount the base housing to the existing bracket as shown.

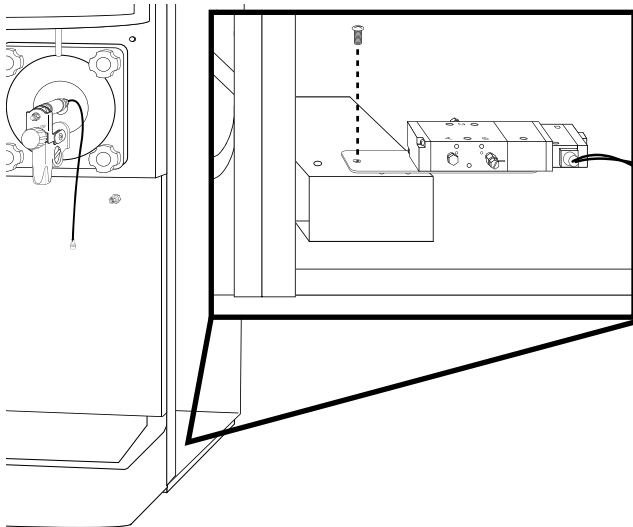

- 12** Connect the air tube to the B port on the valve. Use the tubing sleeves to secure the tube on the barb connection.

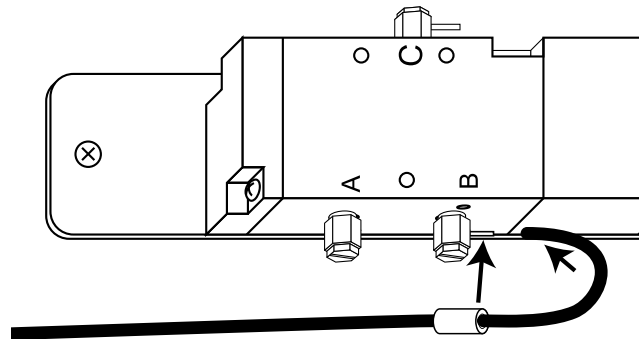

- 13** Install the cable mounting plate assembly on the same side as the Auto Draw Valve Assembly. Slide the spade connector ends of the cables through the 2nd slot from the bottom of the freezer's back vent cover.

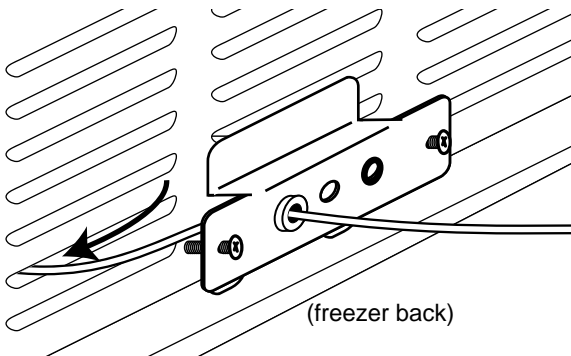

- 14** Angle the upper bracket lip up through the 3rd vent slot from the bottom, so that the lower bracket lip can slide into the bottom vent slot. Slide the bracket down as far as it will go.

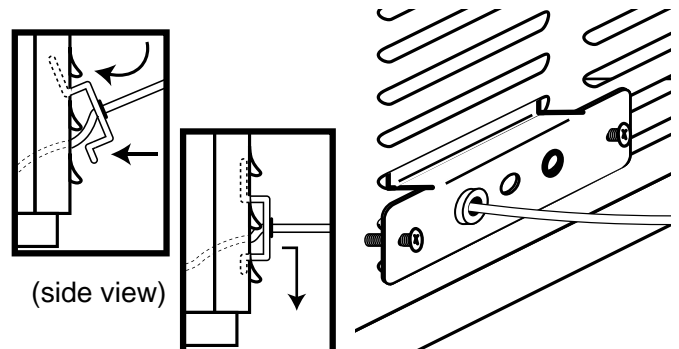

- 15** Slide the bracket down and turn the side screws to brace the assembly against the freezer.

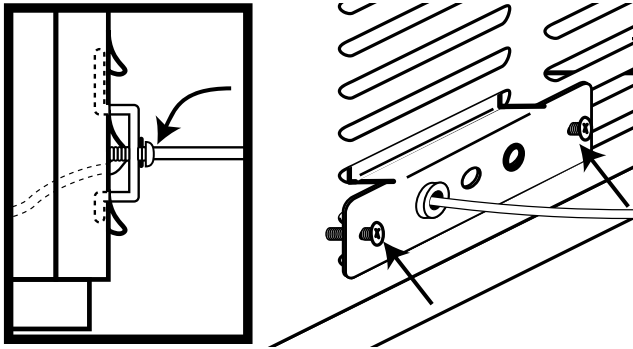

(side view)

- 16** Connect the female spade connectors of the Rotor Cable D to the male connectors on the D Valve.

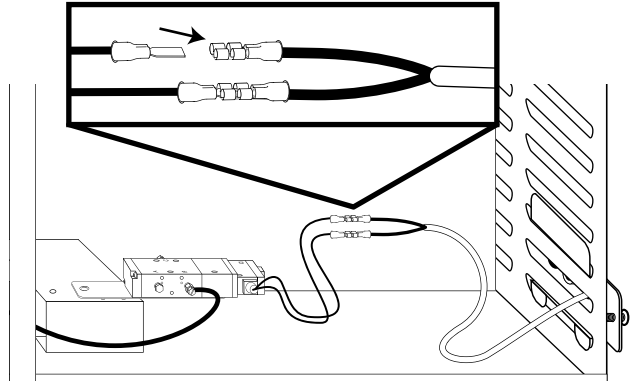

- 17** Insert the C tube through the hole with the black ring on the Cable Mounting Plate Assembly. Connect the tube to the C Valve inside the freezer.

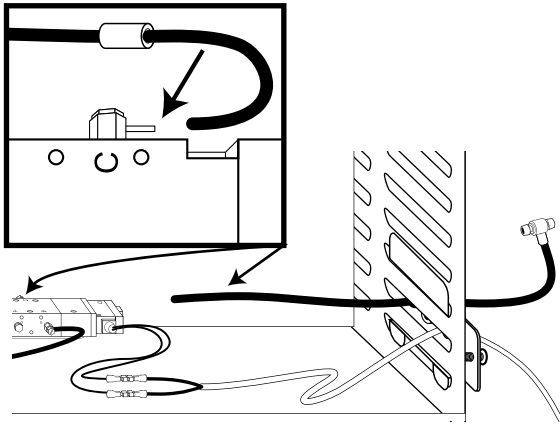

- 18** Ensure the CO2 tank is closed and then cut the supply line about 3" from the rear of the freezer. Install the Tee with the C tube in the CO2 supply line. Use clamps to seal the connections. Open the valve on the CO2 tank and check for any leaks in the connections.

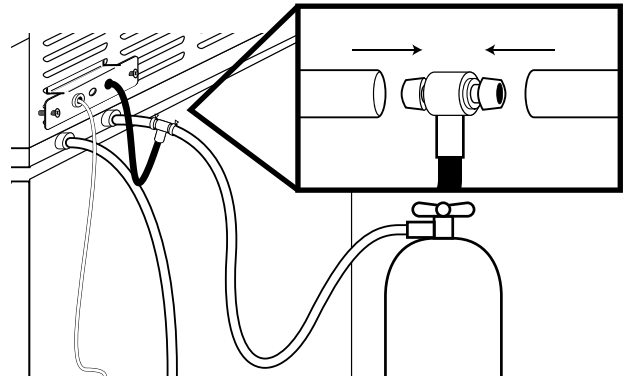

- 19** Connect the Valve Assembly cable to the back of the syrup cabinet.

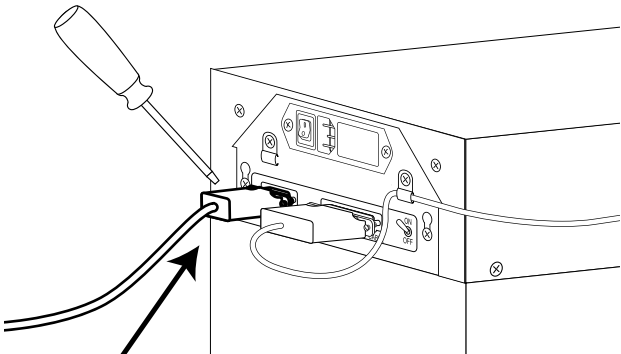

- 20** Return the side panel to the freezer.

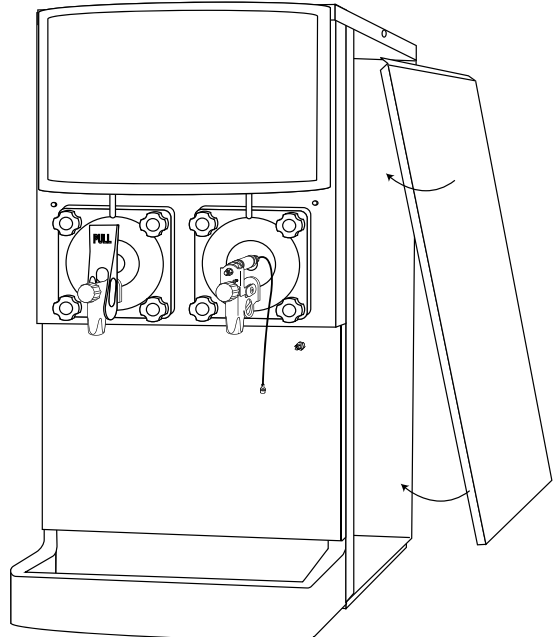

- 21** Loosen the two bottom hand knobs slightly on the door. Install the Draw Switch Housing over the Cylinder Assembly on the draw spout. Tighten the hand knobs to secure.

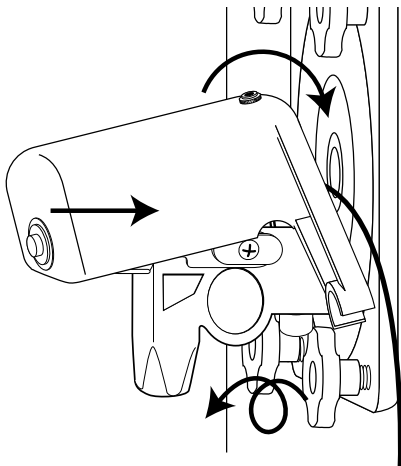

- 22** Connect the Cylinder Assembly line to the panel mount connector. Insert the 9-Tube Assembly into the syrup port on the modified draw spout. Rotate the 9-Tube Assembly until motion stops to secure.

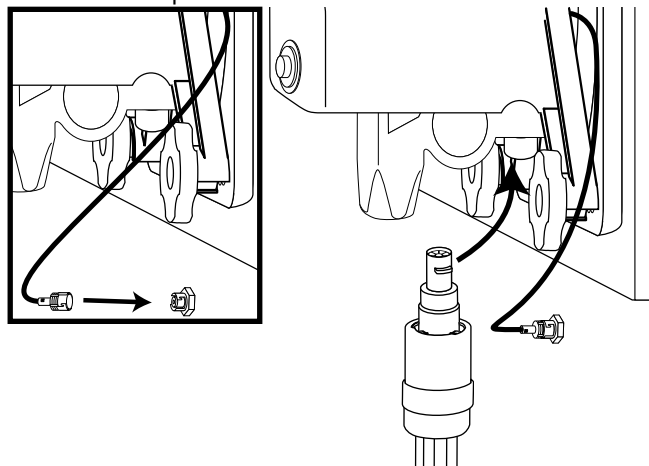

- 23** Plug the keypad stereo plug into the Switch Housing.

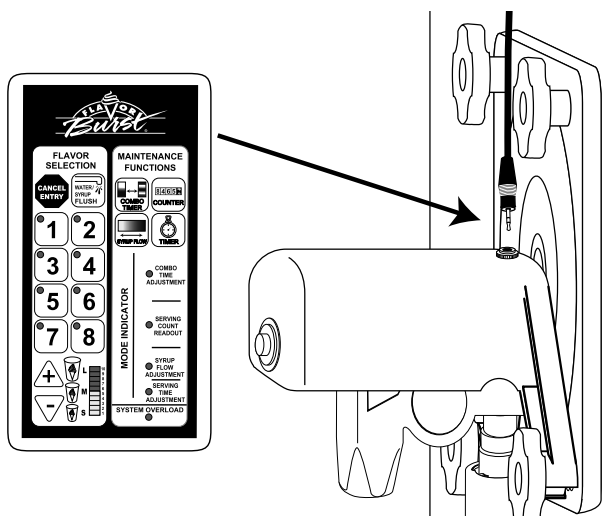

- 24** Remove the cabinet cap and replace the E-prom near the back with the E-prom provided in the kit. Be sure to disconnect and reconnect the Power Supply Cable Harness when removing and installing the cap.

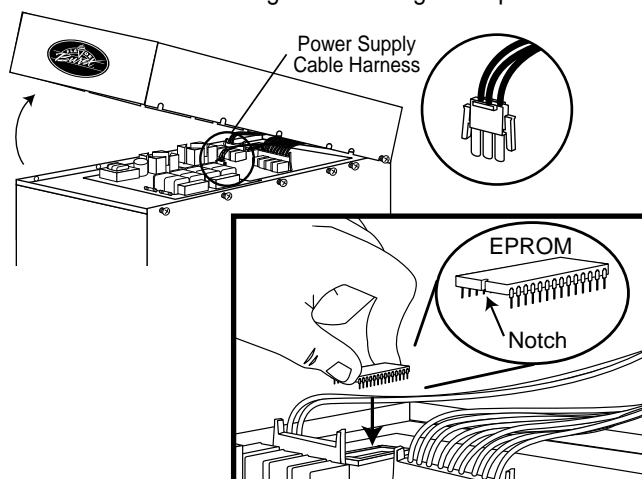

- 25** Remove the back cover of the Flavor Burst cabinet and locate the sanitizer pump near the base.

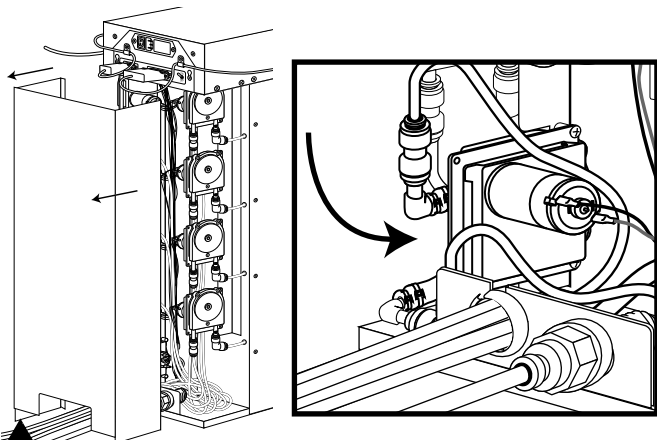

NOTE: ENSURE A HOLE HAS BEEN PRE-DRILLED NEAR THE SANITIZER LINE CONNECTION IN THE BOTTOM PLATE AT THE REAR OF THE CABINET. IF THERE IS NO HOLE, YOU MAY NEED AN ADDITIONAL PUMP KIT INSTALLED. CONTACT YOUR LOCAL DISTRIBUTOR.

- 26** If the tubing hook-ups look like the assembly on the left, proceed to the next step. If the tube hook-ups look like the assembly on the right, skip to Step 29.

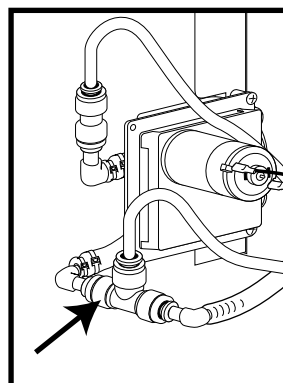

PROCEED TO STEP 27

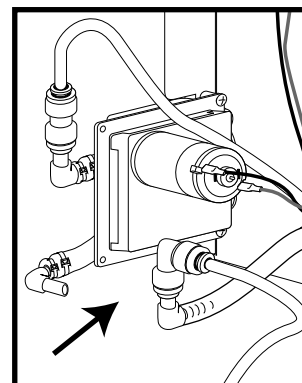

SKIP TO STEP 29

- 27** Disconnect and remove the push-to-connect tee connector from the two elbow connectors and the Pump Flush Tube.

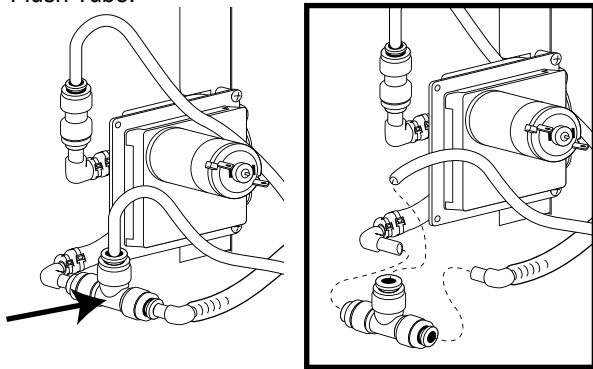

- 28** Install the kit's push-to-connect elbow connector to the Pump Flush Tube and the sanitizer tank tube.

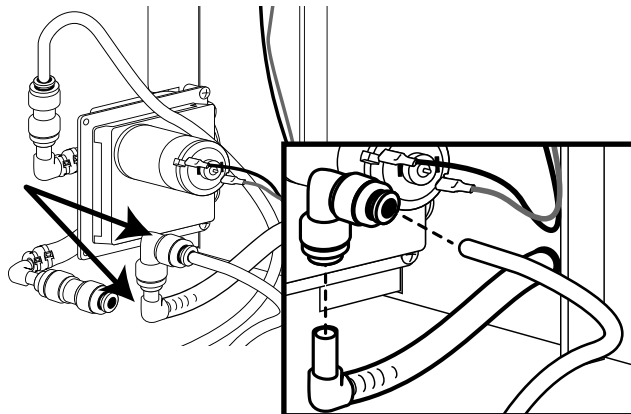

- 29** Install the cabinet cover back onto the Flavor Burst Cabinet.

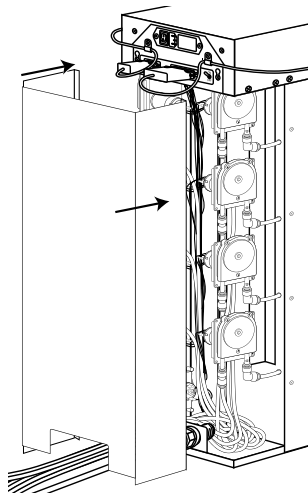

- 30** Fill the freezer hopper with FCB product. While product is freezing down, follow instructions in the Operations Manual to prime the syrup pumps and lines.

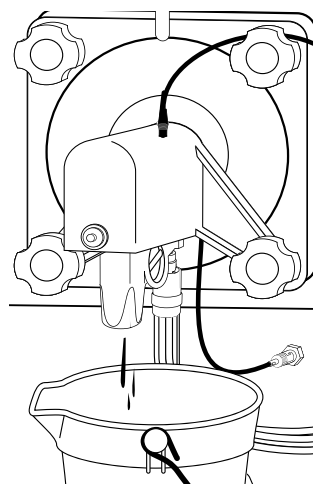

- 31** To clear out the spout and ensure everything is working properly, draw a serving. Place a cup beneath the spout. Select flavor(s) from the keypad. Press and hold button to dispense. When the cup is nearly full, release the button and wait for the freezer to finish dispensing.

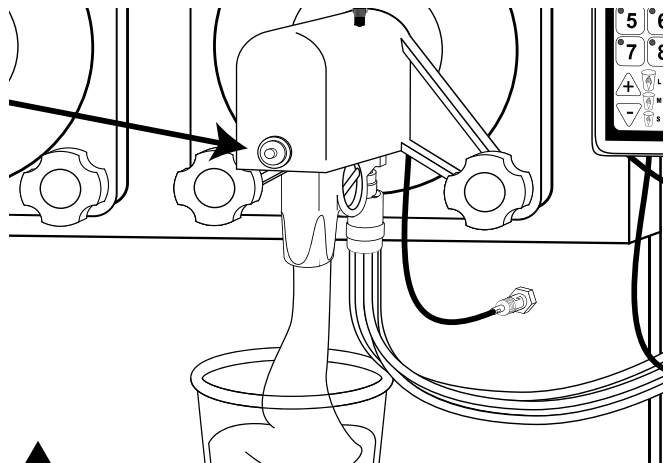

- 32** To adjust syrup flow, remove the Housing from the Cylinder Assembly. Tighten the flow rate screw (clockwise) to decrease the product flow and increase flavor output. Loosen the screw (counter-clockwise) to increase the product flow and decrease flavor output.

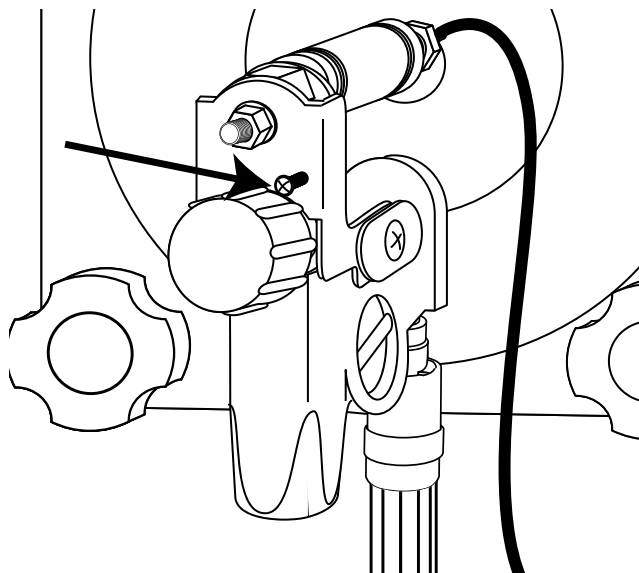

NOTE: PRODUCT WILL DISPENSE APPROXIMATELY 1-2 SECONDS AFTER THE BUTTON IS RELEASED TO CLEAR THE SPOUT OF FLAVORED PRODUCT. THIS PROCESS PURGES THE SPOUT OF LEFTOVER FLAVOR AND REDUCES FLAVOR CARRYOVER TO THE NEXT SERVING.