

# Flavor Burst®

## ADPT TY80S-FCB Adapter Kit for FB 80Sa & FCB Freezers

### Installation

This kit converts the Flavor Burst® FB 80Sa frozen beverage system to a Flavor Burst® FB 80FCB frozen carbonated beverage system. It is designed for use with Taylor® FCB freezer models 345, 346, 349, 355, 356, C300, and C302. The kit includes a modified Taylor FCB Door Spout which allows the Flavor Burst system to be attached to the freezer. The magnetic pin activates the Flavor Burst® system when the pull handle is in open position to draw a serving. For more information, please contact your local Flavor Burst® distributor.

FCB 112 Modified Taylor FCB Door Spout

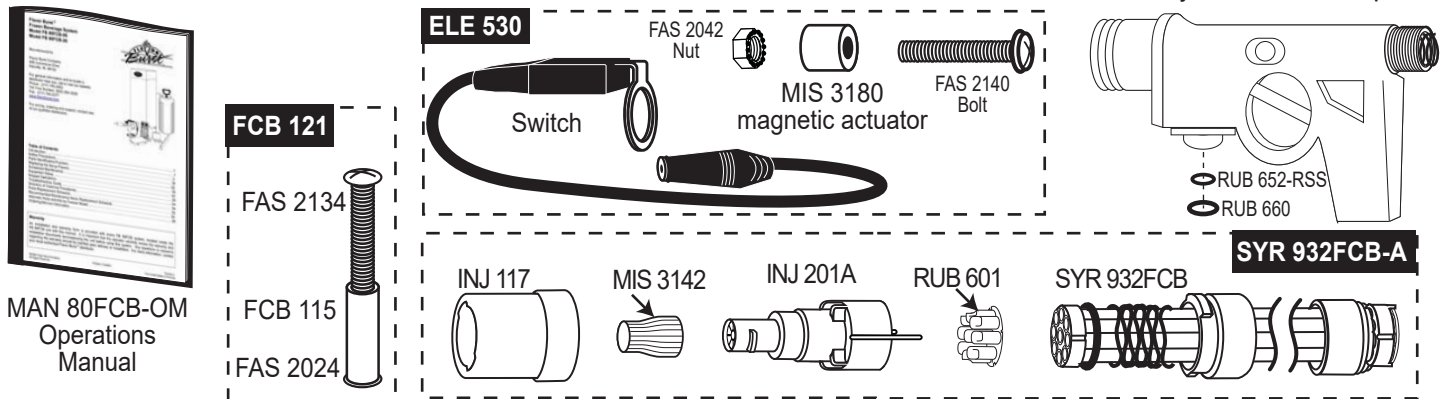

**1** Replace the regular freezer door spout with the modified freezer door spout from the kit. Install the draw handle and end cap from the old spout assembly onto the new spout assembly. Ensure the two o-rings are in their respective grooves inside the syrup port.

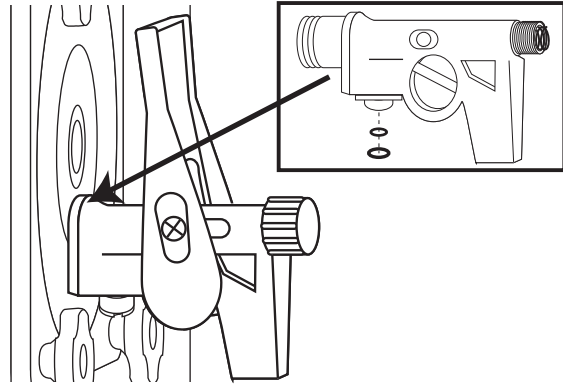

**2** Drill a 1/8" hole through the pull handle. The center of the hole should be 1/4" above the handle arch and centered.

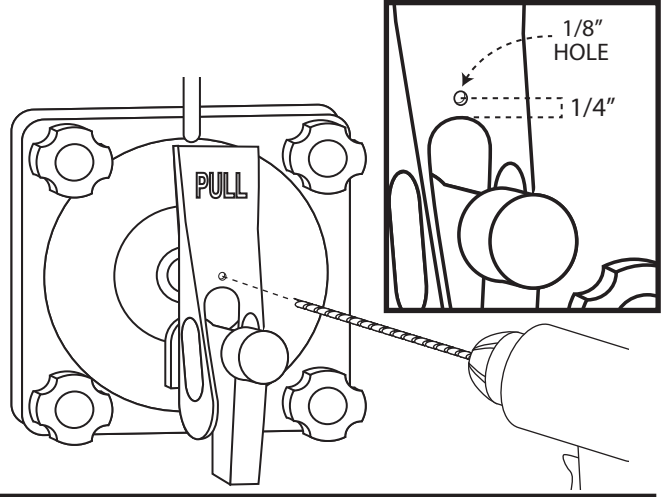

**3** Attach the magnetic actuator to the front of hole using the bolt provided. Secure the assembly at the back with the nut as shown.

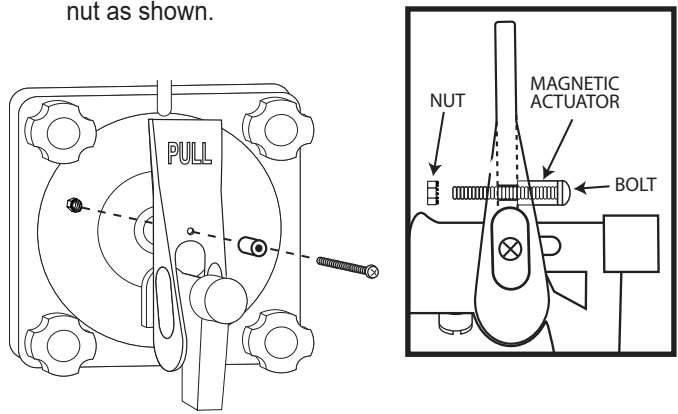

**4** Remove the spout cap and install the switch over the threads.

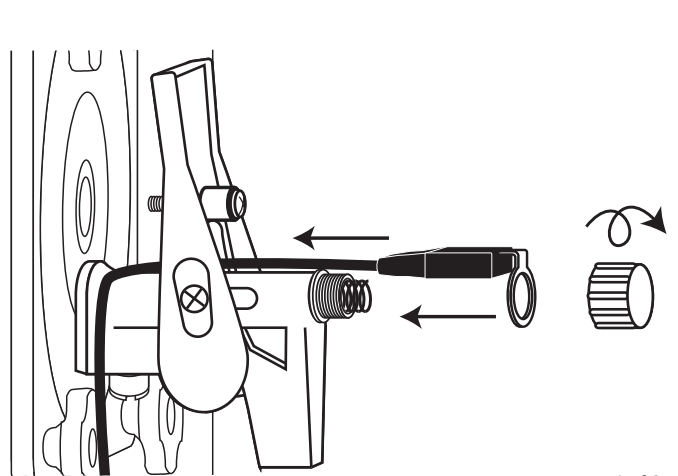

- 5** Insert the Flow Rate Controller inside the spring. Ensure the encased end of the assembly is toward the back of the spout. Return the cap to the door spout.

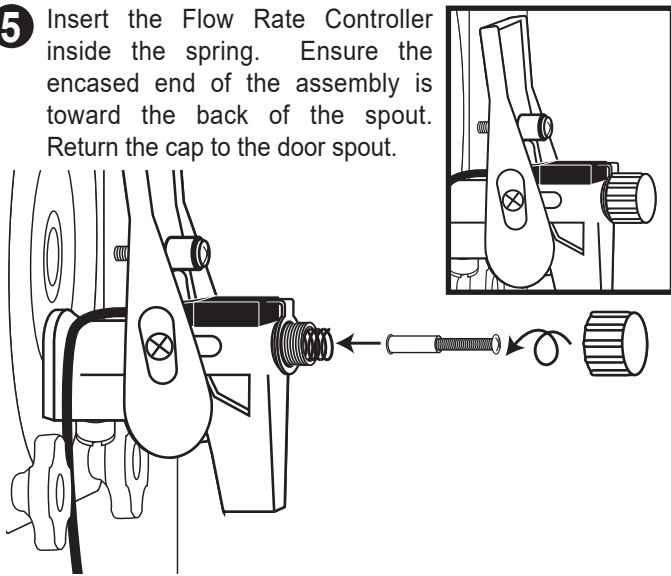

- 6** Connect the keypad to the switch.

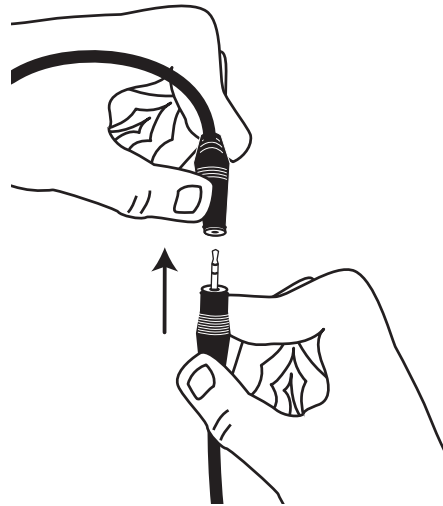

- 7** Remove the cap and insert the FCB 9-Tube Assembly into the syrup port under the freezer head.

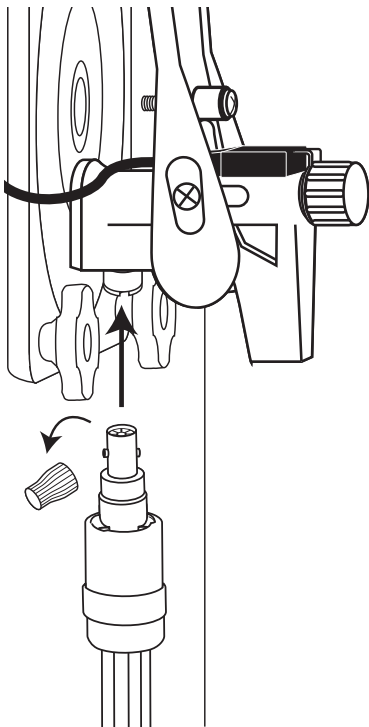

- 8** Draw a serving to determine if the flow rate is satisfactory. The magnetic pin activates the switch when the handle is pulled forward and the pin is brought close to the switch.

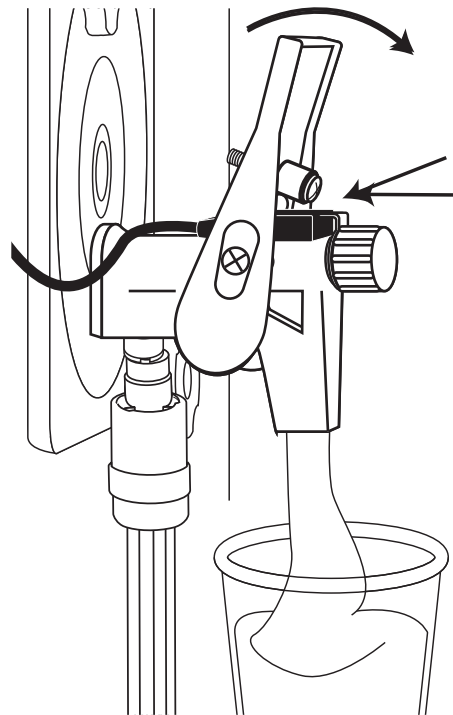

- 9** Adjust the Flow Rate Controller as needed to complete installation. Adjust the screw further into the casing (shorten the assembly) to increase the flow rate. Adjust the screw out from the casing (lengthen the assembly) to decrease the flow rate.

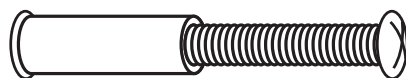

1.95" Pre-set Standard

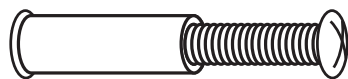

Shorten to Increase Flow

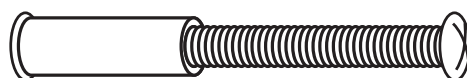

Lengthen to Decrease Flow