

Flavor Burst®

ADPT STL-80A Stoelting® Adapter Kit

Assembly and Installation

The ADPT STL-80A kit is designed for use with Stoelting® freezer models with draw handles that rotate horizontally. Be sure to contact your local Flavor Burst® distributor if you have special needs for adapting to your specific Stoelting® model.

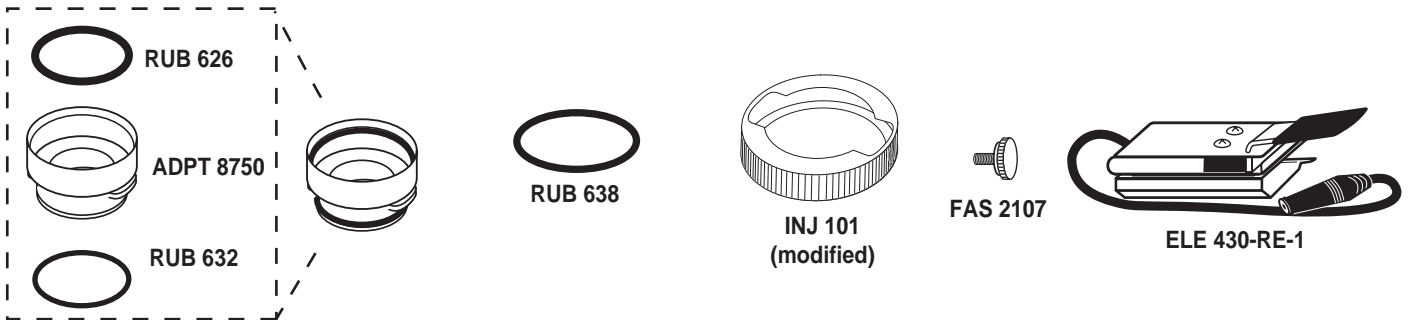

1 Install the RUB 638 o-ring onto the spout.

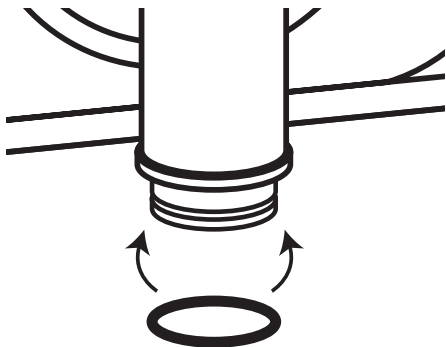

2 Apply food grade lube to the o-ring on the spout and to the adapter o-rings.

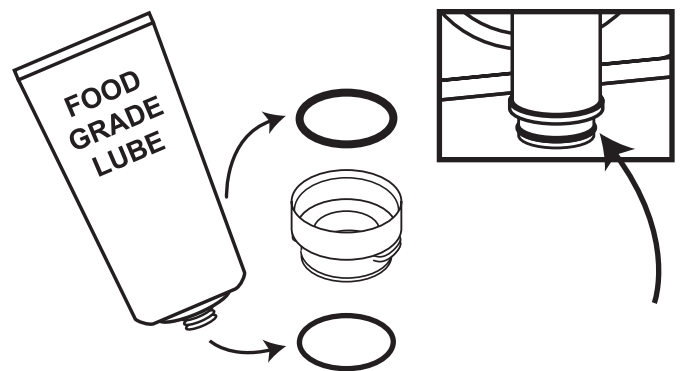

3 Install the RUB 626 o-ring on the inside at the top of the adapter. Install the RUB 632 o-ring on the outside at the bottom of the adapter.

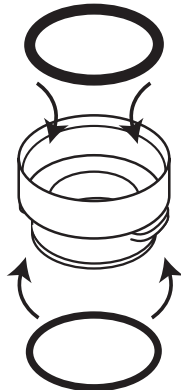

4 Install the adapter onto the freezer spout to complete the installation.

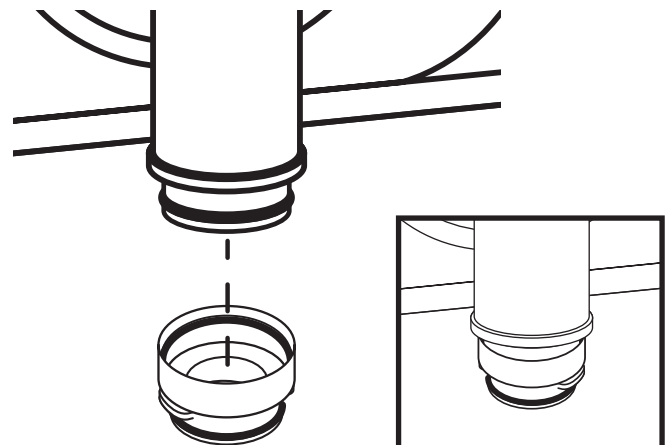

- 5** Wedge a small tool under one end of the inner ring of the Injector Head.

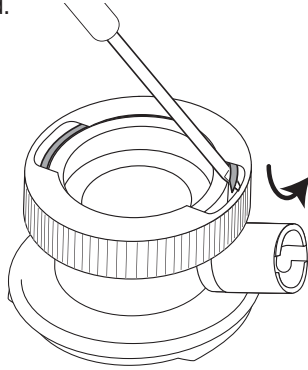

- 6** Rotate the tool around to lift the ring out of the groove and over the top of the inner opening ledge.

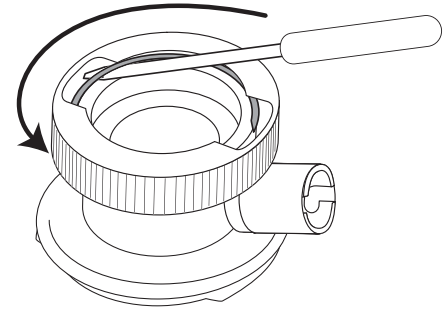

- 7** Remove the Injector Head locking collar from the assembly.

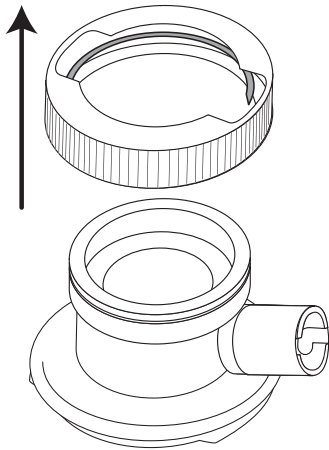

- 8** Remove the inner ring from the locking collar.

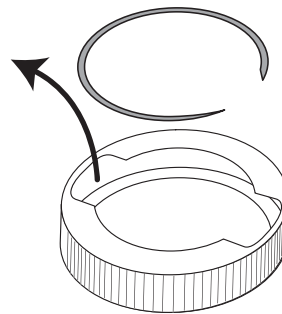

- 9** Place the metal ring inside the new modified locking collar.

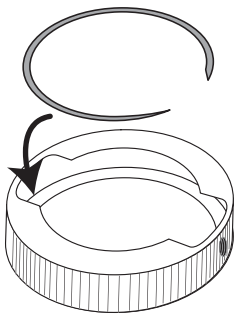

- 10** Place the modified locking collar onto the Injector Head assembly.

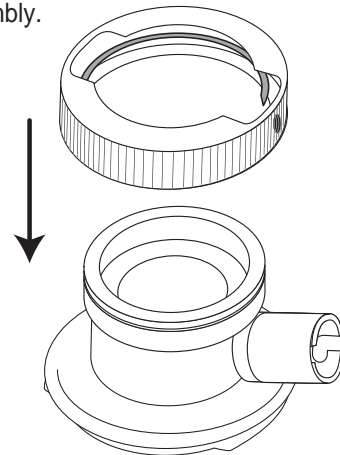

- 11** Use the small tool to push the end of the inner metal ring to the outside of the Injector Head and into the groove.

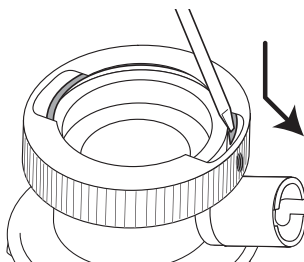

- 12** Work the tool around the Injector Head to pop the entire metal ring into the Injector Head groove.

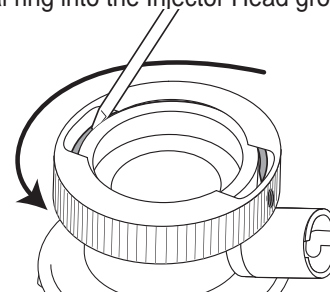

- 13** Assemble the Injector Assembly as instructed in the Operations Manual and install it on the freezer spout.

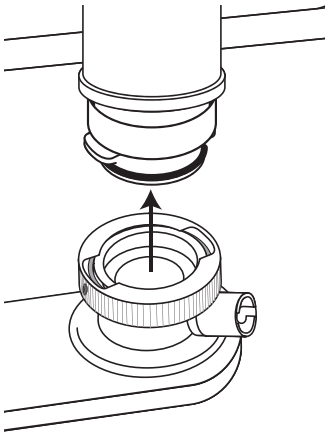

- 14** Rotate the locking collar approximately 90 degrees (one-quarter turn) around the adapter tabs.

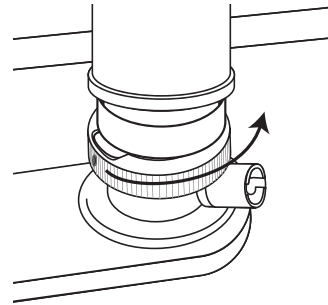

- 15** Install the locking collar thumb screw into the locking collar and tighten till the locking collar is no longer mobile.

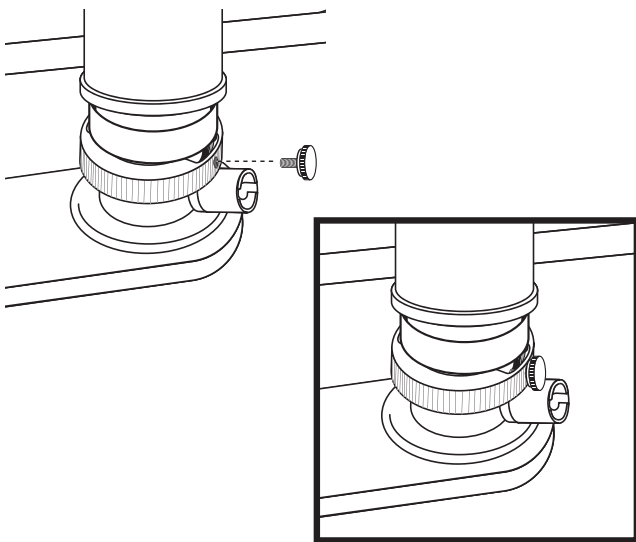

- 16** Slide the Switch Assembly onto the draw-handle bar.

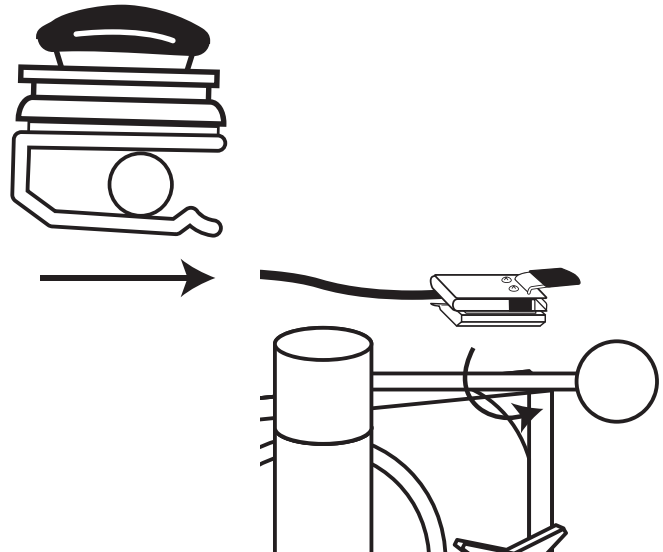

- 17** Turn the switch to the side and position it up towards the end of the draw-handle bar.

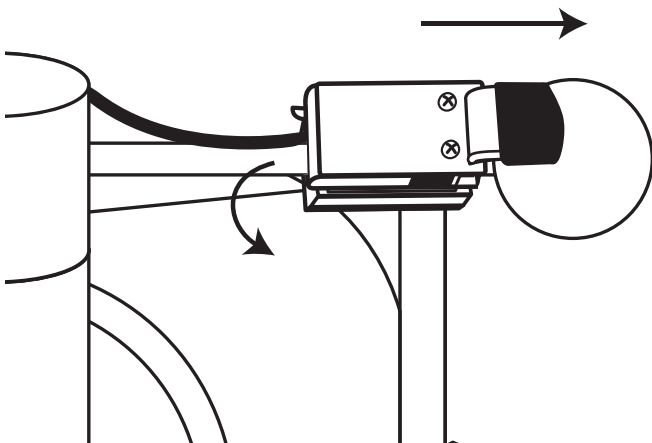

- 18** Be sure to fully engage the Spigot Switch jack to the keypad jack for normal operation. Do not neglect to check this connection during daily startup.

