

Flavor Burst™

ADPT SS 2K1 400 Series SaniServ Kit

Assembly and Installation

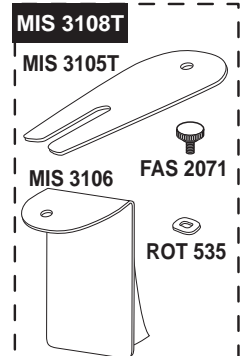
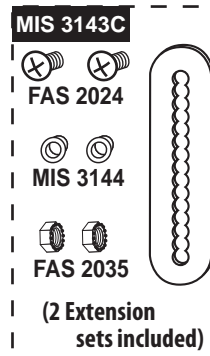
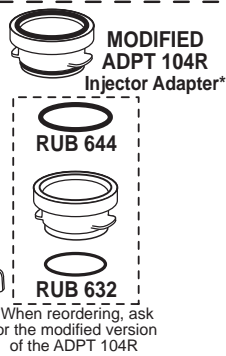
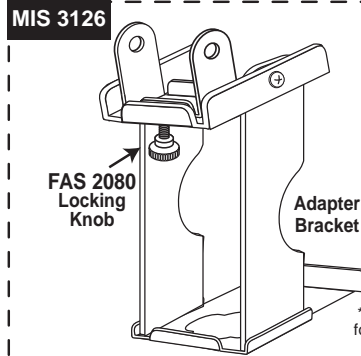
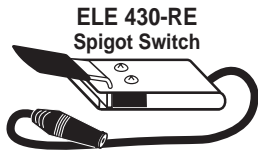

NOTE: USE THE MIS 3133 RETAINING CLIP WITH THE ELE 430-RE SPIGOT SWITCH IF YOUR FREEZER'S HANDLE IS ROUND; USE THE MIS 3132 IF THE HANDLE IS FLAT.

- 1 Install the Adapter inside the Bracket opening and ensure the Locking Knob is loose.

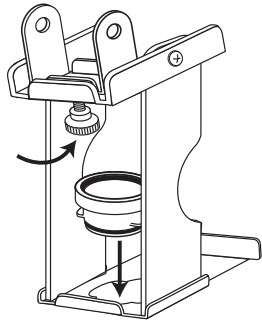

- 2 Remove the locking pin and the draw-handle from the freezer door.

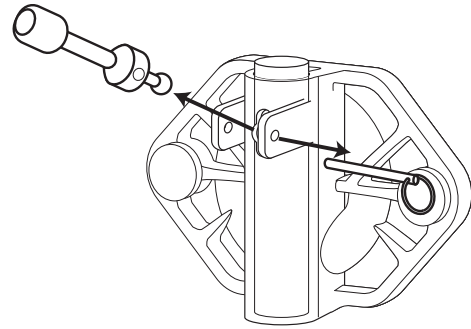

- 3 Attach the Bracket Assembly to the freezer door by aligning the Adapter to the spout opening and wrapping the bottom bracket plate around the backside of the freezer door.

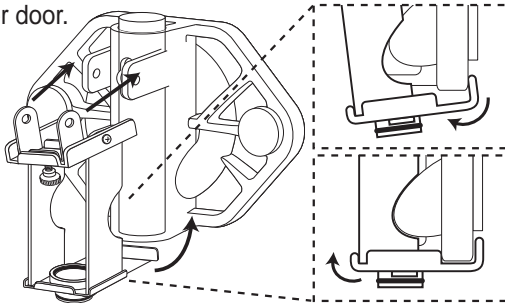

- 4 Align the bracket locking pin holes with the ones on the freezer spout.

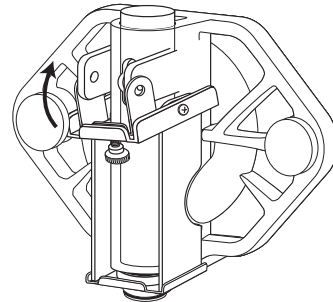

- 5 Replace the draw-handle to the freezer door and secure the handle and the bracket assembly with the locking pin.

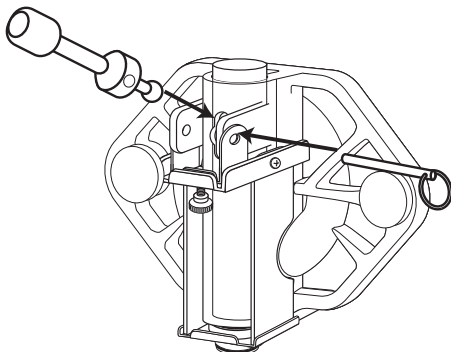

- 6 Secure the Bracket Assembly to the freezer door by tightening the Locking Knob to complete the assembly.

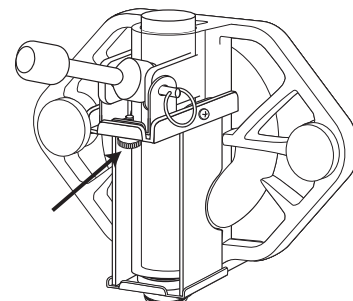

- 7** To install the Spigot Switch, remove the protective backing from the MIS 3133 Retaining Clip.

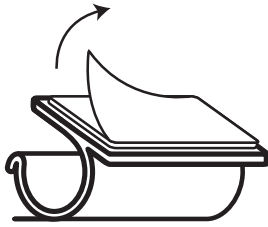

- 8** Attach the Retaining Clip to the underside of the ELE 430-RE Spigot Switch.

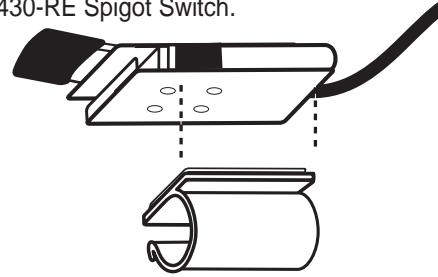

- 9** Rotate the Switch onto the draw-handle rod to complete

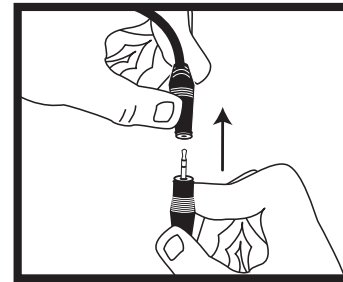
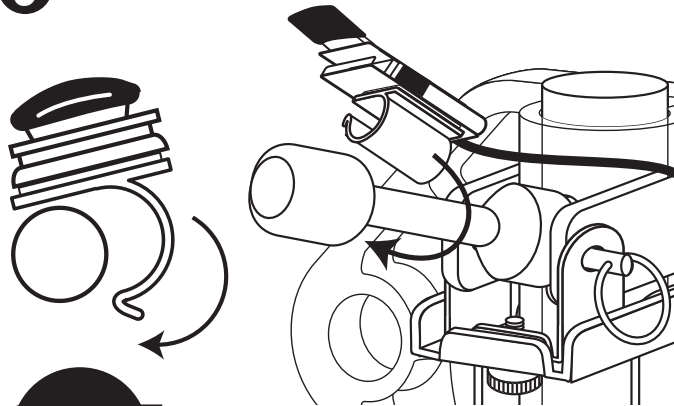

NOTE: BE SURE TO FULLY ENGAGE SPIGOT SWITCH JACK TO THE FLAVOR BURST™ KEYPAD JACK FOR NORMAL OPERATION. DO NOT NEGLECT TO CHECK CONNECTION DURING DAILY STARTUP.

OPT

OPTIONAL: Use the MIS 3132 Retaining Clip with the ELE 430-RE Spigot Switch if your freezer has a flat, not round, handle.

- 10** Remove the protective backing from the MIS 3132 Retaining Clip.

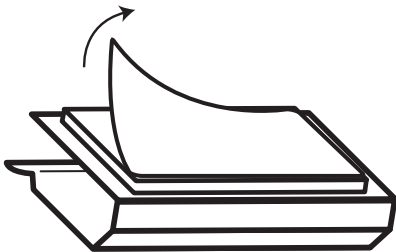

- 11** Attach the Retaining Clip to the underside of the ELE 430-RE Spigot Switch.

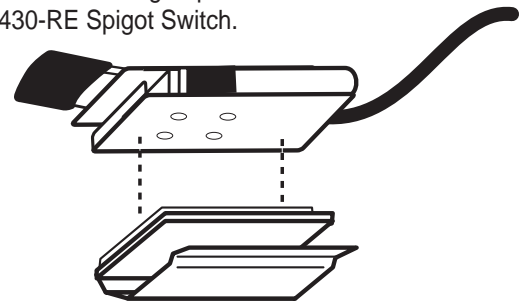

- 12** Slide the Switch Assembly onto the draw-handle bar.

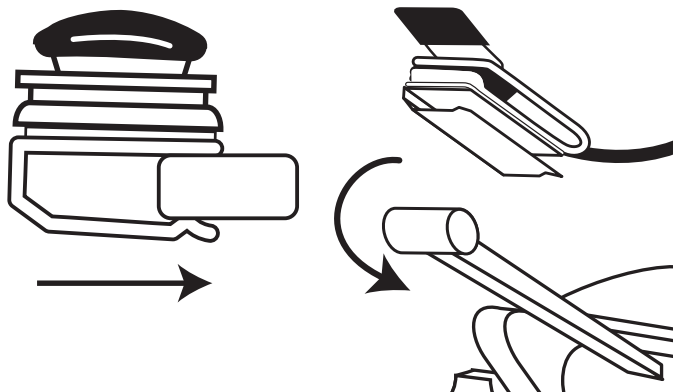

- 13** Position the Switch up towards the end of the draw-handle bar to complete the Installation.



NOTE: BE SURE TO FULLY ENGAGE SPIGOT SWITCH JACK TO THE FLAVOR BURST™ KEYPAD JACK FOR NORMAL OPERATION. DO NOT NEGLECT TO CHECK CONNECTION DURING DAILY STARTUP.

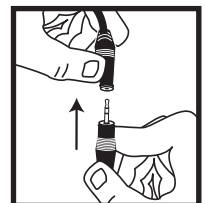

A MIS 3143C SUSPENSION BRACKET EXTENSION

This kit comes with two options for an Injector Mounting Bracket due to freezer model variations. When possible, use the suspension bracket included with your unit and the extensions provided. If the suspension bracket is not suitable for your freezer, install the MIS 3108T mounting bracket in section B.

- 14** If your Injector Assembly has a Suspension Bracket, reassemble the bracket using the extension bracket and fasteners as shown.

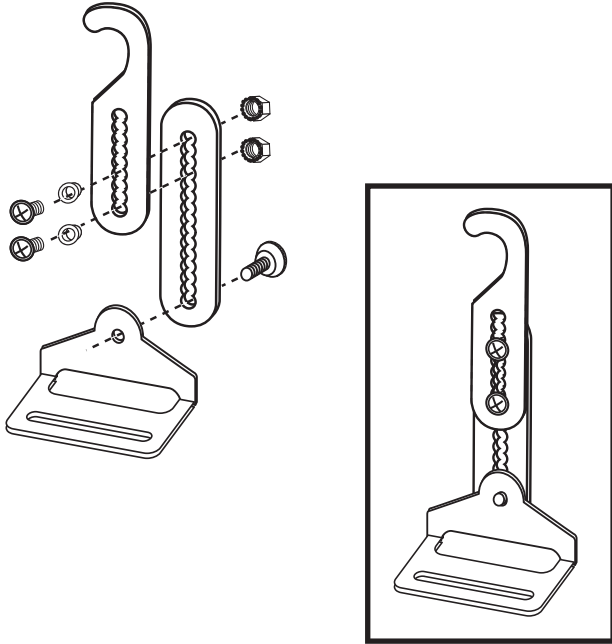

NOTE: IF MORE HEIGHT IS NEEDED, USE BOTH OF THE EXTENSION BRACKET KITS WITH THE SUSPENSION BRACKET.

- 16** Hang the Suspension Bracket Assembly on the hand knob of the freezer nearest the Injector Assembly. Position the Bracket so that the bottom plate is underneath the Injector Assembly and the threaded post slides through the bracket plate slot.

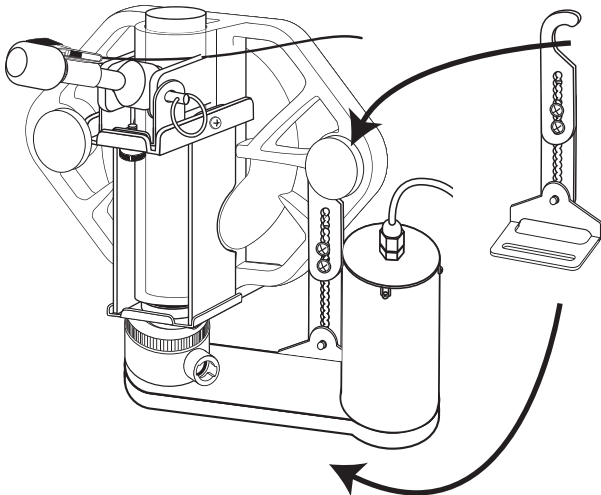

- 15** Attach the Injector Assembly to the spout adapter so that the Injector locking ring covers the adapter tabs. Turn the locking ring 1/4 of a turn to secure.

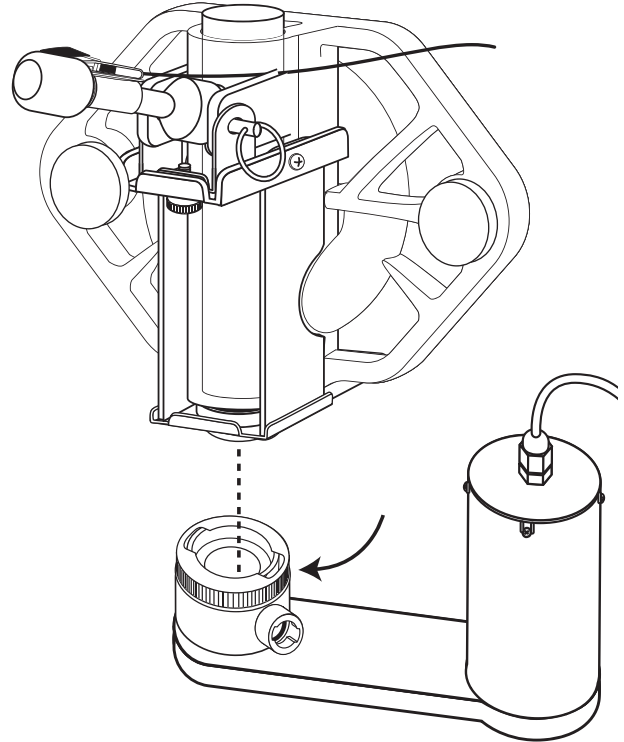

- 17** Using the adjustment screws, lengthen or shorten the bracket so that it supports the Injector Assembly in a level position. Also, install the Gear Box thumb nut onto the threaded post of the Gear Box. Tighten the screws and knob to complete the installation.

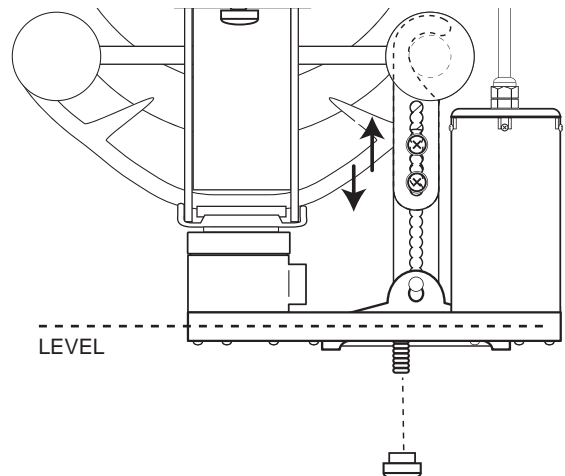

B MIS 3108T MOUNTING BRACKET

- 18** Assemble the Mounting Bracket. Ensure the washer is between the upper plate and the base plate.

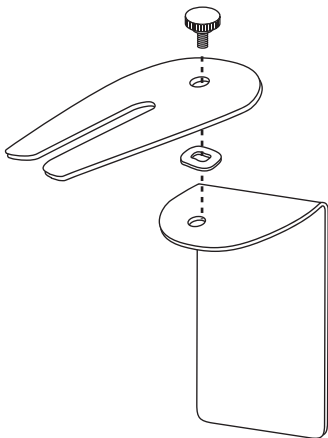

- 19** Attach the assembled MIS 3108T Mounting Bracket to the Injector System and then connect the Injector Head to the Injector Adapter.

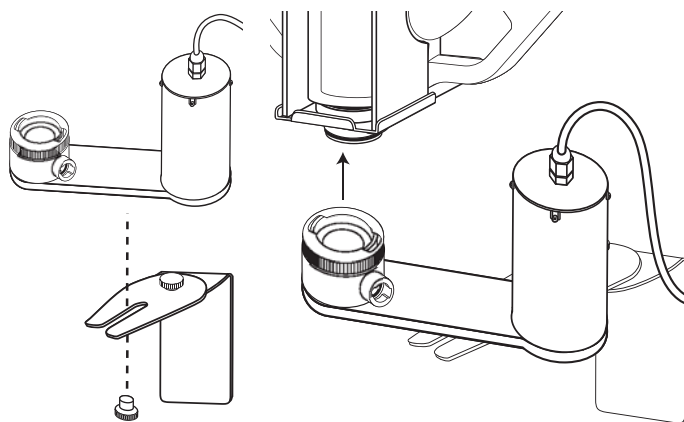

- 20** Position the Injector Assembly and Mounting Bracket so that they are horizontally level.

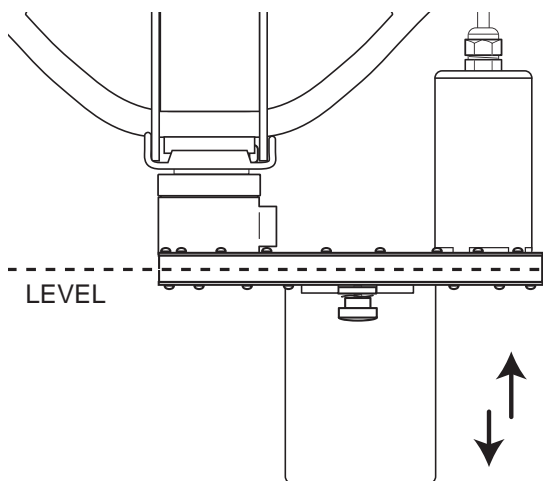

- 21** Move the bracket into position on the face of the freezer and ensure the Injector Assembly is level. On the freezer panel, mark around the bottom and sides of the bracket using a pencil.

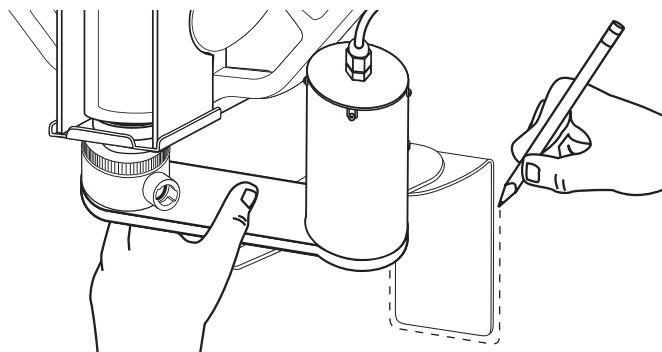

NOTE: BE SURE THE SURFACE OF THE FREEZER WHERE THE BRACKET BASE WILL BE ATTACHED IS THOROUGHLY CLEAN AND DRY.

- 22** Disconnect the Injector Assembly from the Adapter. Remove the protective backing from the adhesive strip on the bracket base. Press firmly against the freezer.

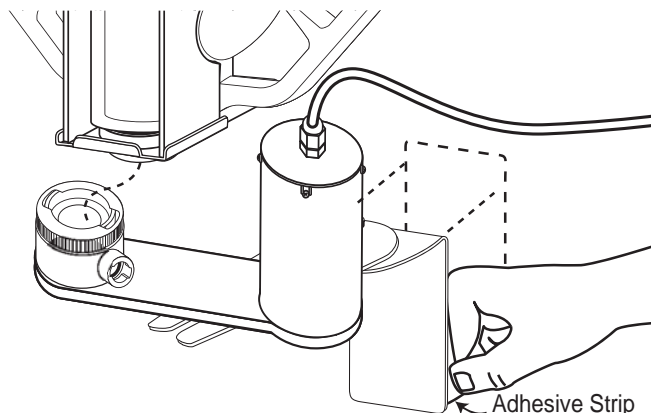

- 23** Reattach the Injector Head to the Adapter to complete the assembly and installation of the Mounting Bracket.

