

# Flavor Burst™

## ADPT EF-CS-80 Electrofreeze® CS Adapter Kit

### Assembly and Installation

This Adapter Kit is designed for use with most Compact-Series Electrofreeze® models. If you have a large Electrofreeze® door spout or other special considerations, please contact your local Flavor Burst™ distributor for additional information.

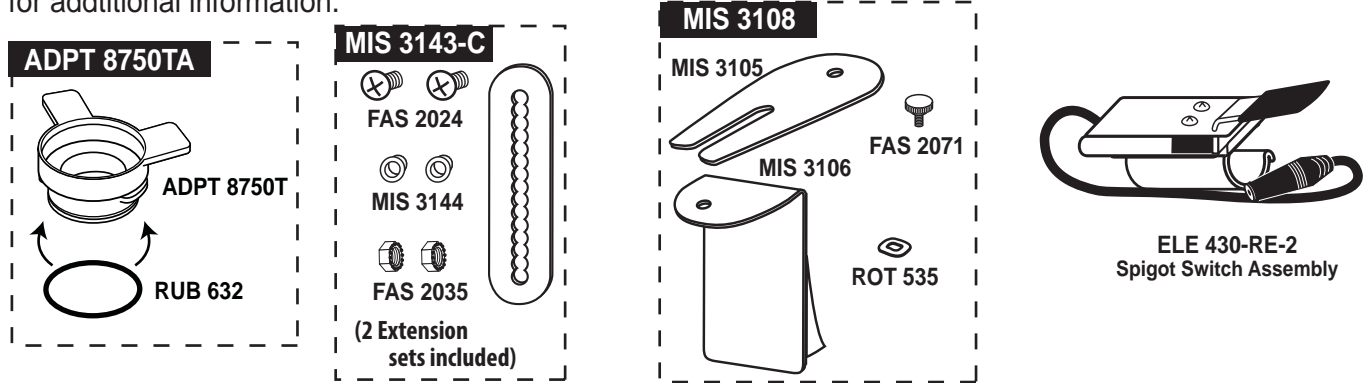

- 1 Rotate the Switch Assembly onto the draw-handle bar.
- 2 Position the Switch up towards the end of the draw-handle bar.

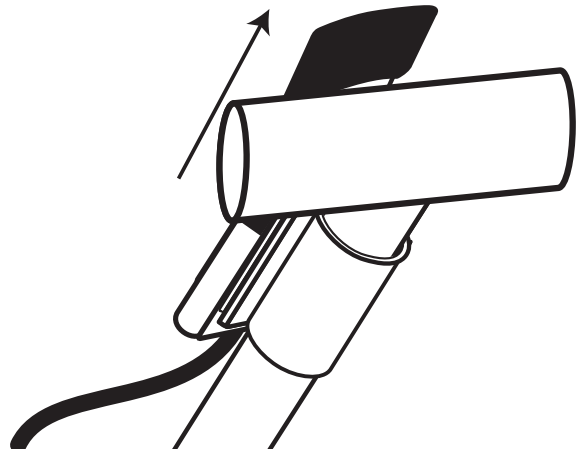
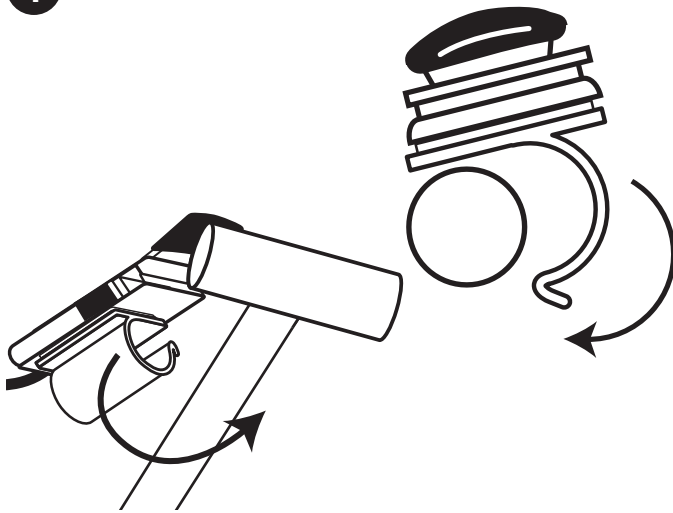

- 3 Be sure to fully engage the Spigot Switch jack to the Flavor Burst™ keypad jack for normal operation.
- 4 Install the black o-rings on the Adapter in their proper positions and then attach the adapter assembly to the freezer door spout.

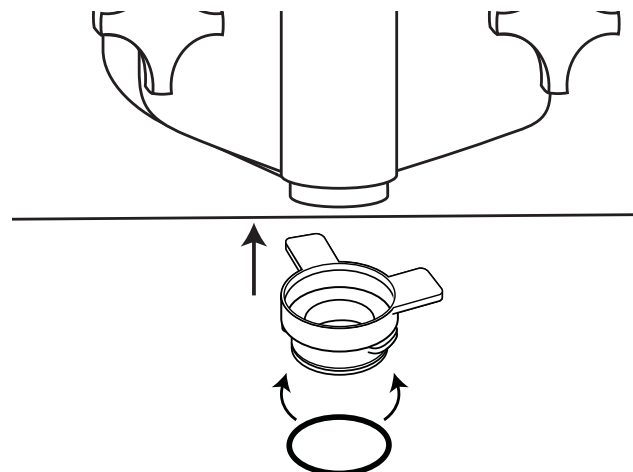
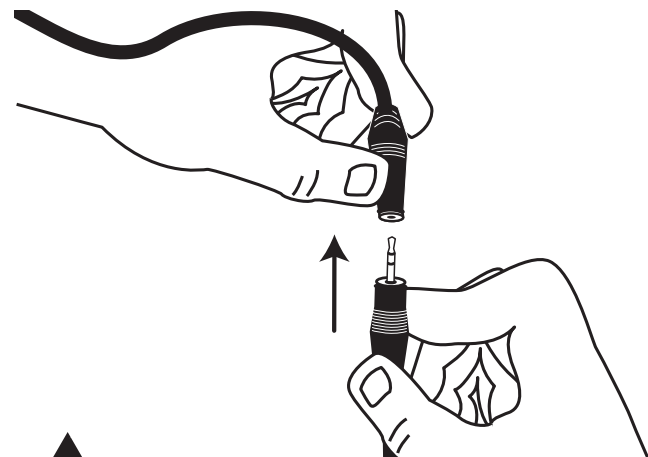

**NOTE:** DO NOT NEGLECT TO CHECK THIS CONNECTION DURING DAILY STARTUP.