

# Flavor Burst®

## ADPT TY80S-FCB1CTP

### FCB Auto Draw Valve Upgrade Kit for CTP and JBT systems

This kit converts the Flavor Burst® CTP 80FCB or JBT 80FCB-3B draw-handle operated system to a Flavor Burst® auto draw valve FCB system. When attached to an FCB freezer, this system allows for push-button dispensing without the use of a draw handle. The following instructions are for a field conversion of the freezer. For more information, please contact your local Flavor Burst® distributor.

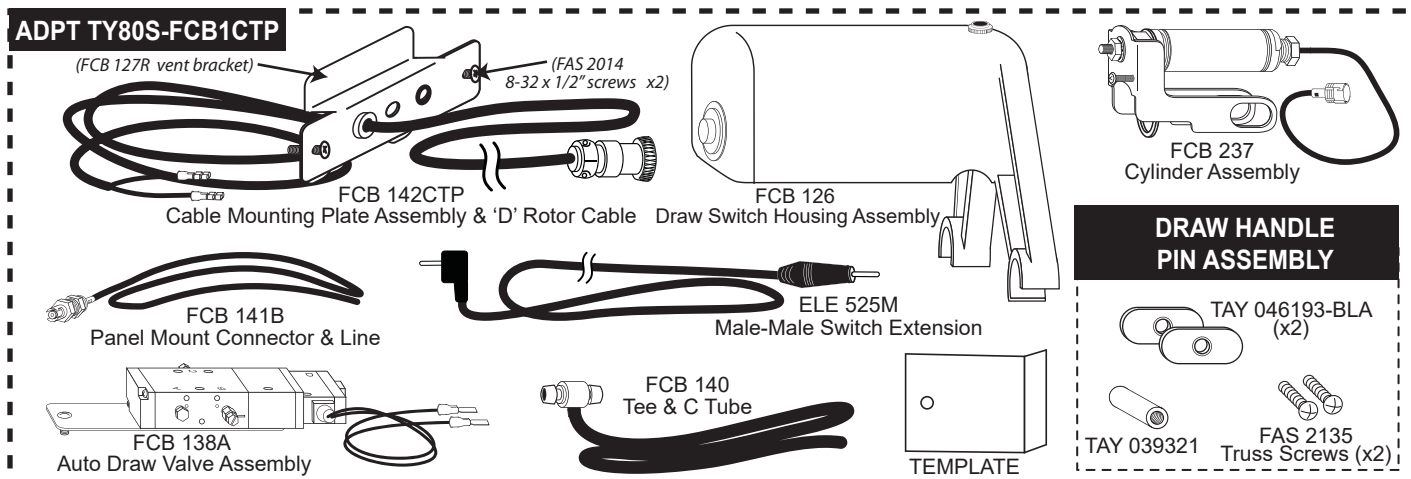

- 1 Remove the Color Touch Panel and Mounting Bracket from the freezer. Also, remove the 9-Tube Assembly and the Tube / Cable Casing and set them aside. If you have a Jumbo Touch Panel, it can remain installed.

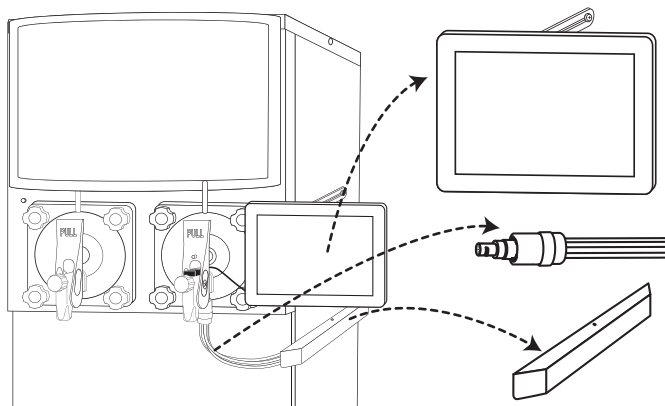

- 2 Remove the cap, spring, and Flow Rate Controller Assembly from the modified door spout. Set aside the cap and spring.

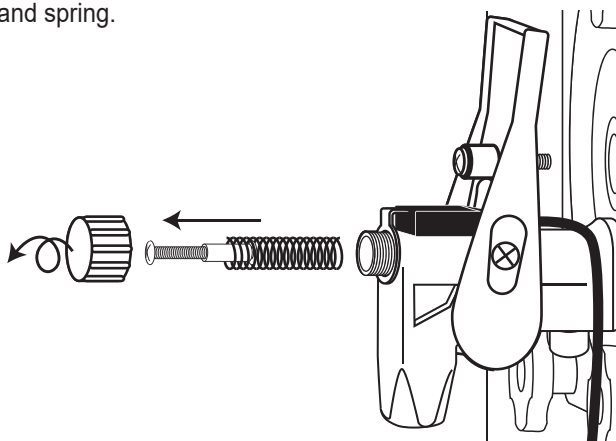

- 3 Remove the draw handle and the draw handle pin assembly from the modified door spout that came with the Flavor Burst FCB system.

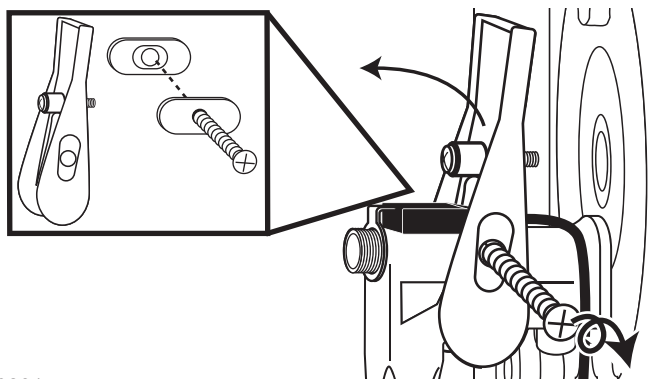

- 4 Disconnect and remove the spigot switch assembly. Ensure the two o-rings are in their respective grooves inside the syrup port.

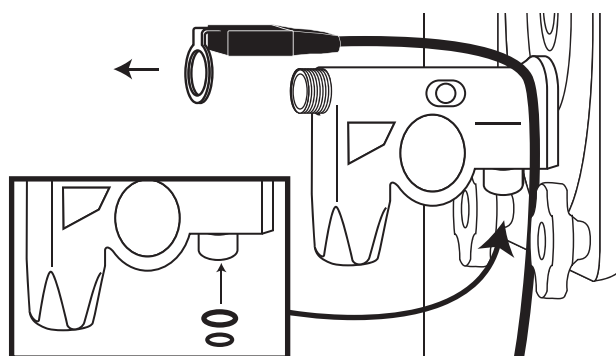

- 5** Install the Cylinder Assembly on the door spout by sliding the bracket over the threaded portion of the door spout.

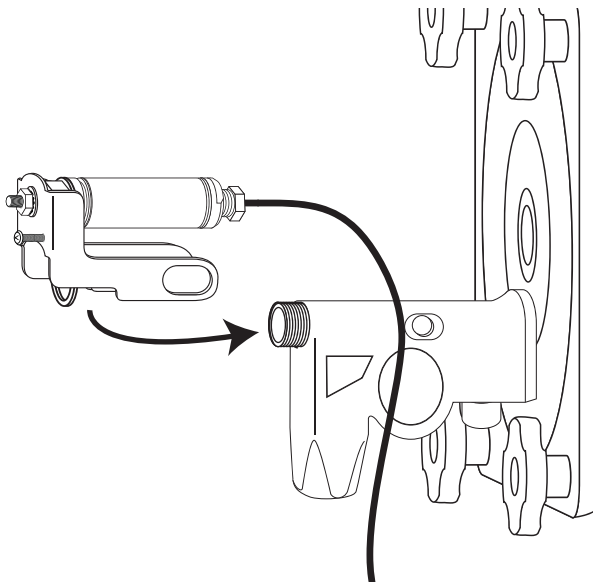

- 6** Install the draw handle pin assembly from the kit onto the Cylinder Assembly and tighten screw to secure.

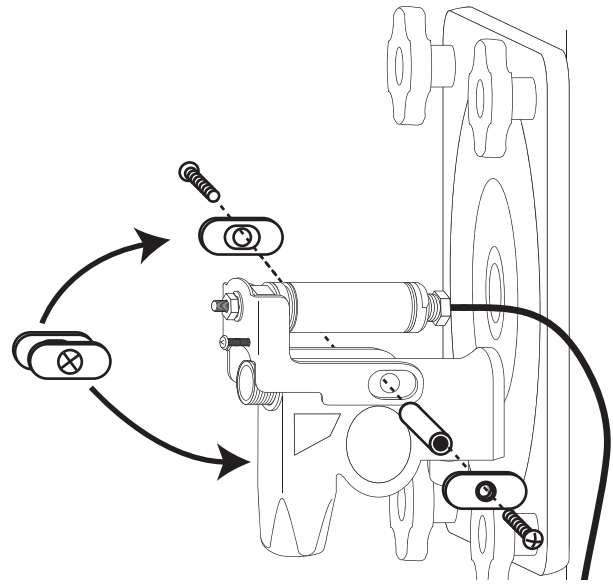

- 7** Insert the spring into the draw spout opening and install the cap onto the assembly.

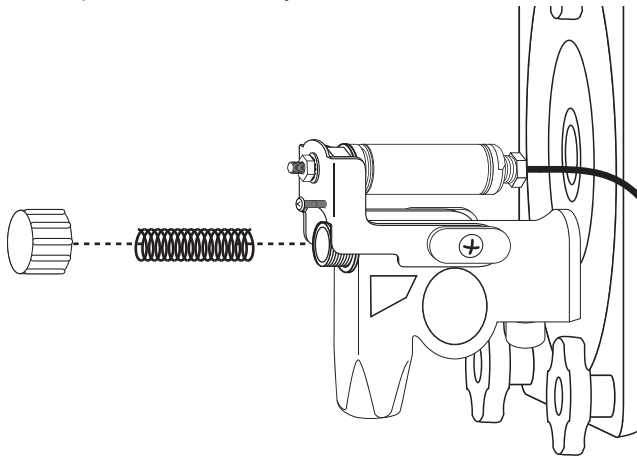

- 8** Place the drilling template on the front service panel under the draw spout so that the folded edge is placed along the service panel edge. Tape the template in place or mark the hole to be drilled in front service panel.

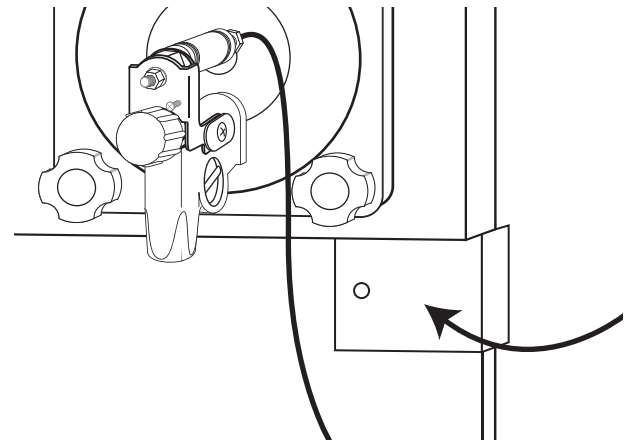

- 9** Remove the panel and drill the 7/16" hole where marked. Deburr the hole if necessary.

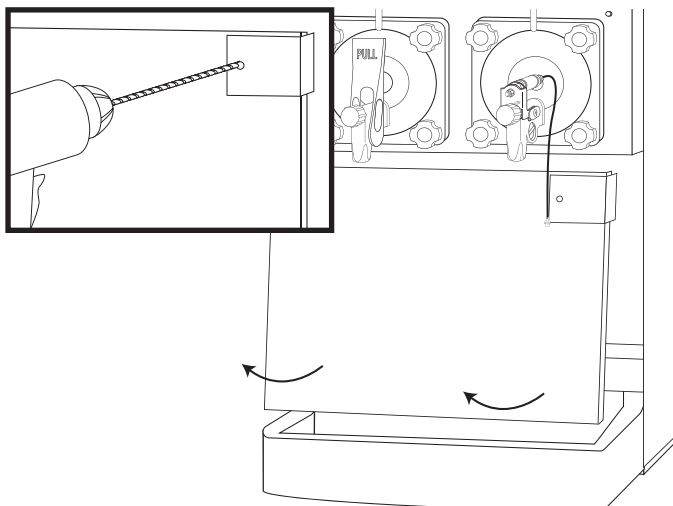

- 10** Install the panel mount connector on the panel, inserting the connector line through the hole. Secure the connector from the inside of the panel with the nut provided.

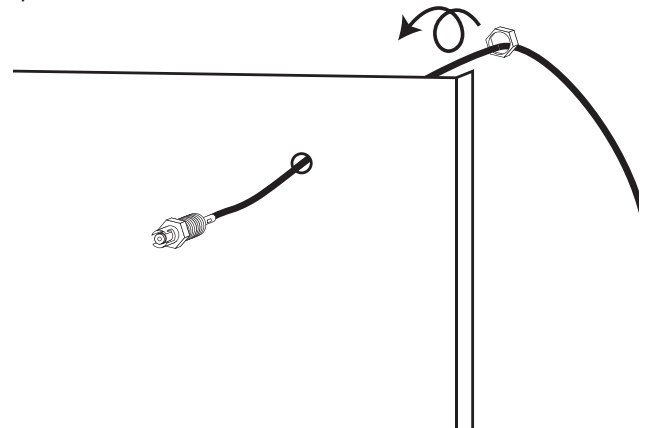

- 11** Reinstall the front service panel with the connector securely in place and tubing to the inside. Ensure the cable falls against the panel and under the support bar so that it does not interfere with any internal freezer parts.

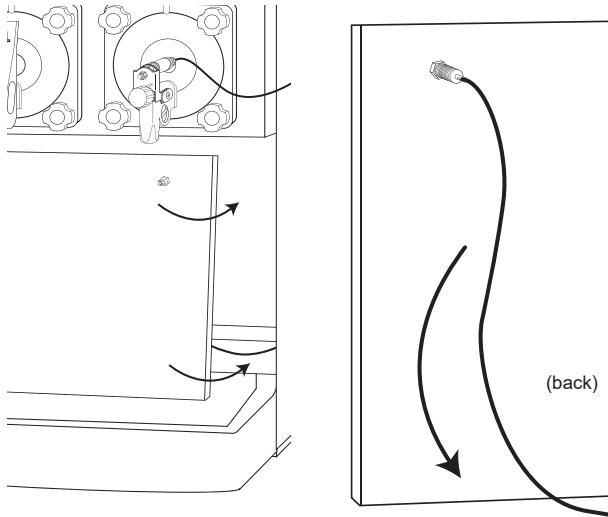

- 12** Remove the side service panel nearest the connection.

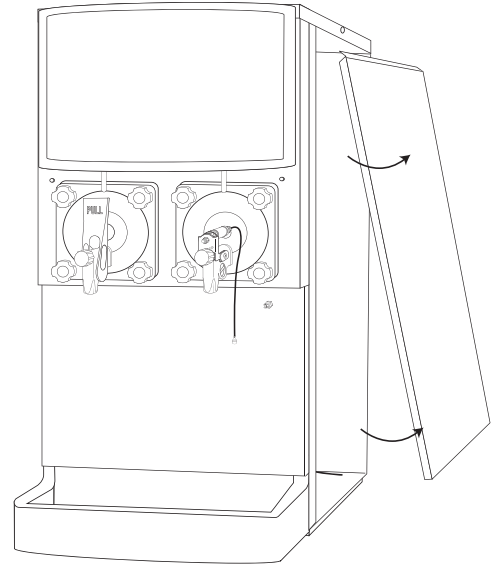

- 13** Install the Valve Assembly inside the freezer cabinet using the screw provided. Mount the base housing to the existing bracket as shown.

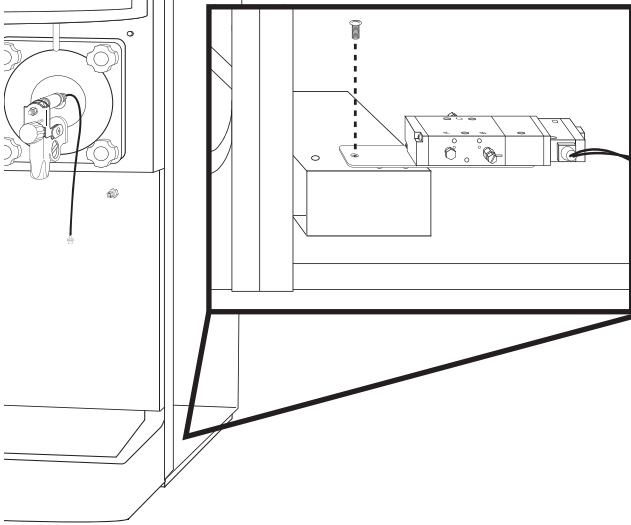

- 14** Connect the air tube to the B port on the valve. Use the tubing sleeves to secure the tube on the barb connection.

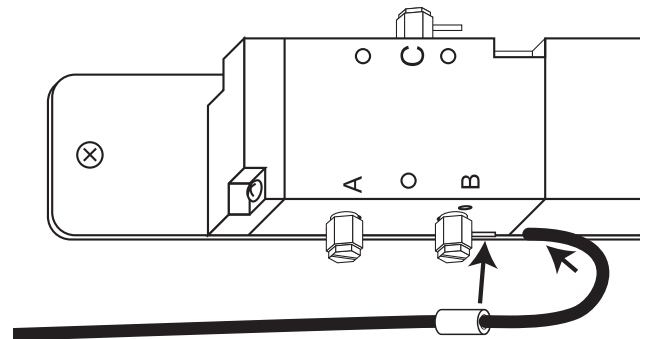

- 15** Install the cable mounting plate assembly on the same side as the Auto Draw Valve Assembly. Slide the spade connector ends of the cables through the 2nd slot from the bottom of the freezer's back vent cover.

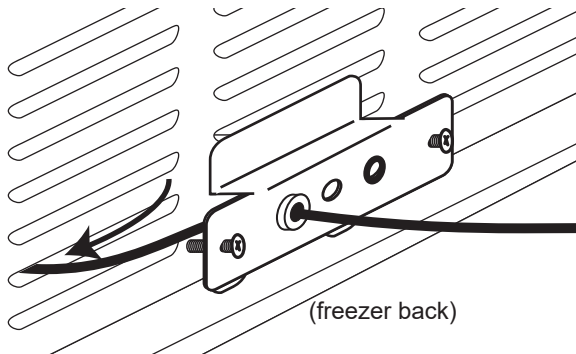

- 16** Angle the upper bracket lip up through the 3rd vent slot from the bottom, so that the lower bracket lip can slide into the bottom vent slot. Slide the bracket down as far as it will go.

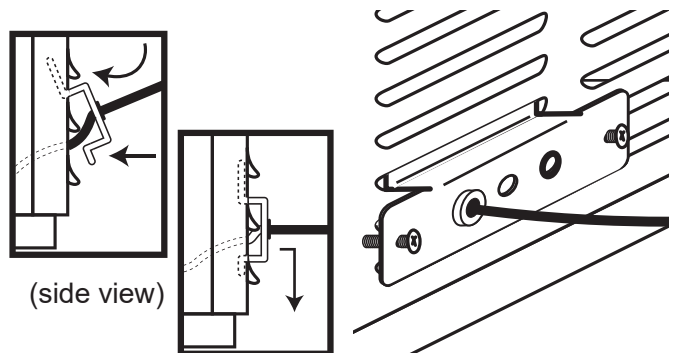

- 17** Slide the bracket down and turn the side screws to brace the assembly against the freezer.

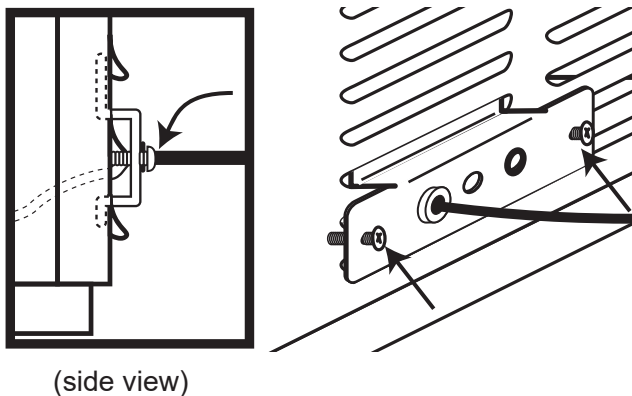

- 18** Connect the female spade connectors of the Rotor Cable D to the male connectors on the D Valve.

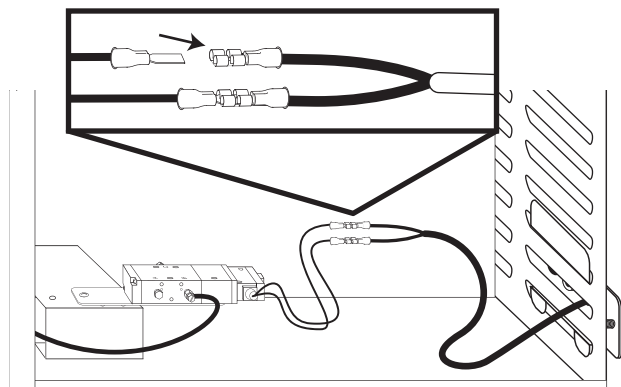

- 19** Insert the C tube through the hole with the black ring on the Cable Mounting Plate Assembly. Connect the tube to the C Valve inside of the freezer.

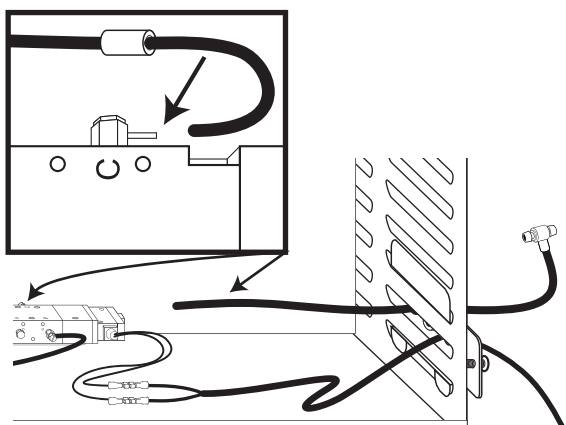

- 20** Ensure the CO2 tank is closed and then cut the supply line about 3" from the rear of the freezer. Install the Tee with the C tube in the CO2 supply line. Use clamps to seal the connections.

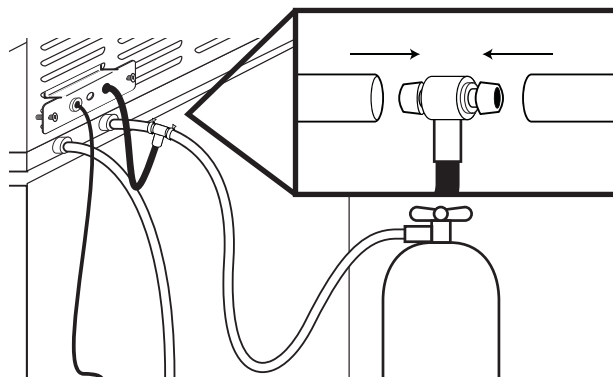

- 21** Open the valve on the CO2 tank and check for any leaks in the connections.

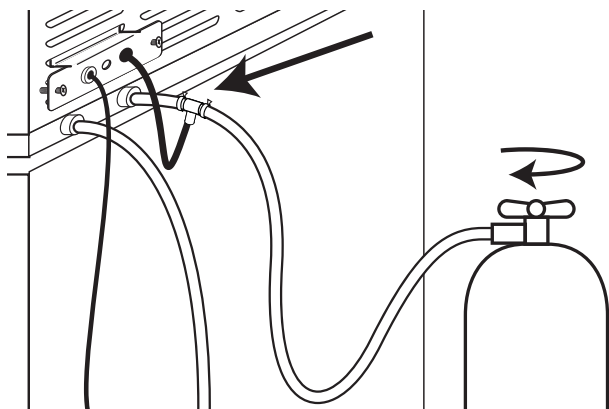

- 22** Return the side panel to the freezer.

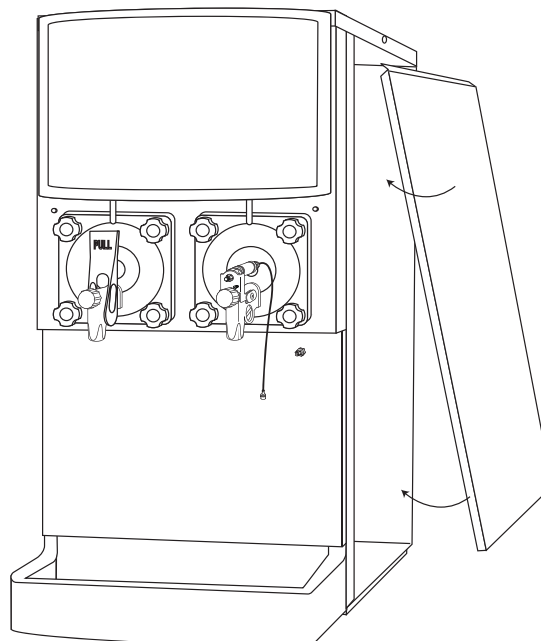

- 23** Power down the system by turning the switch on the back of the cabinet to the "off" position, with the "o" end pressed in. You may also remove the power cable from the back of the cabinet so that you can get to the cabinet openings more easily.

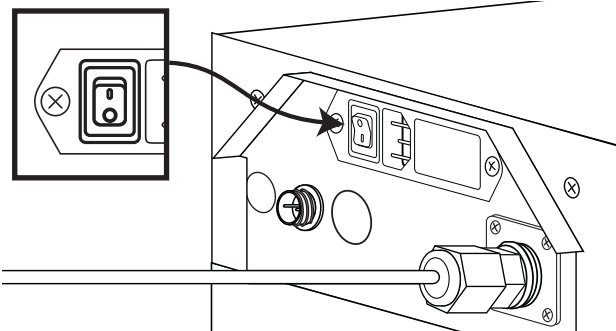

- 24** Connect the external rotor cable to the internal rotor cable port on the cabinet panel.

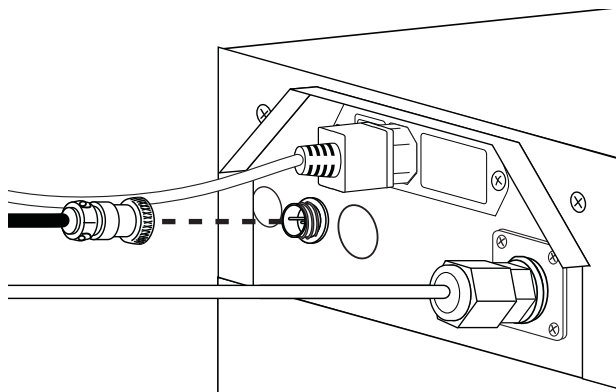

- 25** Connect the power cord to the port on the cabinet and activate the unit by pressing the "I" end of the switch.

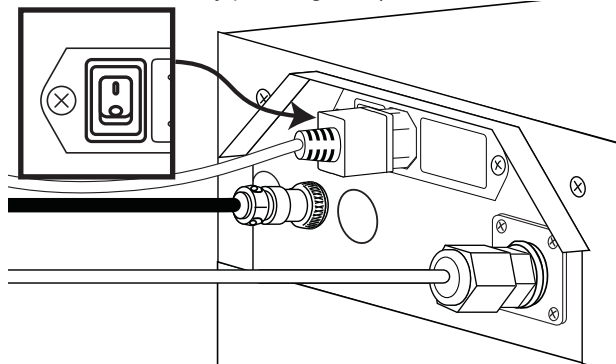

- 26** Loosen the two bottom hand knobs slightly on the door. Install the Draw Switch Housing over the Cylinder Assembly on the draw spout. Tighten the hand knobs to secure.

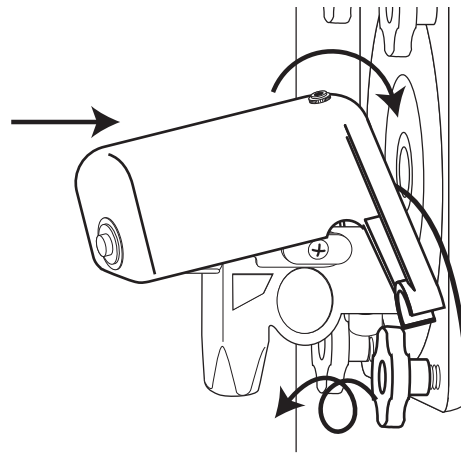

- 27** Insert the 9-Tube Assembly into the syrup port on the modified draw spout. Rotate the 9-Tube Assembly until motion stops to secure.

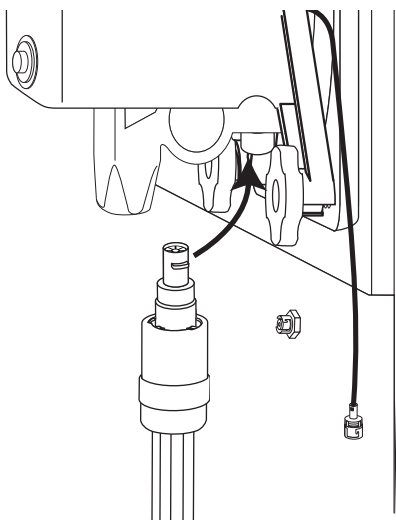

- 28** Connect the Cylinder Assembly line to the panel mount connector. Connect the right angle end of switch extension to the Color Touch Panel or Jumbo Touch Panel, and the straight end into the stereo jack on the top of the housing assembly.

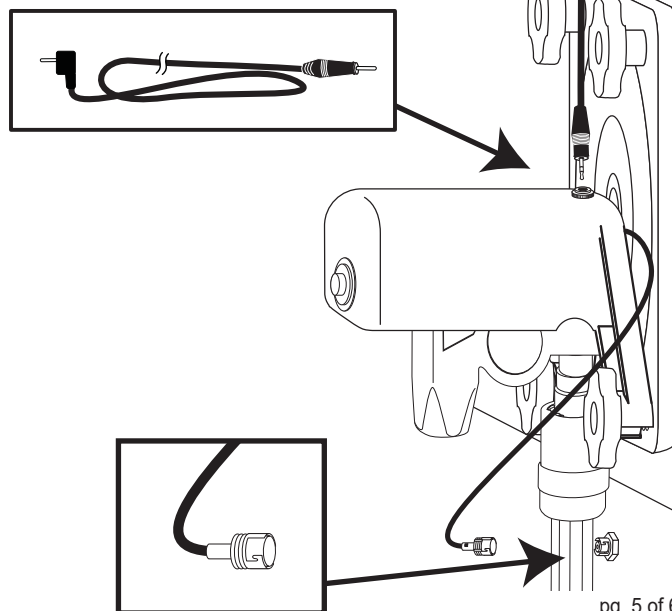

- 29** Reinstall the Color Touch Panel with Mounting Bracket and the Tube / Cable Casing. Fill the freezer hopper with FCB product so that it can freeze down during the rest of the Flavor Burst setup.

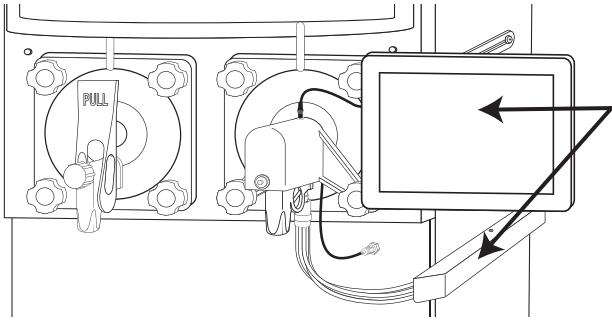

- 30** Go through the Color Touch Panel or Jumbo Touch Panel Operations Manual to set up your system according to your preferences and needs. Ensure the Auto Draw feature is enabled according to the following steps.

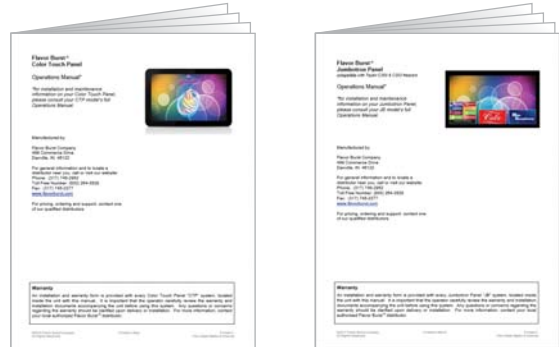

- 31 Color Touch Panel Systems:**  
Go to the Maintenance Menu, section "Enable or Disable Serving Options". Turn ON the "Enable FCB Auto Dispense Mode" feature.

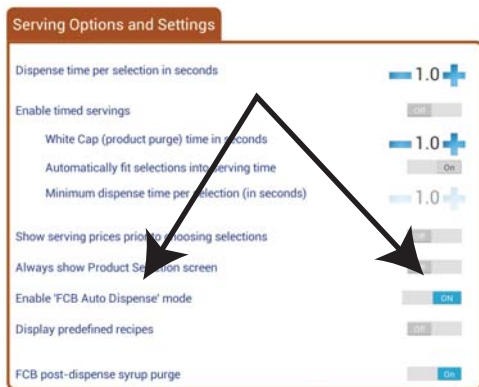

- 32 Jumbo Touch Panel Systems:**  
Go to the Maintenance Menu, section "Equipment Setup Wizard". Go through the setup program and select "Auto Draw" when prompted.

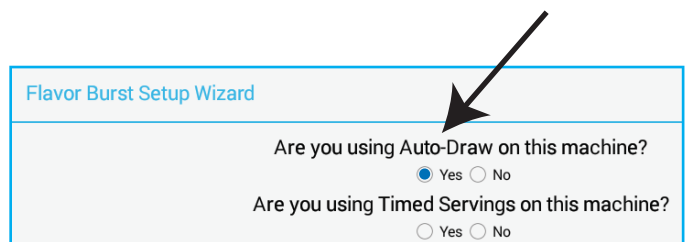

- 33** When the FCB product has frozen down, place a container under the spout. Draw a serving by selecting one or more flavors from the screen. Press and hold the dispense button shown on the screen or the housing's red button above the spout. When the cup is nearly full, release the button. Test out all 8 flavors to ensure everything is working properly.

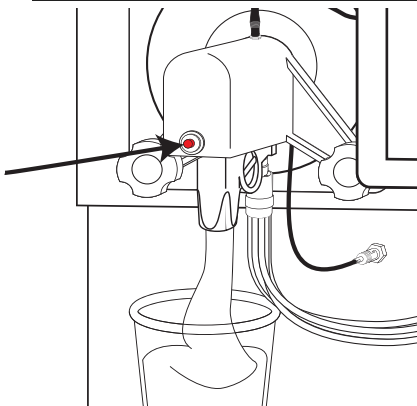

- 34** To adjust the product flow rate, remove the Housing from the Cylinder Assembly. Tighten the flow rate screw (clockwise) to decrease the product flow and increase flavor output. Loosen the screw (counter-clockwise) to increase the product flow and decrease flavor output. Return the Housing to the assembly.

